

# A1140\_Tract\_2\_Soils Map

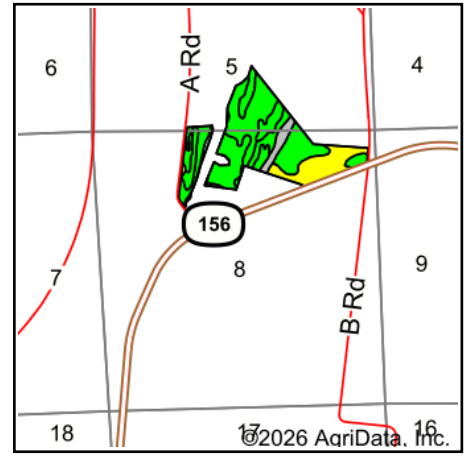

State: **Illinois**  
 County: **Monroe**  
 Location: **8-3S-11W**  
 Township: **Precinct 15**  
 Acres: **89.38**  
 Date: **3/4/2026**

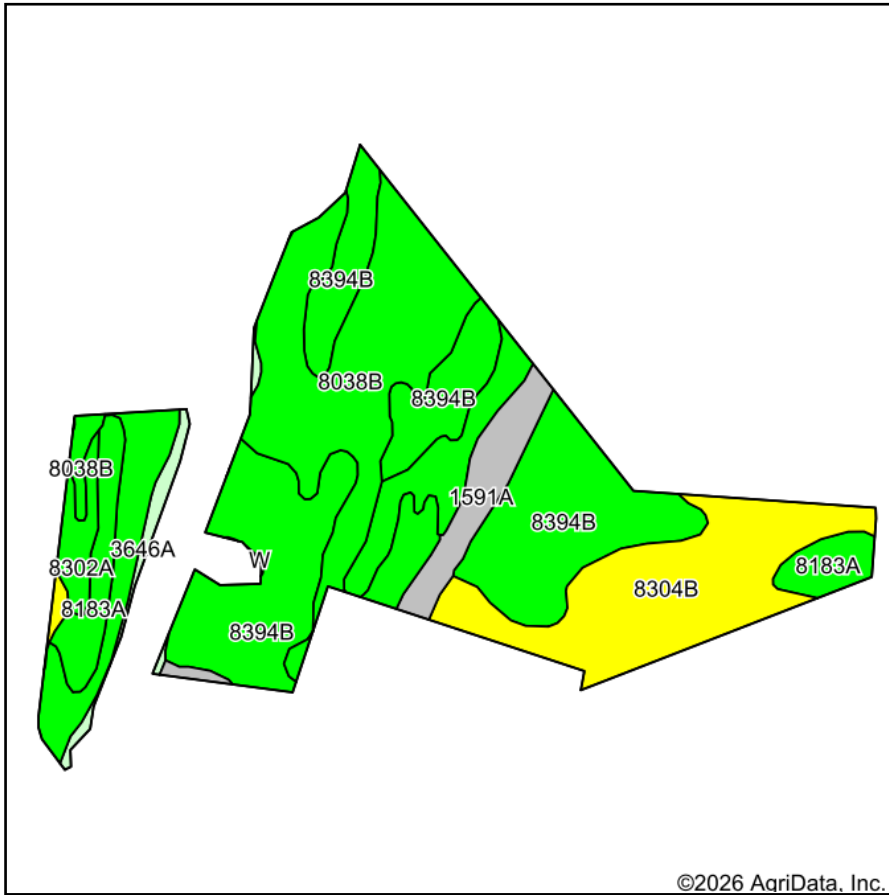

Soils data provided by USDA and NRCS.

Area Symbol: IL133, Soil Area Version: 18												
Code	Soil Description	Acres	Percent of field	Il. State Productivity Index Legend	Subsoil rooting <b>a</b>	Corn Bu/A	Soybeans Bu/A	Wheat Bu/A	Oats Bu/A <b>b</b>	Sorghum <b>c</b> Bu/A	Grass-leg ume <b>e</b> hay, T/A	Crop productivity index for optimum management
**8394B	Haynie silt loam, 2 to 5 percent slopes, occasionally flooded	29.99	33.6%		FAV	**160	**51	**59	**78	0	**4.00	**116
**8038B	Rocher loam, 2 to 5 percent slopes, occasionally flooded	21.20	23.7%		FAV	**149	**47	**57	**76	0	**4.00	**108
**8304B	Landes very fine sandy loam, 2 to 5 percent slopes, occasionally flooded	15.65	17.5%		FAV	**136	**45	**55	**62	0	**3.00	**101
**8302A	Ambraw silty clay loam, 0 to 2 percent slopes, occasionally flooded	11.30	12.6%		FAV	**155	**50	**62	**76	0	**5.00	**115
**8183A	Shaffton clay loam, 0 to 2 percent slopes, occasionally flooded	5.24	5.9%		FAV	**153	**50	**59	**79	0	**5.00	**115

Soils data provided by USDA and NRCS. Soils data provided by University of Illinois at Champaign-Urbana.



Code	Soil Description	Acres	Percent of field	Il. State Productivity Index Legend	Subsoil rooting <b>a</b>	Corn Bu/A	Soybeans Bu/A	Wheat Bu/A	Oats Bu/A <b>b</b>	Sorghum <b>c</b> Bu/A	Grass-legume <b>e</b> hay, T/A	Crop productivity index for optimum management
**1591A	Fults silty clay, undrained, 0 to 2 percent slopes, occasionally flooded	4.49	5.0%		FAV	**77	**25	**29	0	**59	**2.00	**57
3646A	Fluvaquents, loamy, 0 to 2 percent slopes, frequently flooded	1.51	1.7%									
<b>Weighted Average</b>						<b>145.3</b>	<b>46.6</b>	<b>55.7</b>	<b>69.3</b>	<b>3</b>	<b>3.8</b>	<b>106.4</b>

**Table: Optimum Crop Productivity Ratings for Illinois Soil EFOTG are sourced from Bulletin 811 calculated Map Unit Base Yield Indices, and adjusted (Adj) for slope, erosion, flooding, and surface texture.** Publication Date: 02-08-2023

Crop yields and productivity (B811 EFOTG) are maintained at the following USDA web site: 2023 Illinois Soil Productivity and Yield Indices: <https://efotg.sc.egov.usda.gov/#/state/IL/documents/section=2&folder=52809>

\*\* Base indexes from Bulletin 811 adjusted for slope, erosion, flooding, and surface texture according to the Il. Soils EFOTG

**b** Soils in the southern region were not rated for oats and are shown with a zero "0".

**c** Soils in the northern region or in both regions were not rated for grain sorghum and are shown with a zero "0".

**e** Soils in the well drained group were not rated for grass-legume and are shown with a zero "0".