

KEY PLAN
 NOT TO SCALE

Developer:
PEDCOR
 City Center
 DEVELOPMENT COMPANY

Project:

AROMA INDIAN CUISINE
 Carmel City Center
 Hamilton Building
 885 MONON GREEN BLVD., SUITE 108
 CARMEL, INDIANA 46032

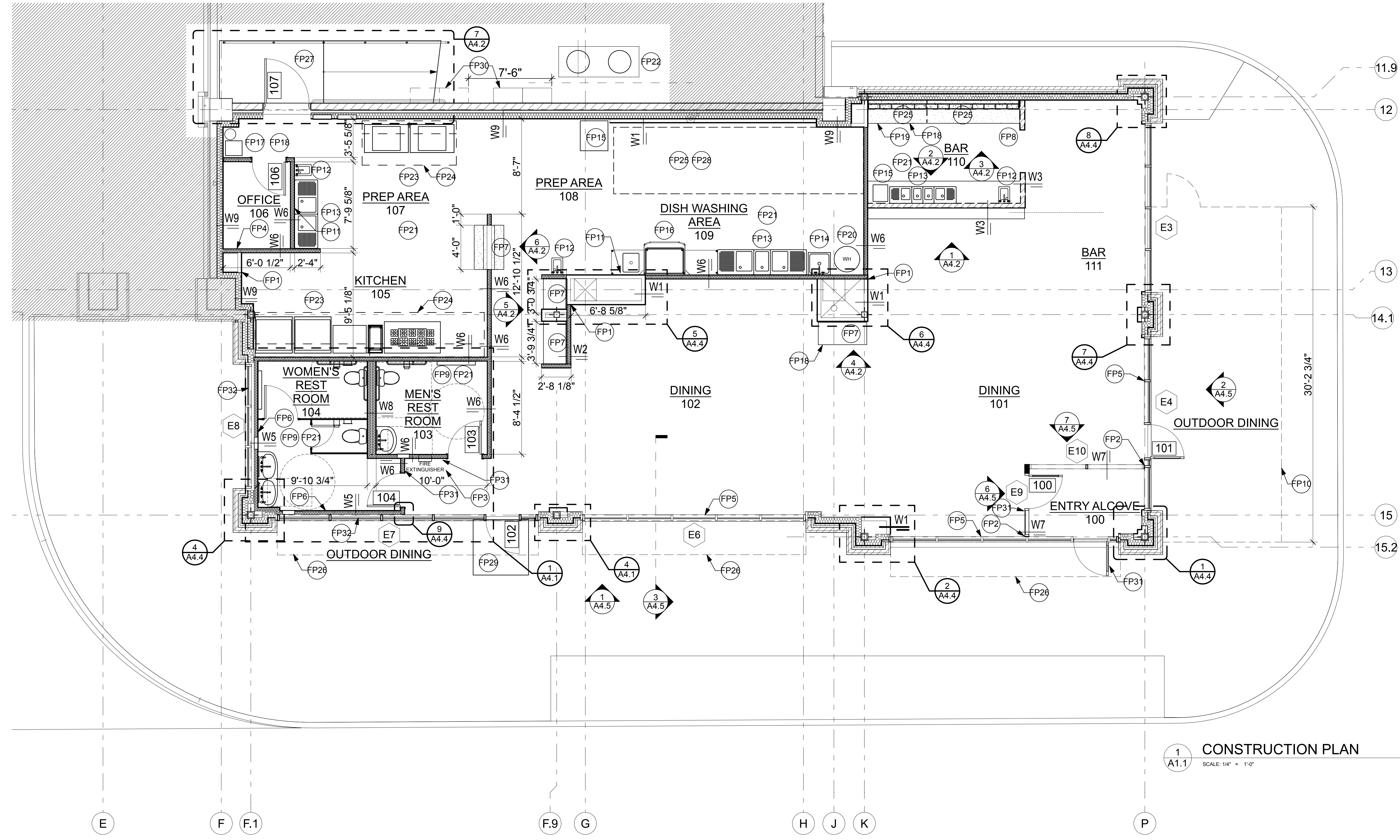

1 CONSTRUCTION PLAN
 SCALE: 1/4" = 1'-0"

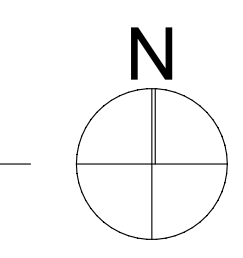

GENERAL CONSTRUCTION NOTES:

- DIMENSIONS ARE FROM FACE OF FINISHED WALL UNLESS NOTED OR SHOWN OTHERWISE. ANY DIMENSION NOT SHOWN OR DEEMED QUESTIONABLE IS TO BE VERIFIED BY ARCHITECT. DO NOT SCALE DRAWINGS.
- SEE CONSTRUCTION PLAN LEGEND FOR WALL CONSTRUCTION AND WALL TYPES. ALL WALLS ARE TO BE WB UNLESS NOTED OTHERWISE.
- ALL WALLS SHALL BE CHALKED OFF FOR ARCHITECT'S REVIEW OF NEW WALL CONSTRUCTION.
- PROVIDE CONCEALED FIRE RATED WOOD BLOCKING SUPPORTS AS REQUIRED FOR ALL SURFACE MOUNTED ITEMS.
- NEW DOOR AND FRAME NUMBERS CORRESPOND TO ROOM NUMBERS. WHERE MORE THAN ONE DOOR OCCURS IN A ROOM, A SUFFIX HAS BEEN ADDED (ie. 100A).
- ALL NEW DOORS TO BE INSTALLED WITH HINGE 6" AWAY FROM WALL UNLESS NOTED OTHERWISE.
- ALL NEW DOORS SHALL ALLOW 12" CLEAR ON PUSH SIDE AND 18" CLEAR ON PULL SIDE OF DOOR, UNLESS NOTED OTHERWISE, TO MEET CURRENT ADA CODE REGULATIONS.
- ALL NEW FIRE EXTINGUISHER CABINETS TO BE FINISHED TO MATCH ADJACENT WALL FINISH AND INSTALLED ACCORDING TO CODE. LIFESAFETY CONTRACTOR TO VERIFY PLACEMENT AND COUNT OF FIRE EXTINGUISHERS THROUGHOUT THE SPACE. IF ADDITIONAL FIRE EXTINGUISHER LOCATIONS ARE NEEDED, A PLAN MUST BE SUBMITTED TO THE ARCHITECT FOR REVIEW FOR AESTHETIC PURPOSES ONLY.
- APPLY PLUMBING FIXTURES, AT JUNCTURE WITH WALL, AND AT ALL COUNTERTOPS AND BACKSPLASH JUNCTURES.
- FLOOR SHALL BE CLEANED, SMOOTH AND LEVEL FOR INSTALLATION OF NEW FLOOR FINISHES AS SCHEDULED.
- ALL WALLS SCHEDULED TO REMAIN (I.E. CORE WALLS, AND DEMISING WALLS) SHALL BE PATCHED, REPAIRED, AND SANDED SMOOTH IN PREPARATION FOR NEW FINISHES.
- USE MOISTURE-MOLD RESISTANT GYPSUM WALLBOARD MEETING ASTM D3273 ON ALL WALL SURFACES RECEIVING FRP PANELS AND IN RESTROOMS.
- CEMENT BOARD IS TO BE USED IN ALL SECTIONS AND PORTIONS OF WALLS WITH TILE FINISH. SEE FINISH PLANS TO COORDINATE FINISH LOCATIONS.
- SEE SHEET A4.1 FOR DOOR SCHEDULE.
- ALL PENETRATIONS IN RATED WALL PARTITIONS AND FLOOR SYSTEMS SHALL BE FIRE RATED ASSEMBLIES. SUBMIT PRODUCT DATA AND ASSEMBLY DRAWINGS WITH TEST FILE NUMBERS FOR REVIEW.
- INSULATION FOR INTERIOR WALL APPLICATIONS SHALL BE FORMALDEHYDE-FREE, UNFACED, GLASS-FIBER BLANKET INSULATION IN BATT FORM CONFORMING TO ASTM C 885, TYPE I, WITH THICKNESS TO BE EQUAL OR GREATER THAN THE STUD THICKNESS OF THE WALL INTO WHICH IT IS INSTALLED.
- REPAIR AND PATCH ALL FIRE PROOFING ON THE BUILDING SHELL THAT WAS REMOVED DURING CONSTRUCTION. REMOVE FIREPROOFING SPRAY FROM THE DECK AND OTHER ITEMS THAT DO NOT REQUIRE FIRE PROOFING.

CONSTRUCTION PLAN NOTES:

- FP1 ALIGN FINISHED FACES.
- FP2 CENTER NEW STOREFRONT WALL ON EXISTING STOREFRONT MULLIONS AS PER BUILDING STANDARD DETAILS. USE 3/8" COMPRESSIBLE GASKET OR BACKER ROD /SEALANT AT MULLIONS FOR SOUND INSULATION. VERIFY DIMENSION FROM MULLION TO MULLION AND REPORT ANY DISCREPANCIES TO DESIGNER BEFORE PROCEEDING WITH CONSTRUCTION.
- FP3 NEW SEMI RECESSED FIRE EXTINGUISHER CABINET TO BE INSTALLED IN WALL AT THESE LOCATIONS WITH TOP OF CABINET AT 54" AFF. PAINT TO MATCH ADJACENT WALL SURFACE. CONFIRM QUANTITY OF EXTINGUISHERS WITH FIRE DEPARTMENT. IF EXTINGUISHERS NEED TO BE ADDED VERIFY LOCATIONS WITH THE ARCHITECT.
- FP4 PROVIDE 3/4"x4"x8" FIRE RETARDANT PLYWOOD PHONE BOARD, PHONE BOARD TO BE PAINTED WITH FIRE RETARDANT PAINT, COLOR OF PAINT TO MATCH ADJACENT WALL FINISH.
- FP5 PROVIDE ONE LAYER OF DRYWALL AT EXISTING STOREFRONT LOCATIONS.
- FP6 PROVIDE BLACK-OUT PRIVACY WINDOW FILM ON THE INTERIOR OF THE GLASS STOREFRONT PRIOR TO ADDING FURRED WALL.
- FP7 PROVIDE PLASTIC LAMINATE CABINET AND COUNTER. SEE ELEVATION FOR DETAILS.
- FP8 PROVIDE BUILT-IN BAR WITH FRONT AND BACK CABINETS AND COUNTERS. SEE ELEVATIONS FOR DETAILS.
- FP9 PROVIDE REST ROOMS WITH ADA TOILETS AND SINKS. INCLUDE PARTITIONS, GRAB BARS, TOILET TISSUE HOLDERS, SOAP DISPENSERS, AND PAPER TOWEL DISPENSERS. SEE ACCESSORY SCHEDULE AND ENLARGED PLAN FOR DETAILS.
- FP10 PROVIDE SMART PERGOLA STRUCTURE. CONTACT XXX FOR PRICING AND TO COORDINATE INSTALLATION.
- FP11 PROVIDE BLOCKING FOR WALL SHELVES. SEE EQUIPMENT SCHEDULE FOR SHELVING LOCATIONS.
- FP12 INSTALL WALL HUNG HANDSINK WITH ADA FAUCET. SEE EQUIPMENT PLAN FOR SPECIFICATION. WRAP PIPES UNDER SINK AND PROVIDE BLOCKING AS REQUIRED. COORDINATE WITH MEP CONSULTANTS.
- FP13 INSTALL FREE STANDING SINKS). SEE EQUIPMENT PLAN FOR SPECIFICATION. PROVIDE WATER SUPPLY, DRAIN, AND WALL BLOCKING FOR FAUCET AS REQUIRED. COORDINATE WITH MEP CONSULTANTS.
- FP14 INSTALL MOP SINK W/ FAUCET AND GREASE TRAP SEE EQUIPMENT PLAN FOR SPECIFICATIONS. PROVIDE WALL BLOCKING FOR FAUCET & HOOKS @4'-0" AFF ON (2) WALLS AS REQUIRED. COORDINATE WITH MEP CONSULTANTS.
- FP15 INSTALL ICE MAKERS. SEE EQUIPMENT PLAN FOR SPECIFICATIONS. PROVIDE WATER SUPPLY, DRAIN, AND ELECTRICAL SERVICE AS REQUIRED. COORDINATE WITH MEP CONSULTANTS.
- FP16 INSTALL DISHWASHER. SEE EQUIPMENT PLAN FOR SPECIFICATION. PROVIDE WATER SUPPLY, DRAIN, AND ELECTRICAL SERVICE AS REQUIRED. COORDINATE WITH MEP CONSULTANT.

WALL LEGEND:

- NOTES:
- EXISTING PARTITION TO REMAIN
 - NEW WALL PARTITION
 - NEW LOW WALL PARTITION
- W1 3-5/8" 20 GAUGE METAL STUDS @16" O.C. WITH 5/8" GYPSUM WALL BOARD ONE SIDE. WALLS TO EXTEND TO STRUCTURAL DECK ABOVE.
 - W2 3-5/8" 20 GAUGE METAL STUDS @16" O.C. WITH 5/8" GYPSUM WALL BOARD EACH SIDE W/ INSULATION. WALLS TO EXTEND TO STRUCTURAL DECK ABOVE.
 - W3 3-5/8" 25 GAUGE METAL STUDS @16" O.C. WITH 5/8" GYPSUM WALL BOARD EACH SIDE. WALLS TO EXTEND TO 40 1/2" AFF @ COUNTER.
 - W4 3-5/8" 20 GAUGE METAL STUDS @16" O.C. WITH 5/8" GYPSUM WALL BOARD EACH SIDE. WALLS TO EXTEND TO 47-3/4" AFF. INCLUDE BLOCKING, 3/4"x8" WOOD CAP AND KNEE BRACING.
 - W5 3-5/8" 20 GAUGE METAL STUDS @16" O.C. WITH 5/8" GYPSUM WALL BOARD ONE SIDE. WALLS TO EXTEND TO STRUCTURAL DECK ABOVE. PROVIDE INSULATION AT WALLS THAT BLOCK STOREFRONT WINDOWS.
 - W6 3-5/8" 20 GAUGE METAL STUDS @16" O.C. WITH 5/8" MOISTURE-MOLD RESISTANT GYPSUM WALL BOARD ON (1) SIDE, STANDARD GYPSUM WALL BOARD ON THE OTHER. PROVIDE 3-5/8" SOUND INSULATION INSIDE WALL. WALLS TO EXTEND TO STRUCTURAL DECK ABOVE.
 - W7 STOREFRONT TO MATCH EXISTING EXTERIOR TUBELITE 24850 THERMALLY BROKEN STOREFRONT SYSTEM.
 - W8 6" 20 GAUGE METAL STUDS @16" O.C. WITH 5/8" MOISTURE-MOLD RESISTANT GYPSUM WALL BOARD ON BOTH SIDES. PROVIDE 3-5/8" SOUND INSULATION INSIDE WALL. WALLS TO EXTEND TO STRUCTURAL DECK ABOVE.
 - W9 6" 20 GAUGE METAL STUDS @16" O.C. WITH 5/8" MOISTURE-MOLD RESISTANT GYPSUM WALL BOARD ON ONE SIDE. PROVIDE 3" THERMAL INSULATION INSIDE WALL. WALLS TO EXTEND TO STRUCTURAL DECK ABOVE.

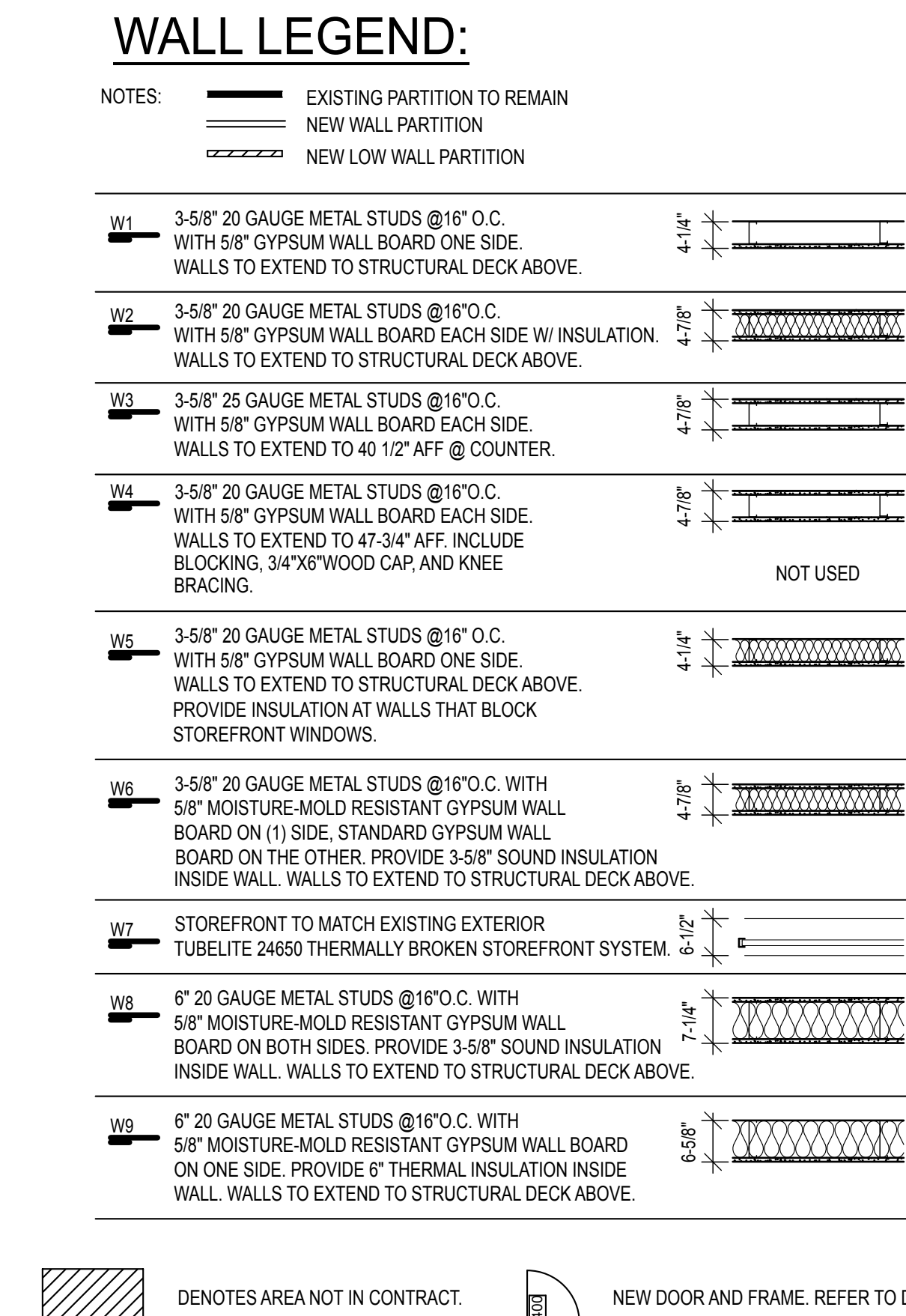

- DIAGONAL HATCHING DENOTES AREA NOT IN CONTRACT.
- NEW DOOR AND FRAME. REFER TO DOOR SCHEDULE.
- DOTTED HATCHING DENOTES NEW MILLWORK.
- EXISTING DOOR AND FRAME. SEE BUILDING SHELL PLAN.

COPYRIGHT & OWNERSHIP OF DOCUMENTS

CONSTRUCTION DOCUMENTS

Issue Date	Drawn By	Checked By
7/20/22	TJ	MC

Revisions:

Project Number:

Sheet Title:
CONSTRUCTION PLAN

Sheet Number:

A1.1

Modifiers: July 20, 2022, Blllmodr.ecad@pedcor.com - Blllmodr.ecad@pedcor.com - Hamilton, Indiana 46032