

FOR SALE - OPERABLE TUNNEL CARWASH

15190 S. Mahaffie St, Olathe, KS



- 6,848 SF Building on 1.30 Acres
- Fully Operational Tunnel Carwash
 - 100' ConveyORIZED Tunnel
- Four Self-Service Wash Bays
- On-site Vacuum Systems
- Building Outfitted with Modern Mechanical Systems
- All Carwash Equipment Included in the Sale
- Built in 2000
- 34,458 Vehicles Per Day on 151st Street at Mahaffie

For Sale - \$3,099,000

Ryan Holcomb

c: 816.526.2904 | o: 913.747.3321
e: rholcomb@fishmancommercial.com

Lynn Holcomb

c: 816.289.1526 | o: 913.747.3301
e: lholcomb@fishmancommercial.com

Elliott Basler

c: 913.909.6968 | o: 913.708.8146
e: elliott@fishmancommercial.com



AREA DEMOGRAPHICS	<i>3 mile</i>	<i>5 mile</i>	<i>10 mile</i>
Avg Household Income	\$123,957	\$142,323	\$148,316
2025 Population	71,018	152,068	420,851
Daytime Employees	74,297	140,257	453,323

Available Space Floorplan

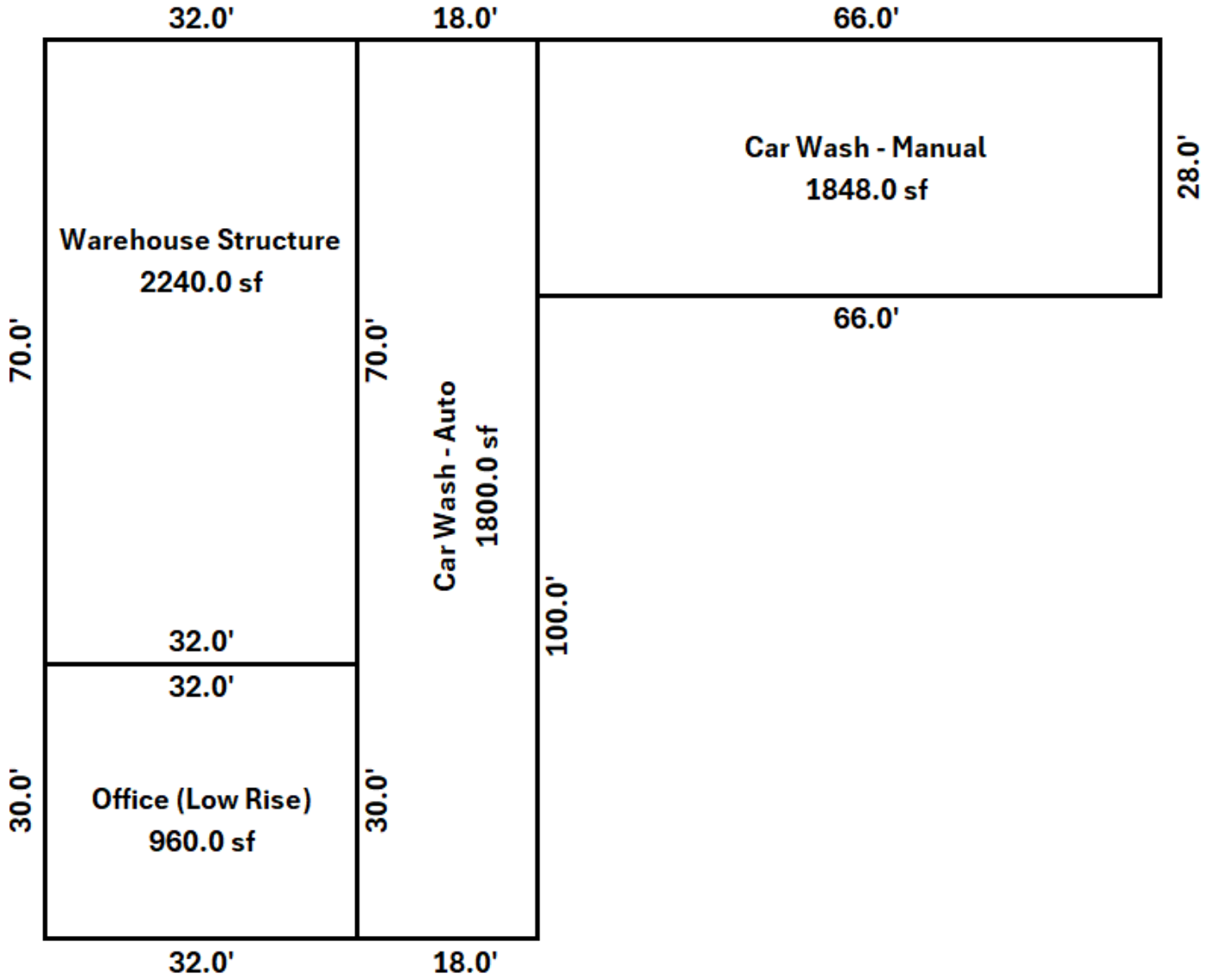

Aerial



FOR SALE - CARWASH

15190 Mahaffie St, Olathe, KS



CONTACTS:

Ryan Holcomb

c: 913.526.2904 | o: 913.747.3321
e: rholcomb@fishmancommercial.com

Lynn Holcomb

c: 816.289.1526 | o: 913.747.3301
e: lholcomb@fishmancommercial.com

Elliott Basler

c: 816.909.6968 | o: 913.708.8146
e: elliot@fishmancommercial.com

Information furnished regarding property is from sources deemed reliable but no warranty or representation is made as to the accuracy thereof and same is submitted subject to errors, omissions, prior sale of lease or withdrawal without notice.