

FOR LEASE

# PHILLIPS PARK

6120 – 2 STREET SE, CALGARY, AB



**Estelle Tran**  
Managing Director  
403 993 2898  
estelle.tran@kpliglobal.com

**Anastasiya Gryshchenko**  
CMO  
403 888 1748  
anastasiya.gry@kpliglobal.com



# PROPERTY OVERVIEW

<b>UNIT A16B</b>	4,436 sf
<b>OPERATING COST</b>	\$10.70
<b>AVAILABILITY</b>	Immediate
<b>PARKING</b>	Free surface parking
<b>CEILING HEIGHT</b>	9 feet
<b>YEAR BUILT</b>	1977
<b>CONSTRUCTION UPGRADES</b> <i>Exterior and Interior</i>	2019
<b>ZONING</b>	I-C Industrial - Commercial



## UPGRADED COMMON AREAS

Featuring a modernized elevator, refreshed building exterior, renovated lobbies, and updated corridors.



## FREE PARKING

Complimentary surface parking



## CENTRAL LOCATION

Ideal location, near Glenmore, Blackfoot and MacLeod Trails

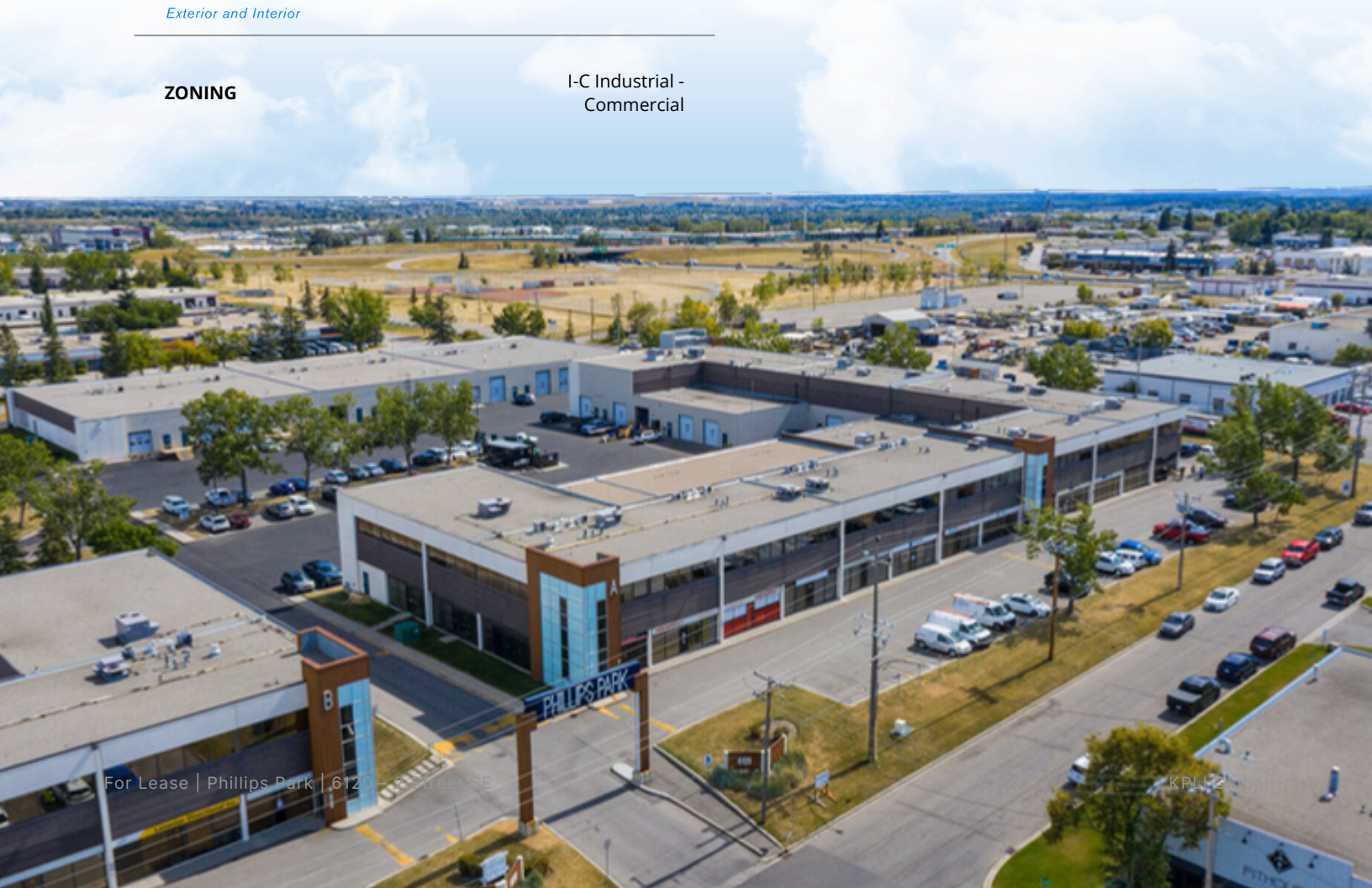

# UNIT A16B: 4,436 SF

SECOND FLOOR

Reception area, 10 Offices, Boardroom,  
Open area for workstations, Kitchen, Server room

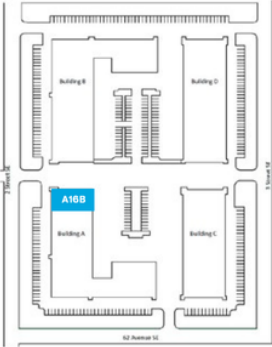
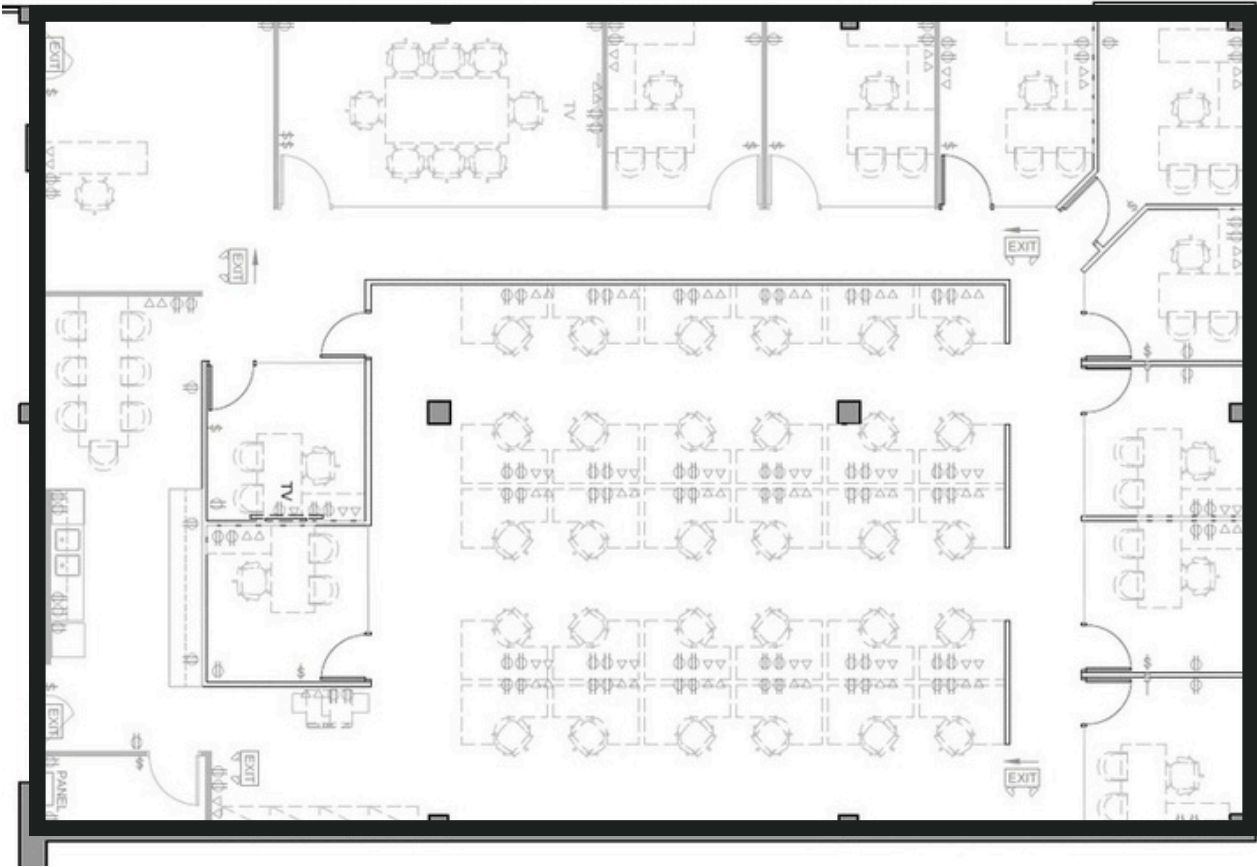



For Lease | Phillips Park | 6120 - 2 Street SE



KPLI Global



CONTACT US FOR MORE INFORMATION



**Estelle Tran**  
COO  
403 993 2898  
[estelle.tran@kpliglobal.com](mailto:estelle.tran@kpliglobal.com)



**Anastasiya Gryshchenko**  
CMO  
403 888 1748  
[anastasiya.gry@kpliglobal.com](mailto:anastasiya.gry@kpliglobal.com)