



FOR LEASE

±41,885 -59,701 SF INDUSTRIAL SPACES

7041 LAS POSITAS ROAD, LIVERMORE, CA 94551

LOCAL EXPERTISE. INTERNATIONAL REACH. WORLD CLASS.

Sean Offers, SIOR

Principal  
soffers@lee-associates.com  
925-737-4159  
LIC NO 01858116

Blake Dicus

Principal  
bdicus@lee-associates.com  
925-737-4144  
LIC NO 02074870

LEASED

SUITE F  
±43,948 SF  
Available  
11/01/2025

LEASED

SUITE A/B  
±59,701 SF  
Available Now

LAS POSITAS ROAD



PROPERTY HIGHLIGHTS



Property type: Industrial Spaces



Suite F: ± 43,948 SF  
Suite A/B: ± 59,701 SF



Min. Clear Height: 24 feet



Column spacing: 40'x50'



Fully insulated warehouses



Space Amenities:

- Pit levelers in place
- Motion sensor T-5 lighting
- Skylights



Lease rate:  
\$1.05/SF + \$0.23psf NNN

7041  
LAS POSITAS ROAD

Suite F: ±43,948 SF

- ± 4,233 SF of existing Office including four (4) Private Offices, Open Office, Break Room and two (2) Restrooms
- Power: 600 Amps, 480 Volt, 3 Phase (Tenant to Verify)
- Eight (8) 10'x10' Dock Level Doors
- One (1) 12'x14' Grade Level Door

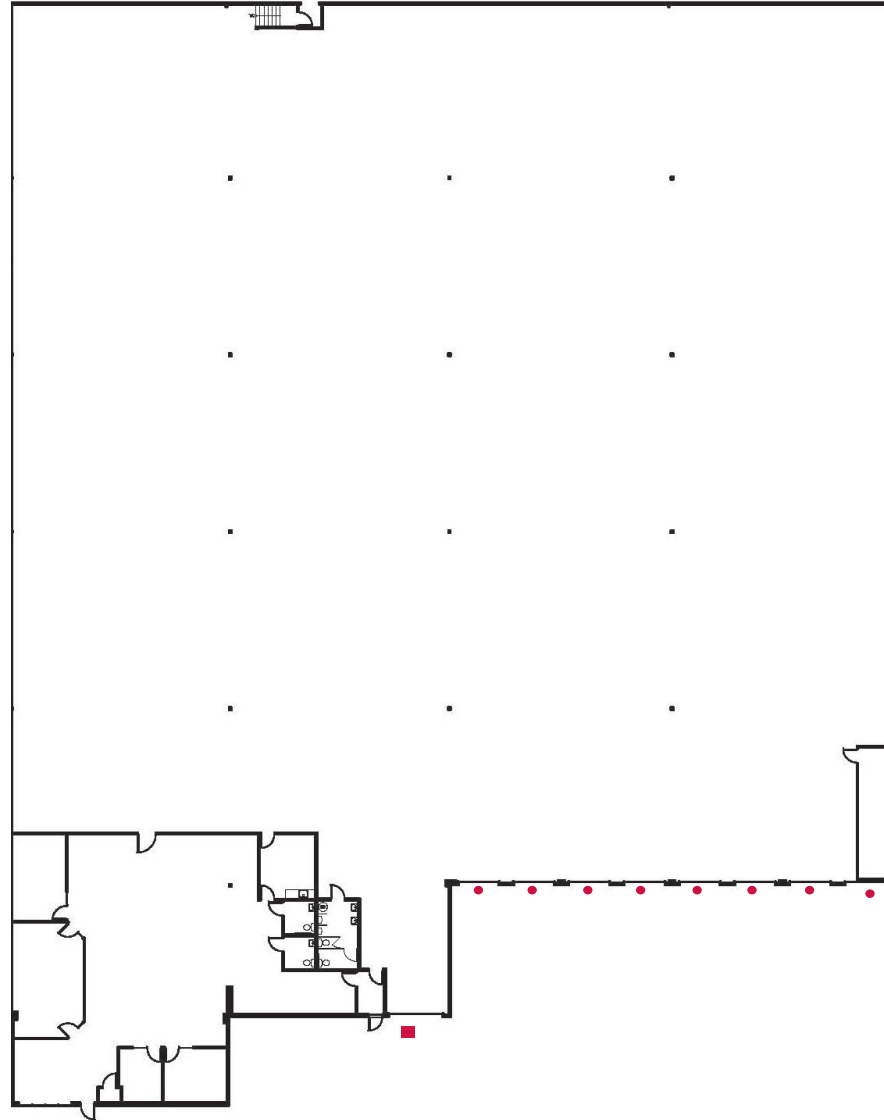

■ GRADE LEVEL DOOR

● DOCK HIGH DOOR

\*FLOOR PLAN NOT TO SCALE

7041  
LAS POSITAS ROAD

### Suite A/B: ±59,701 SF

- ± 6,990 SF of existing Office including six (6) Private Offices
- Bonus Mezzanine Space
- Power: 1,600 Amps, 277/480V (Tenant to Verify)
- Eight (8) 10'x10' Dock Level Doors
- Three (3) 12'x14' Grade Level Doors

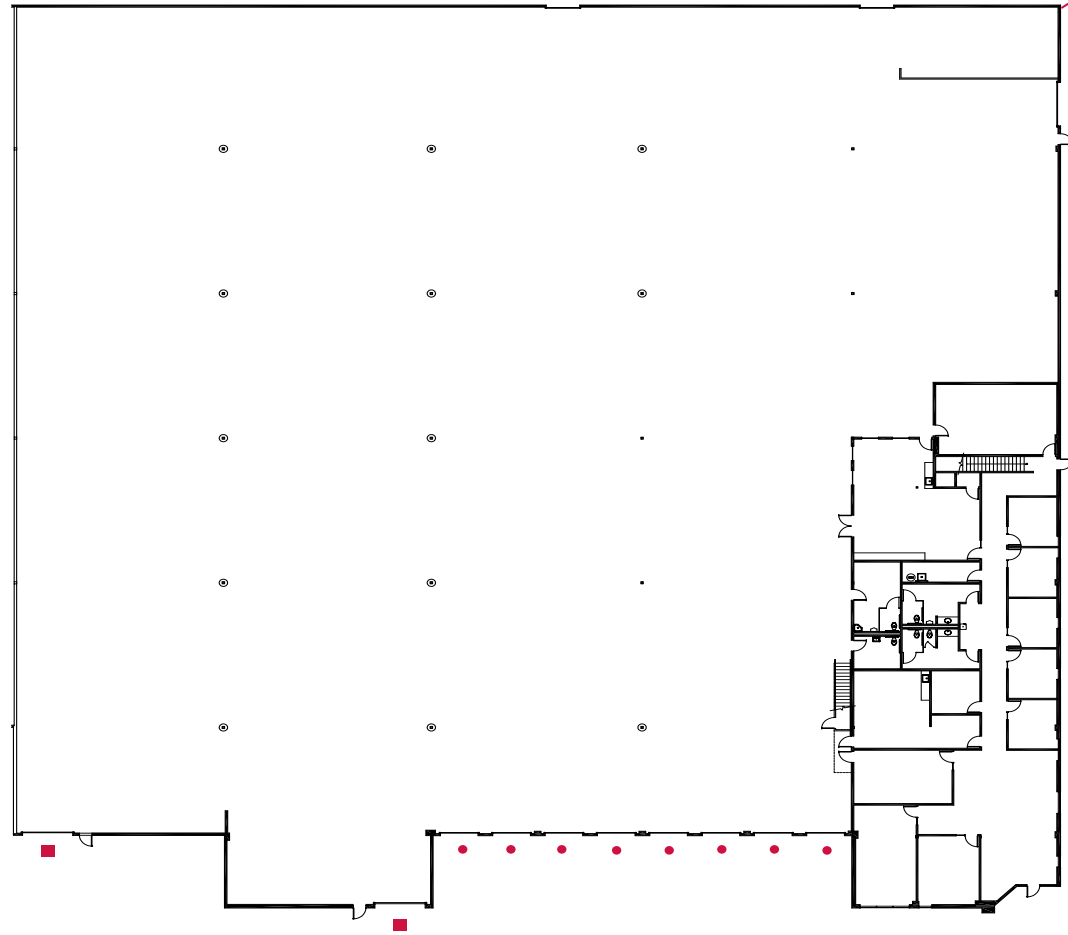
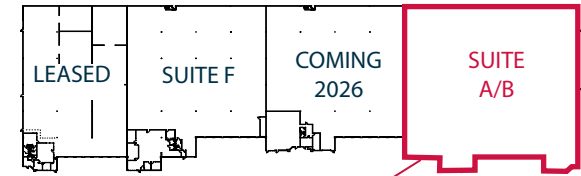

■ GRADE LEVEL DOOR

● DOCK HIGH DOOR

\*FLOOR PLAN NOT TO SCALE



VASCO ROAD



### DEMOGRAPHICS:

	15 MILES	30 MILES	45 MILES
2023 Total Population	465,706	3,741,303	8,035,515
Total Businesses	16,899	136,314	317,839
Total Employees	205,544	1,580,497	3,621,661
Manufacturing	601 / 3.6%	5,606 / 4.1%	10,776 / 3.4%
Manufacturing Employees	24,950 / 12.1%	218,560 / 13.8%	344,460 / 9.5%
Transportation & Warehousing	337 / 2.0%	3,235 / 2.4%	6,514 / 2.0%
Transportation & Warehousing Employees	2,836 / 1.4%	38,454 / 2.4%	96,854 / 2.7%

AERIAL MAP

REGIONAL MAP

BAY AREA ACCESS TO SITE ★

- 37 miles Port of Oakland
- 32 miles Oakland Airport
- 38 miles Port of Stockton
- 43 miles San Jose Airport
- 47 miles Port of San Francisco
- 49 miles San Francisco Airport
- 48 miles Port of Richmond
- 51 miles Port of Redwood City



WEST COAST ACCESS TO SITE ★

- 84 miles SACRAMENTO
- 648 miles PORTLAND
- 217 miles RENO
- 708 miles PHOENIX
- 337 miles LOS ANGELES
- 733 miles SALT LAKE CITY
- 456 miles SAN DIEGO
- 821 miles SEATTLE
- 524 miles LAS VEGAS
- 1,249 miles DENVER

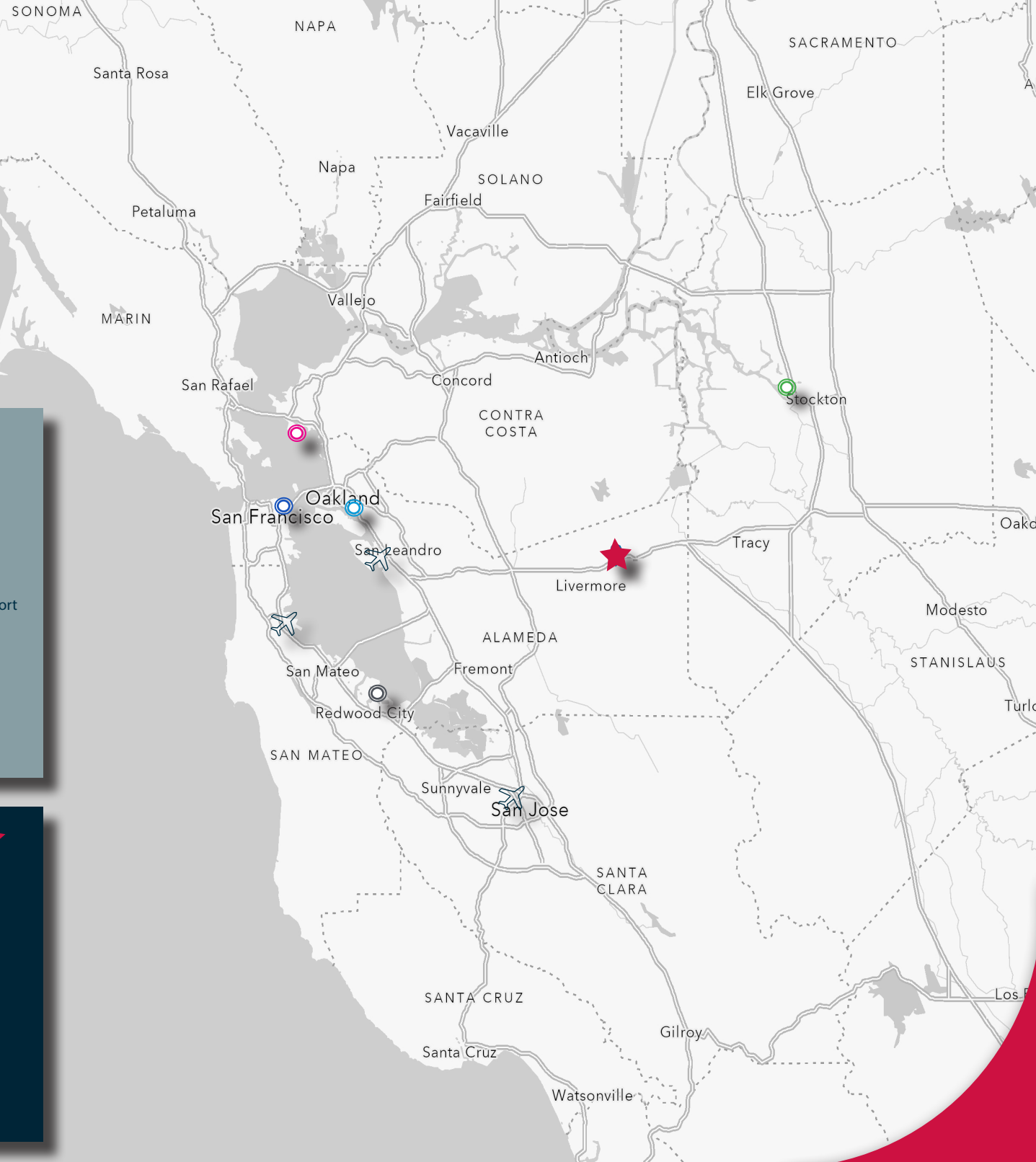

# FOR LEASE

±41,885 -59,701 SF INDUSTRIAL SPACES

7041 LAS POSITAS ROAD | LIVERMORE, CA 94551

## Sean Offers, SIOR

Principal  
soffers@lee-associates.com  
925-737-4159  
LIC NO 01858116

## Blake Dicus

Principal  
bdicus@lee-associates.com  
925-737-4144  
LIC NO 02074870

All information furnished regarding property for sale, rental or financing is from sources deemed reliable, but no warranty or representation is made to the accuracy thereof and same is submitted to errors, omissions, change of price, rental or other conditions prior to sale, lease or financing or withdrawal without notice. No liability of any kind is to be imposed on the broker herein

Lee & Associates® East Bay, Inc. Corp. ID 01194869 5000 Pleasanton Ave, Suite 220, Pleasanton, CA 94566

LEE - ASSOCIATES . COM / P L E A S A N T O N /

**7041**  
**LAS POSITAS ROAD**