

# THE RETAIL AT INTERNATIONAL EXCHANGE

**Iconic Restaurant Opportunity**

**11,200 SF**

**YOUR SIGN HERE**

**477 H St NW  
Washington, DC  
CBRE**



# CONTENTS

- 1** **Market Overview - Why East End**
- 2** **East End Retail Market**
- 3** **East End By The Numbers**
- 4** **The Neighborhood**
- 5** **The Opportunity**

# IT'S A Lifestyle

## WHY EAST END

Strategically positioned in the heart of D.C., East End is the mecca for trendy shopping, indulging in gourmet dining, and immersing yourself in a dynamic entertainment experience.

It's more than just a district; it's a lifestyle, and East End stands out as one of the most captivating retail submarkets in D.C., making it a one-of-a-kind premier retail destination for travelers and locals alike.

Be a part of the East End experience and discover a retail and entertainment world like no other.

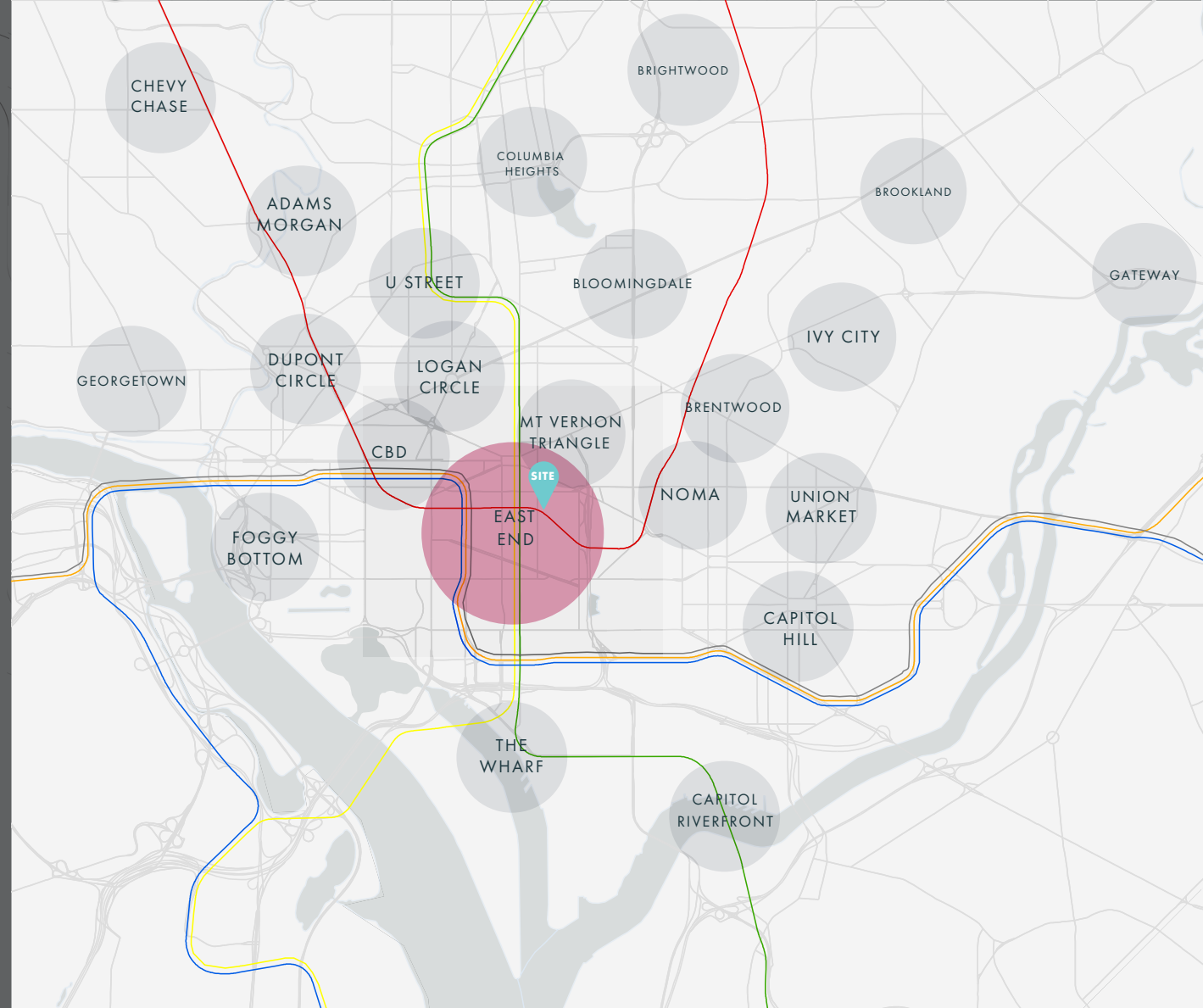



## THE "IT" PLACES

CityCenter DC's Conrad Hilton, Imperfecto by Enrique Limardo, Old Ebbitt Grill, Shoto, and The Hay Adams.



## POLITICIAN'S PLAYGROUND

Located between the U.S. Capitol and The White House, this is where political professionals let loose after 6PM.



## MICHELIN RESTAURANTS & SPORTS BARS

East End has it all. Whether you're looking for a quick bite, a night out on the town, or a gastronomic experience, we have it all here.



## SPORTS LOVERS & CONCERTGOERS UNITE

Capital One Arena hosts an average of 220 events a year and is home to the NBA's Washington Wizards and NHL's Washington Capitals.

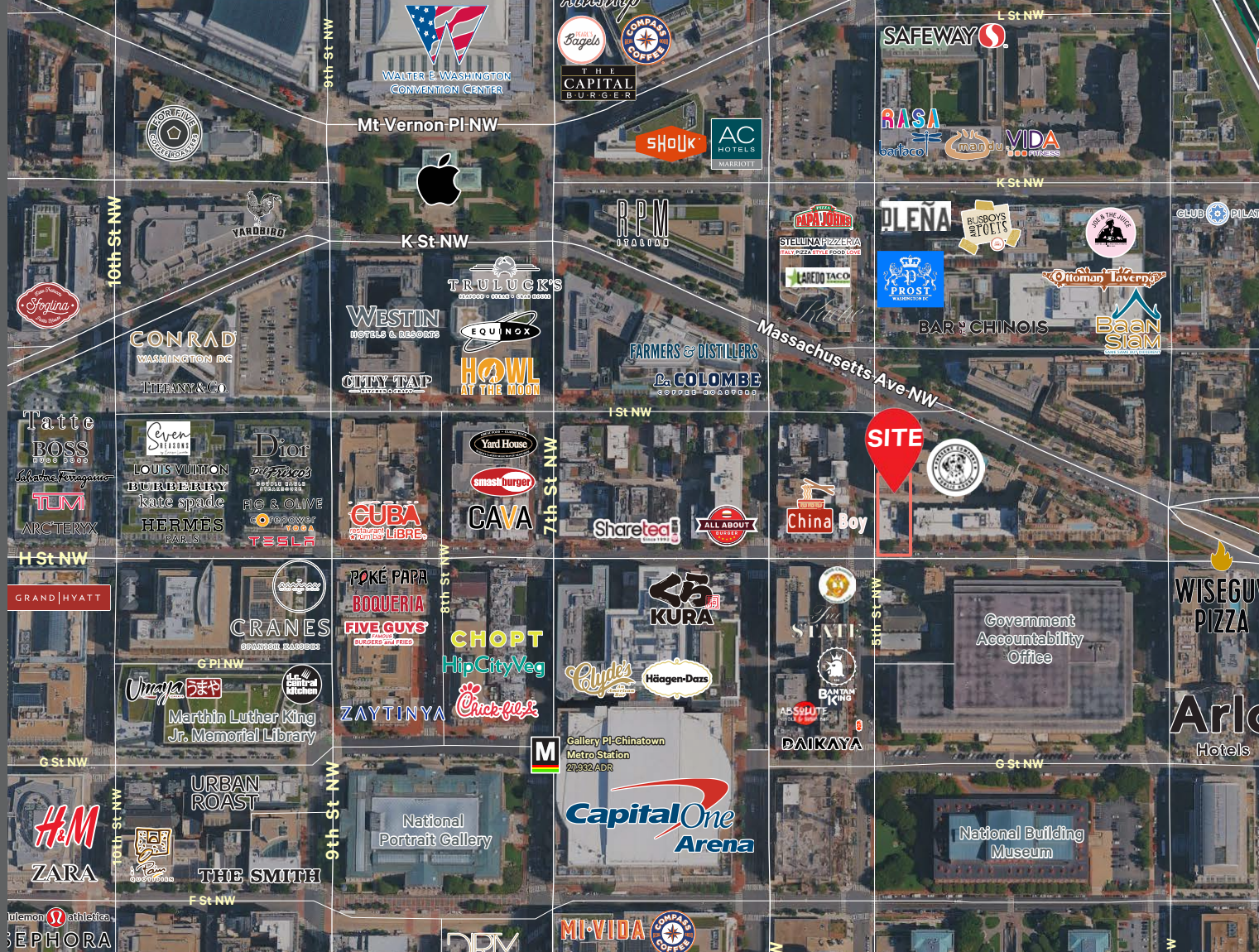

## A SHOPPERS' PARADISE

Surrounded by premier restaurants and retail

ANTHROPOLOGIE



RASIKA



ZARA



lululemon

OLD EBBITT GRILL

DRY HABIT

EXPRESS

BOQUERIA

★ PRET ★



NORDSTROM rack

ZAYTINYA

Tatte BAKERY & CAFE

Capital One



THE OCEANAIRE Seafood Room

J.CREW

EQUINOX

SUCCOTASH

SEPHORA

ANN TAYLOR

MI-VIDA RESTAURANTE

### \*CITY CENTER

BURBERRY kate spade NEW YORK

TIFFANY & Co. Del Frisco's

CENTROLINA WINE & CIGARS LOUIS VUITTON

GUCCI HERMÈS PARIS



# MARKET COMPARISON

\*0.5 Mile Radius

**447 H STREET IN  
THE EAST END SHINES  
ABOVE THE REST**



## East End, DC

**90,427**

DAYTIME POPULATION

**85,640**

EMPLOYEES

**94.7%**

OFFICE OCCUPANCY

**\$172,094**

AVG. HH INCOME

**81%**

BACHELOR'S DEGREE+

**\$80.4M**

ANNUAL SPEND  
DINING OUT

**\$48.0M**

ANNUAL SPEND  
APPAREL & SERVICES

## Bethesda, MD

**41,719**

DAYTIME POPULATION

**33,531**

EMPLOYEES

**89.3%**

OFFICE OCCUPANCY

**\$205,415**

AVG. HH INCOME

**87%**

BACHELOR'S DEGREE+

**\$55.2M**

ANNUAL SPEND  
DINING OUT

**\$32.6M**

ANNUAL SPEND  
APPAREL & SERVICES

## National Landing, VA

**29,598**

DAYTIME POPULATION

**16,026**

EMPLOYEES

**90.9%**

OFFICE OCCUPANCY

**\$167,306**

AVG. HH INCOME

**84%**

BACHELOR'S DEGREE+

**\$37.3M**

ANNUAL SPEND  
DINING OUT

**\$22.1M**

ANNUAL SPEND  
APPAREL & SERVICES

## Tysons Corner, VA

**43,809**

DAYTIME POPULATION

**23,939**

EMPLOYEES

**98.7%**

OFFICE OCCUPANCY

**\$193,203**

AVG. HH INCOME

**82%**

BACHELOR'S DEGREE+

**\$7.7M**

ANNUAL SPEND  
DINING OUT

**\$4.5M**

ANNUAL SPEND  
APPAREL & SERVICES

# MEET YOUR CUSTOMER

0.5 MILES

## METRO RENTERS (50.9%)



### AGE GROUP

Late 20s – Mid 30s



### HOUSEHOLD

Singles



### MEDIAN HH INCOME

\$67K

- Young urban renters in dense, walkable neighborhoods
- Tech savvy, convenience minded consumers
- Strong spending on dining, fitness, and daily retail

## LAPTOPS & LATTES (35.8%)



### AGE GROUP

30s



### HOUSEHOLD

Singles



### MEDIAN HH INCOME

\$112K

- Affluent, highly educated urban professionals in high-income careers
- High discretionary spending on premium dining & coffee, fitness, and lifestyle retail & services
- Digitally connected work-from-anywhere lifestyle

100  
TRANSIT  
SCORE

86  
WALK  
SCORE

85  
BIKE  
SCORE

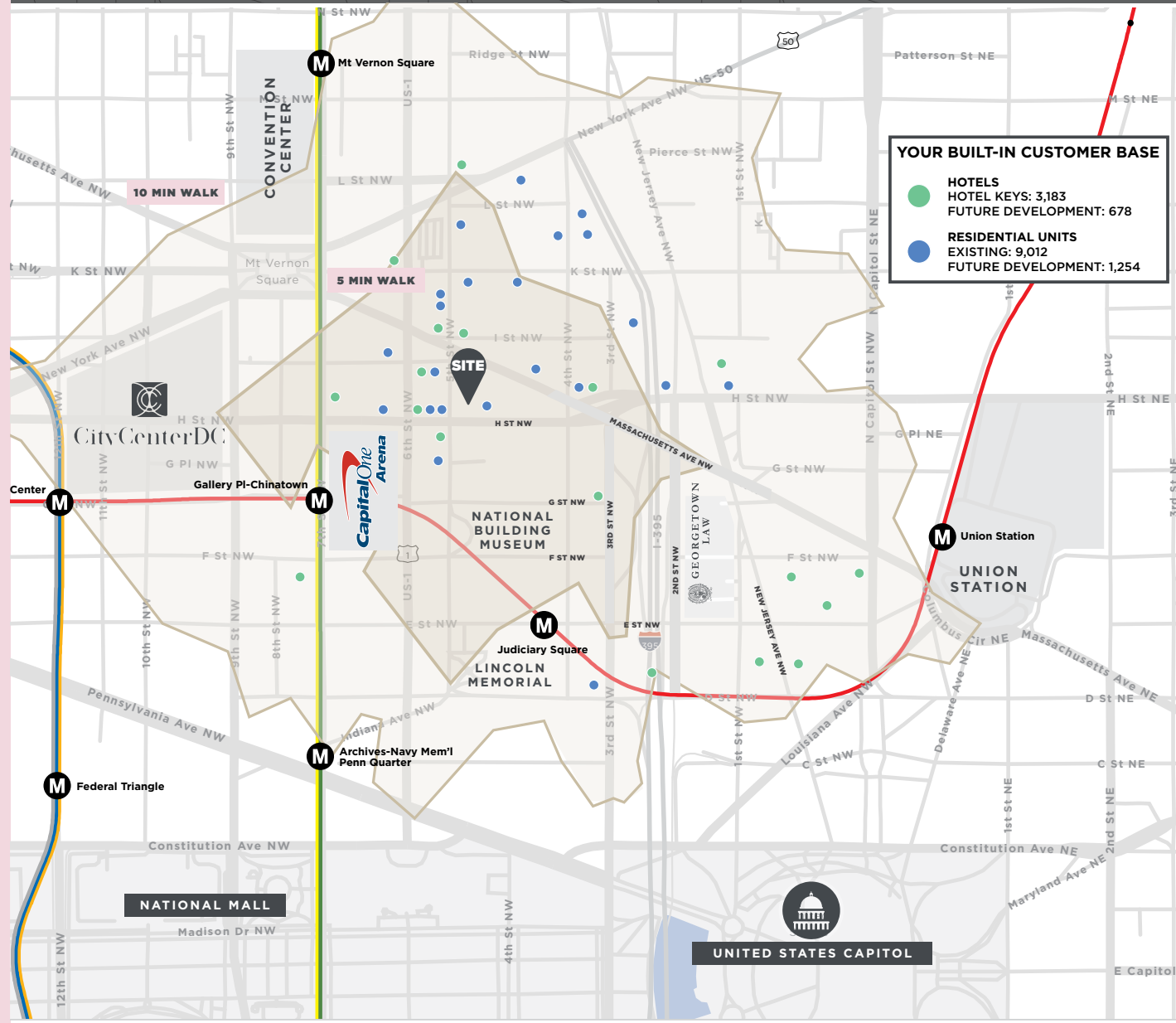

# THE OPPORTUNITY

## PROPERTY HIGHLIGHTS

~ **11,200 SF flagship restaurant space** spanning three levels plus mezzanine, offering rare scale and flexibility for destination dining and nightlife.

~ **Prime corner location** at H Street NW & 5th Street NW with **exceptional visibility** in the heart of Chinatown / Penn Quarter, one of DC's most active dining and entertainment districts.

~ **Steps from Gallery Place—Chinatown Metro and Capital One Arena**, benefiting from heavy daily foot traffic and strong pre-/post-event dining demand.

~ **Fully modernized infrastructure** (new roof, upgraded electrical, gas & water lines, full sprinkler system, and elevator) with D-4 zoning and liquor license availability, reducing time to open.

# ICONIC RETAIL OFFERING

## SITE PLAN

**THIRD FLOOR**  
2,942 SF



**SECOND FLOOR**  
2,942 SF



**FIRST FLOOR**  
2,942 SF

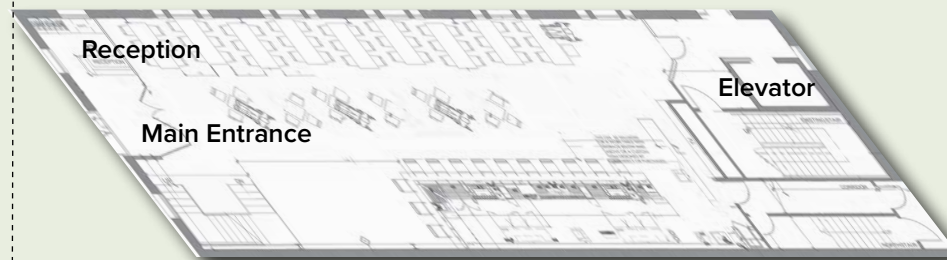

**CELLAR FLOOR**  
2,939 SF





**PROUDLY REPRESENTED BY:**

**MICHAEL ZACHARIA**

202.489.3815  
Michael.Zacharia@cbre.com

**REILLY HUDSON**

301.758.6497  
Reilly.Hudson@cbre.com

**ERIKA DALISERA**

410.353.9713  
Erika.Dalisera@cbre.com

**CBRE**

© 2023 CBRE, Inc. All rights reserved. This information has been obtained from sources believed reliable, but has not been verified for accuracy or completeness. You should conduct a careful, independent investigation of the property and verify all information. Any reliance on this information is solely at your own risk. CBRE and the CBRE logo are service marks of CBRE, Inc. All other marks displayed on this document are the property of their respective owners, and the use of such logos does not imply any affiliation with or endorsement of CBRE. Photos herein are the property of their respective owners. Use of these images without the express written consent of the owner is prohibited.