

**1,944 SF INDUSTRIAL SPACE AVAILABLE
BUILDING 5, SUITE 540**

12000 NE 95TH STREET, SUITE 540, VANCOUVER, WA 98682

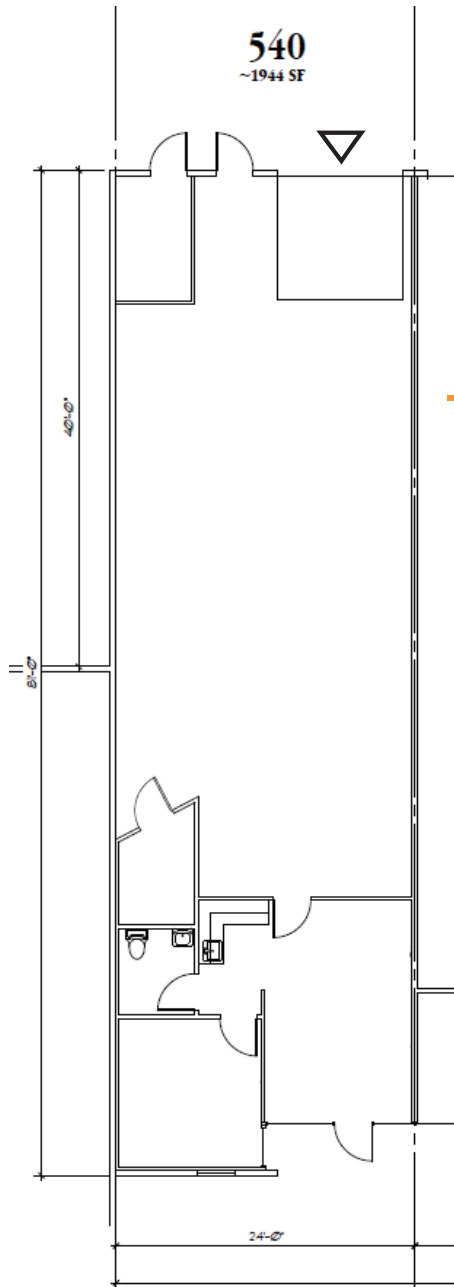

△ = Grade Door

**SUITE 540
HIGHLIGHTS & FEATURES**

- 541 SF Office Space
- 1 Grade Door
- 12' Clear Height
- 120/208 Volt, 3-Phase Power
- Sprinklered Building
- Zoned for Light Industrial Use
- Ample Parking
- On-Site Property Management
- Restaurants and Retail Amenities nearby:
Los Jalapenos, Columbia Credit Union,
Papa John's Pizza, Chevron, Seize the Bagel
& Many More

paddencp.com

Available: February 2026



PADDEN

COMMERCE PARK

FOR LEASE

NOW AVAILABLE! BUILDING 5, SUITE 540

12000 NE 95th Street, Suite 540, Vancouver, WA 98682

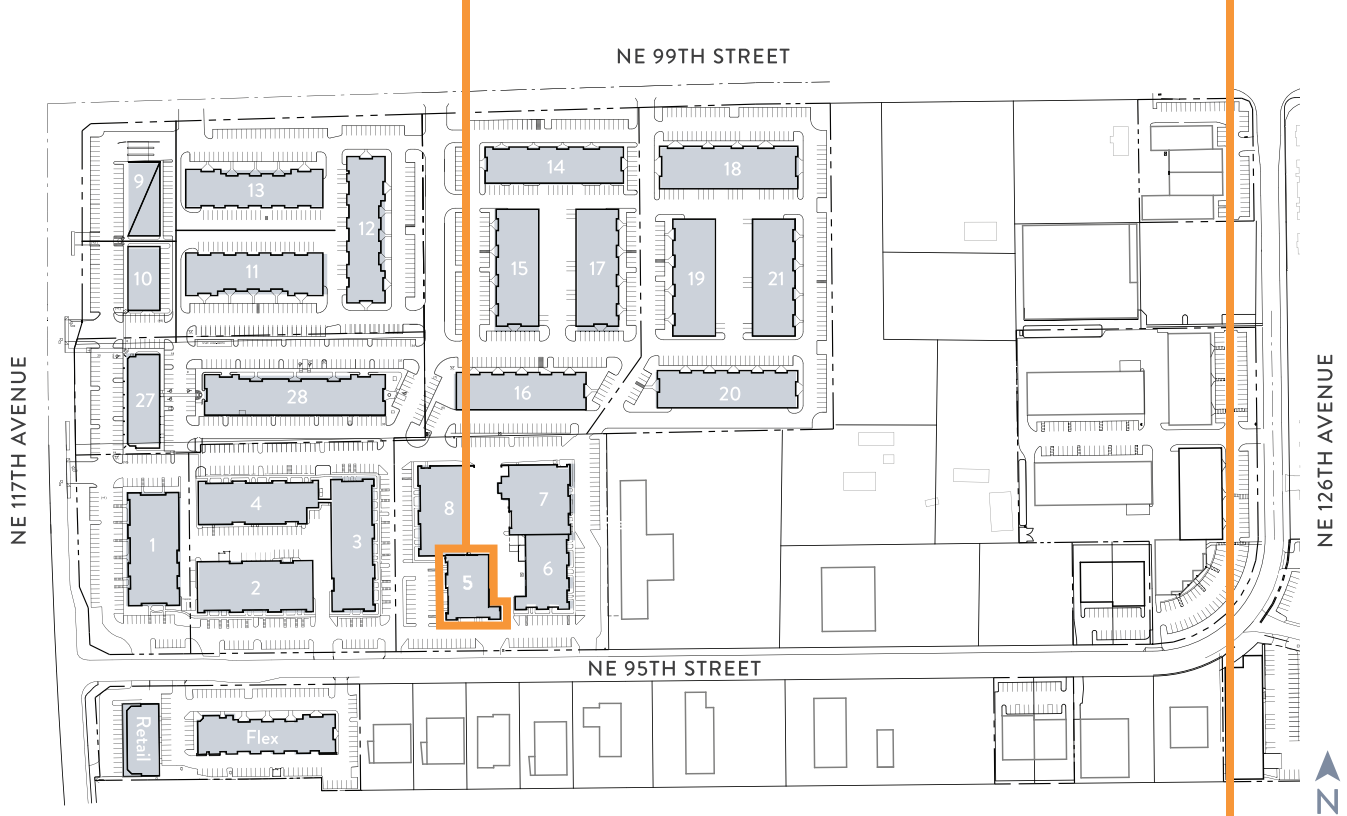

LEASING CONTACTS

Coleman Brown, CCIM, Principal Broker
Columbia Commercial, LLC
Coleman@CCPprop.com
360.952.4758

paddencp.com



OWNED & MANAGED BY:



**Columbia
Commercial**
Commercial Leasing | Sales | Property Management

WESTCORE
PROPERTIES