

# ALDARRA CORPORATE PARK

6528 S 216th Street, Kent, WA 98032



25,203 SF  
Industrial Space  
for lease





**AVAILABLE**

30 days notice



**25,203 SF**

Shell and 5,618 SF office



**30'**

Clear height



**4**

dock-high doors



**End-cap**

space



**1**

drive-in door



**Corporate**

image



**Contact brokers**

for rates

# UNLOCK YOUR POTENTIAL

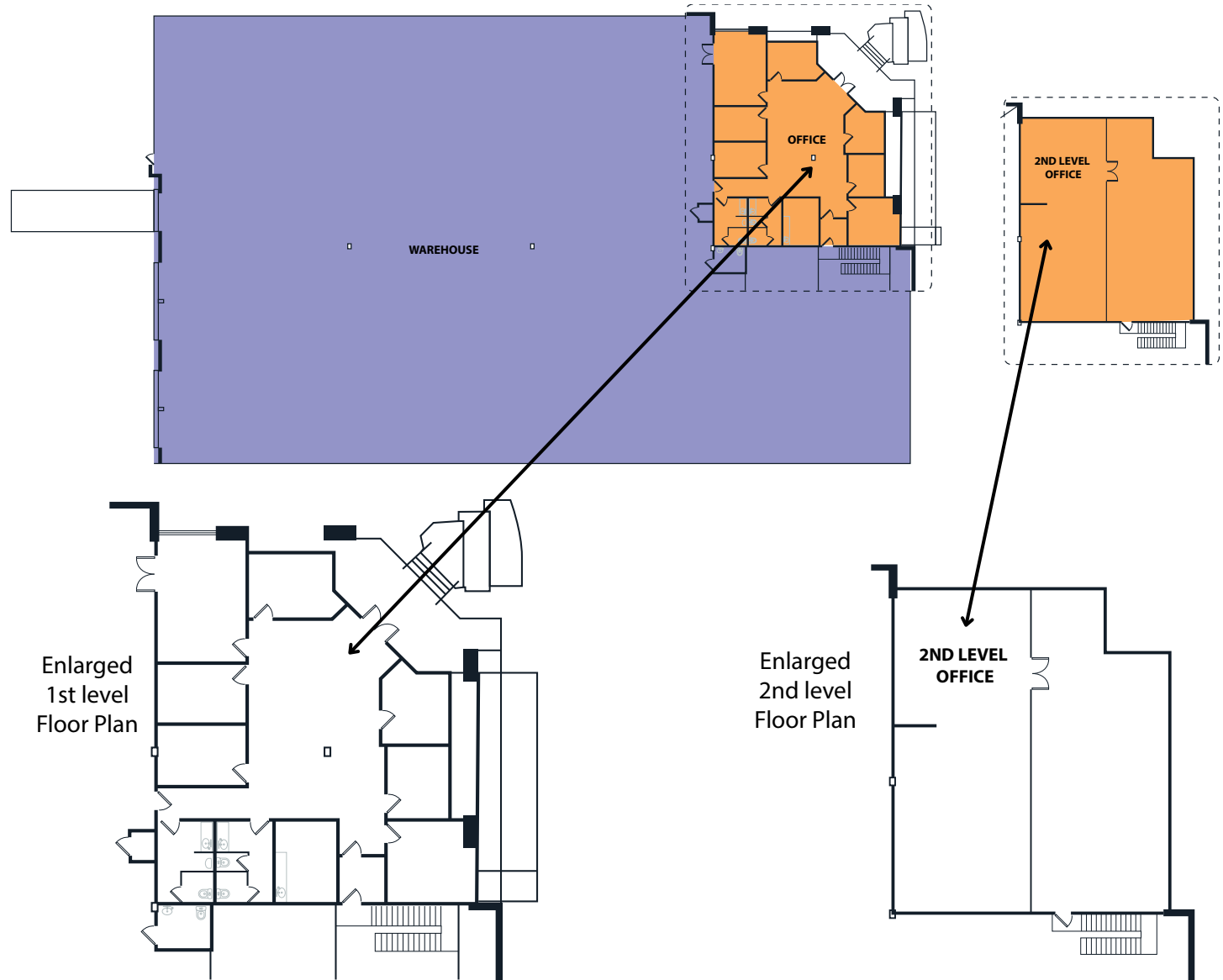

25,203 SF  
available



## FOR INFORMATION CONTACT:

David Cahill  
+1 206 930 5599  
david.cahill@jll.com

Chris Spofford  
+1 425 890 6961  
chris.spofford@jll.com

