

PLAN KEY NOTES (B)

1. TOILET PARTITION
2. 8" LONG x 1/2" DIA. GRAB BARS PROVIDE BLOCKING FOR ATTACHMENT
3. 48" LONG x 1 1/2" DIA. GRAB BARS PROVIDE BLOCKING FOR ATTACHMENT
4. HANDICAP ACCESSIBLE SHOWER
5. 24" LONG x 1 1/2" DIA. GRAB BAR PROVIDE BLOCKING FOR ATTACHMENT
6. 42" LONG x 1 1/2" DIA. GRAB BAR PROVIDE BLOCKING FOR ATTACHMENT
7. TOWEL HOOKS, LOCATED AT 72" A.F.F. (ONE PER SHOWER)
8. SHOWER HEAD
9. FLOOR MOUNTED TOILET
10. JANITOR'S MOP SINK
11. COUNTERTOP WITH INTEGRAL LAVATORY SINKS - SEE I.D. DRAWINGS
12. LOCKERS - SEE SPECIFICATIONS FINISH PER I.D. DRAWINGS
13. BENCHES BY G.C., SEE I.D. DWGS
14. PUBLIC PAY PHONE (N.I.C.)
15. ACCESSIBLE COUNTER, 34" A.F.F. MAX. - SEE I.D. DRAWINGS
16. NOT USED
17. STAINLESS STEEL HAT CHANNEL WITH (10) TOWEL HOOKS AT POOL AND AT SPA. PROVIDE BACKING AT WALL STUDS
18. FLOOR DRAIN
19. NOT USED
20. 12" HIGH x 24" SPLASH GUARD, WELDED TO PREP SINK
21. H.C. ACCESSIBLE CLEAR FLOOR SPACE
22. URINAL - WALL MOUNTED
23. SHOWER ACCESSORIES (SHOWER ROD, SOAP DISPENSERS AND SOAP SHELVES) TO BE COORDINATED BY I.D. DWGS. PROVIDED ALLOWANCE IF NOT SPECIFIED
24. HANDICAP ACCESSIBLE LOCKER
25. MIRROR - SEE I.D. DRAWINGS
26. SEE PLUMBING DWGS AND POOL CONSULTANT DWGS FOR EQUIPMENT LAYOUT IN THIS ROOM. POOL EQUIPMENT TO BE MOUNTED ON EASILY CLEANABLE, NON ABSORBENT MATERIAL WITH 1/4" PER FT. SLOPED TO DRAIN
27. UPPER AND LOWER BENCH TO BE FRAMED WITH 2x4 FRAMING LUMBER. SEE I.D. DWGS
28. SAUNA HEATER
29. HANDICAP ACCESSIBLE STALL
30. LOUVER VENT - SEE MECH DWGS. PROVIDE 5/8" DIA. STEEL BURGULAR BARS SPACED @ 8" O.C. WELDED AT INTERSECTIONS AND TO STEEL CHANNEL FRAME. ATTACH FRAME TO WALL OPENING WITH 1/2" DIA. ANCHOR BOLTS @ 24" O.C.
31. MOP AND BROOM HOLDER WITH 34" LONG SHELF
32. LAVATORY
33. ARCHITECTURAL MILLWORK - SEE I.D. DWGS
34. LOW ELECTRIC WATER COOLER
35. FLOOR SINK
36. FIRE EXTINGUISHER
37. SHOWER SEAT
38. ACCESSIBLE HANDRAIL @ POOL 34" A.F.F.
39. DRINKING FOUNTAIN
40. HANDRAIL @ 36"
41. GUARDRAIL @ 42" A.F.F.
42. POOL EQUIPMENT - SEE POOL CONSULTANT DWGS
43. PARTITION WITH 1/2" TEMPERED GLAZING WITH APPLIED FILT - SEE I.D. DRAWINGS
44. SWIM SUIT WATER EXTRACTOR. SEE PRODUCT SPECIFICATIONS FOR INSTALLATION REQUIREMENTS. ALSO SEE M.E.P. DRAWINGS
45. THERMOSTAT CABINET SEE IS/AT 4 FOR DETAIL & MOUNTING HEIGHT
46. PROVIDE BLOCKING AT ALL TOILET AND URINAL PARTITIONS
47. PROVIDE BLOCKING AT ALL WALL MOUNTED ACCESSORIES
48. SHOWER ROD

GENERAL NOTES

1. ALL EXTERIOR DIMENSIONS ARE FINISH TO FINISH DIMENSIONS
2. ALL INTERIOR PARTITION DIMENSIONS ARE FRAMING TO FRAMING DIMENSIONS

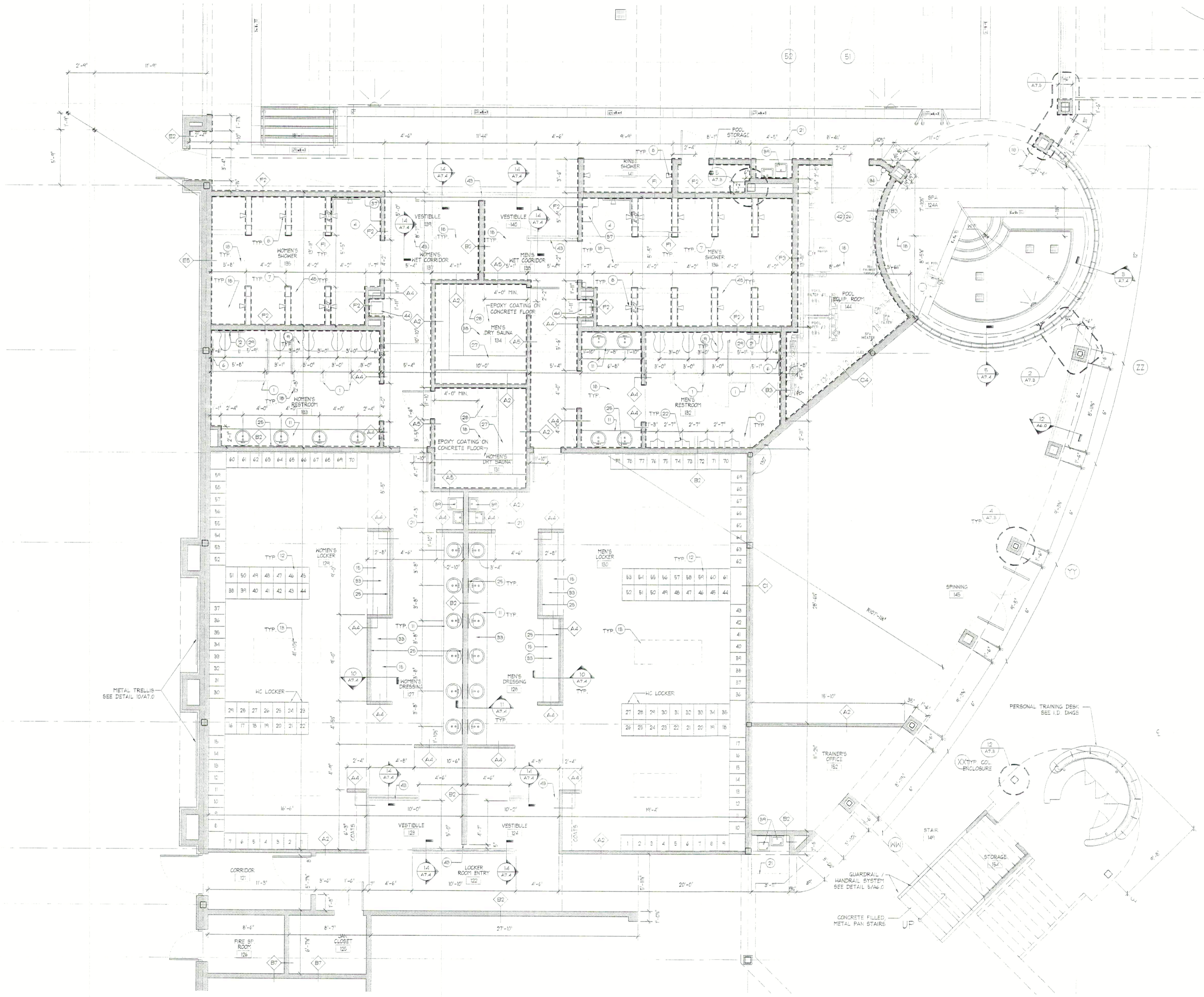

1 ENLARGED FLOOR PLAN
1/4" = 1'-0"

PLAN NORTH



BL Companies
ARCHITECTURE
ENGINEERING
PLANNING
LANDSCAPE ARCHITECTURE
LAND SURVEYING
ENVIRONMENTAL SCIENCES

355 Research Parkway
Middletown, CT 06457
(203) 630-1400
(203) 630-2615 Fax

LA FITNESS
1979 FARMINGTON AVENUE (RT. 6)
BRISTOL, CONNECTICUT
LOT#1 - BLOCK #

REVISIONS
No. Description
1. AS NOTED
2. 06/08/02
Date 05/14/07

This
ENLARGED FLOOR PLAN

Sheet No.

A3.6

THESE DRAWINGS SHALL NOT BE UTILIZED BY ANY PERSON, FIRM OR CORPORATION WITHOUT THE SPECIFIC WRITTEN PERMISSION OF BL COMPANIES.