

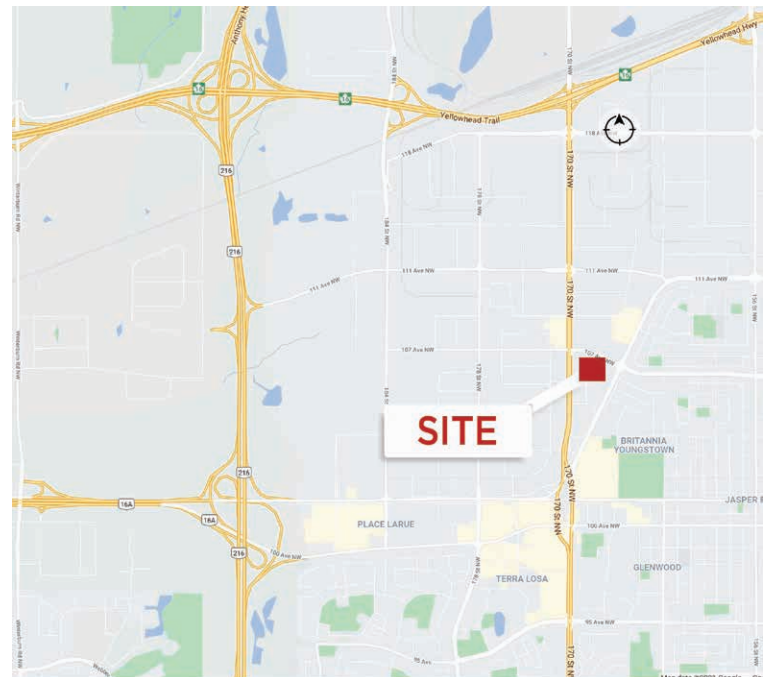

## 8,954 Square Feet of Brand New Flex Space

### Property Highlights

- Brand new construction of prominent showroom/flex space with high ceilings, striking glazing and upper windows
- Concrete construction provides high-end, corporate image
- Join Julian Tile in this A Class Property
- Perfect for all home renovation uses, kitchen/bath/plumbing, lighting, furniture, and outdoor living
- Close proximity to 170 Street and Mayfield Road, allowing for fast and efficient access to all parts of Greater Edmonton.



**Royce Johnson**  
Associate  
780 702 2950  
royce.johnson@cwedm.com

**Nicholas Hrebien**  
Associate  
780 917 8345  
nicholas.hrebien@cwedm.com

**CUSHMAN & WAKEFIELD**  
Edmonton  
Suite 2700, TD Tower  
10088 - 102 Avenue  
Edmonton, AB T5J 2Z1  
[www.cwedm.com](http://www.cwedm.com)

## Property Details

<b>Municipal Address:</b>	10537 169 Street, Edmonton, AB	<b>Ceiling Height:</b>	25' clear
<b>Legal Description:</b>	Plan 9722637, Block 2, Lot 19C	<b>Power:</b>	TBC
<b>Zoning:</b>	IM - Medium Industrial	<b>Tenant Improvement:</b>	Negotiable
<b>Available Area:</b>	8,954 SF	<b>Lease Rate:</b>	\$10.00 Per SF
<b>Parking:</b>	Shared/Unreserved Surface Parking	<b>Operating Costs:</b>	\$4.00 Per SF (2021 Est.)
<b>Loading:</b>	12' x 14' Grade Loading, front loading, overhead doors	<b>Available:</b>	Immediately for Tenant Fixturing

## Proposed Layout Plan

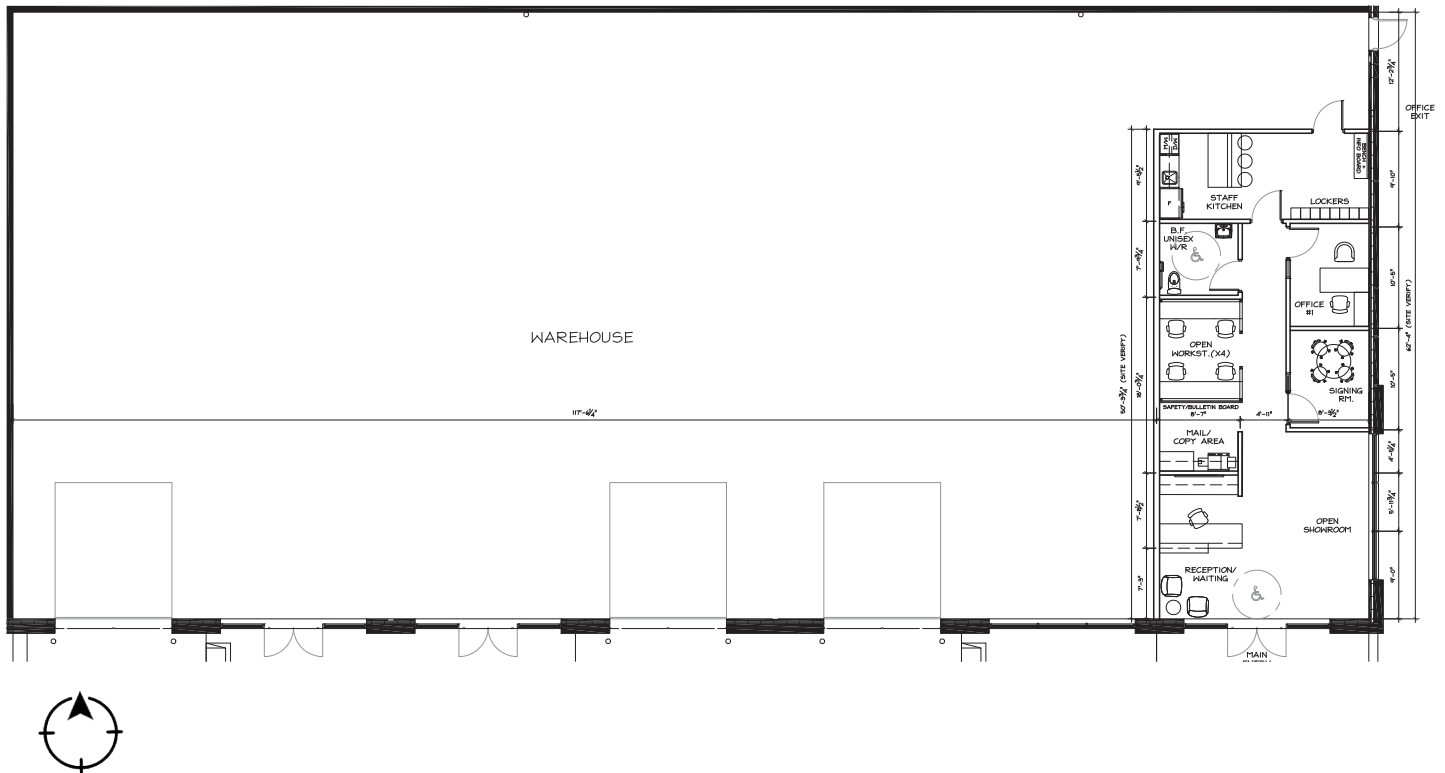

**Royce Johnson**  
Associate  
780 702 2950  
royce.johnson@cwedm.com

**Nicholas Hrebien**  
Associate  
780 917 8345  
nicholas.hrebien@cwedm.com

**CUSHMAN & WAKEFIELD**  
Edmonton  
Suite 2700, TD Tower  
10088 - 102 Avenue  
Edmonton, AB T5J 2Z1  
[www.cwedm.com](http://www.cwedm.com)

**Property Photos**



**Royce Johnson**  
Associate  
780 702 2950  
royce.johnson@cwedm.com

**Nicholas Hrebien**  
Associate  
780 917 8345  
nicholas.hrebien@cwedm.com

**CUSHMAN & WAKEFIELD**  
**Edmonton**  
Suite 2700, TD Tower  
10088 - 102 Avenue  
Edmonton, AB T5J 2Z1  
[www.cwedm.com](http://www.cwedm.com)

## Demographics

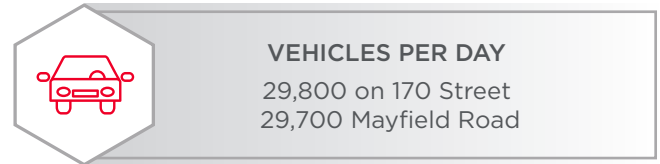
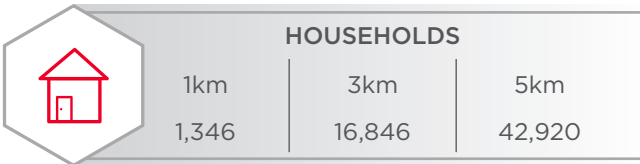
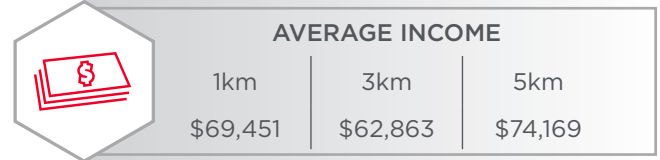
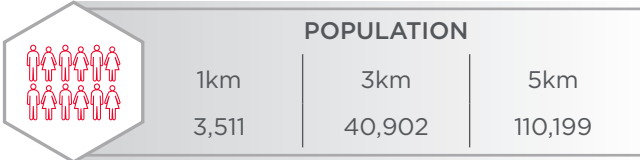

## Aerial

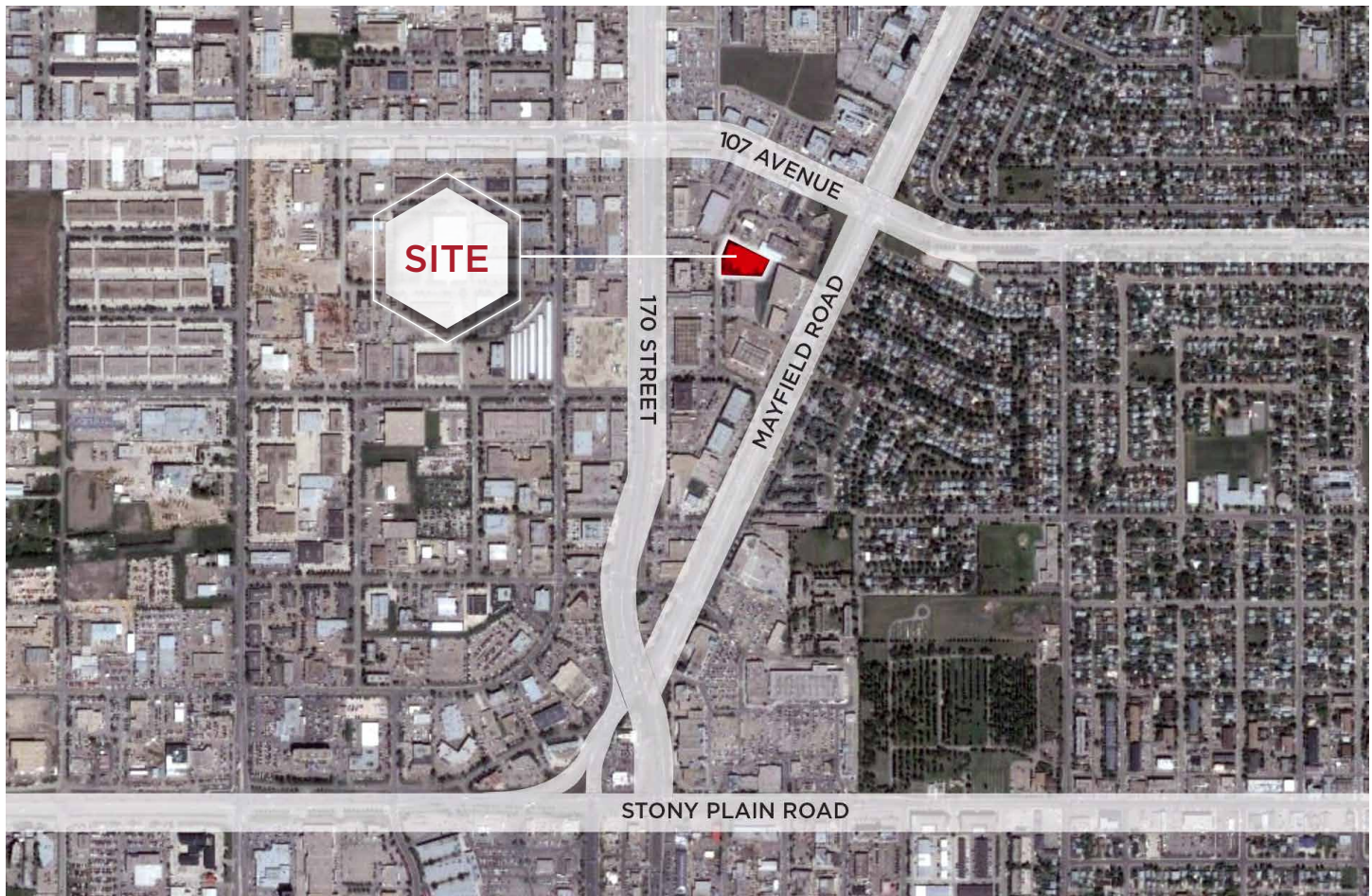

**Royce Johnson**  
Associate  
780 702 2950  
royce.johnson@cwedm.com

**Nicholas Hrebien**  
Associate  
780 917 8345  
nicholas.hrebien@cwedm.com

**CUSHMAN & WAKEFIELD**  
Edmonton  
Suite 2700, TD Tower  
10088 - 102 Avenue  
Edmonton, AB T5J 2Z1  
[www.cwedm.com](http://www.cwedm.com)