



# 7,250 SF AVAILABLE

2520 Park Central Blvd  
Suite C1A-B  
DECATUR, GA 30035



## FOR LEASE



### PROPERTY INFORMATION

**Total Size:** 7,250 SF  
**Office:** 2,170 SF  
**Warehouse:** 5,080 SF  
**Loading:** Two (2) Dock High Doors  
**Clear Height:** 18'  
**Available:** Immediately

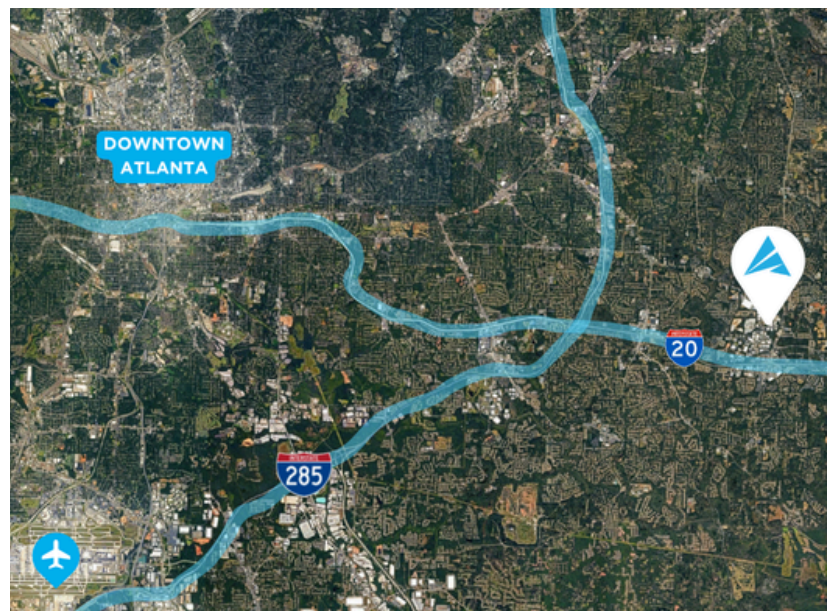

For more information, please contact:

#### TREY WEGHORST

Office: (770) 264-9420  
Cell: (404) 276-9314  
tweghorst@apexindustrialre.com

#### RECE MOORE

Office: (404) 574-6311  
Cell: (770) 861-8140  
rmoore@apexindustrialre.com



Although the information contained therein was provided from sources believed to be reliable, Apex Industrial makes no representation, expressed or implied, as to its accuracy and said information is subject to errors, omissions or changes.



**7,250 SF AVAILABLE**

2520 Park Central Blvd

Suite C1A-B

DECATUR, GA 30035



# FLOOR PLAN

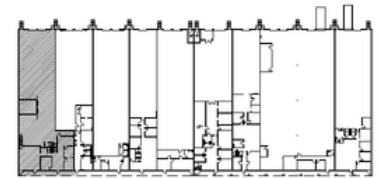

KEYPLAN

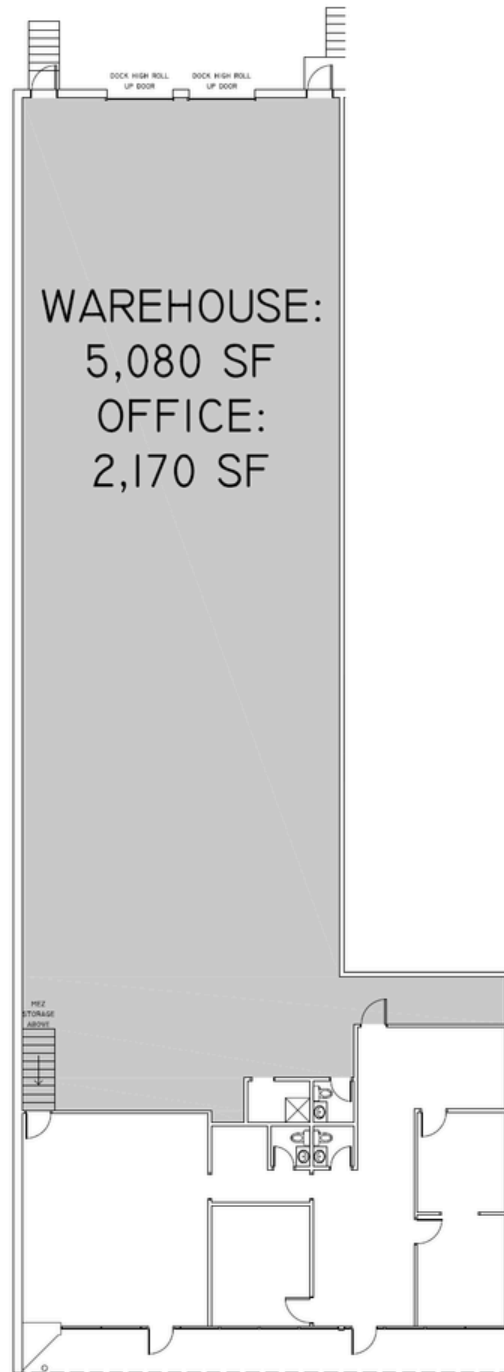

For more information, please contact:

**TREY WEGHORST**

Office: (770) 264-9420

Cell: (404) 276-9314

[tweghorst@apexindustrialre.com](mailto:tweghorst@apexindustrialre.com)

**RECE MOORE**

Office: (404) 574-6311

Cell: (770) 861-8140

[rmoore@apexindustrialre.com](mailto:rmoore@apexindustrialre.com)



Although the information contained therein was provided from sources believed to be reliable, Apex Industrial makes no representation, expressed or implied, as to its accuracy and said information is subject to errors, omissions or changes.