

**AVAILABLE FOR SUBLEASE**

**±2,257 SF INDUSTRIAL // SHOWROOM**

**INTERSTATE BUSINESS PARK**

24335 PRIELIPP RD., SUITE 113 | WILDOMAR, CA

**24335**

## SUITE FEATURES

- Freeway Frontage and Visibility
- 2 Offices, Reception and 2 Restrooms
- GL Loading
- Ownership to Consider Long Term Deals
- Sublease through August 31, 2028

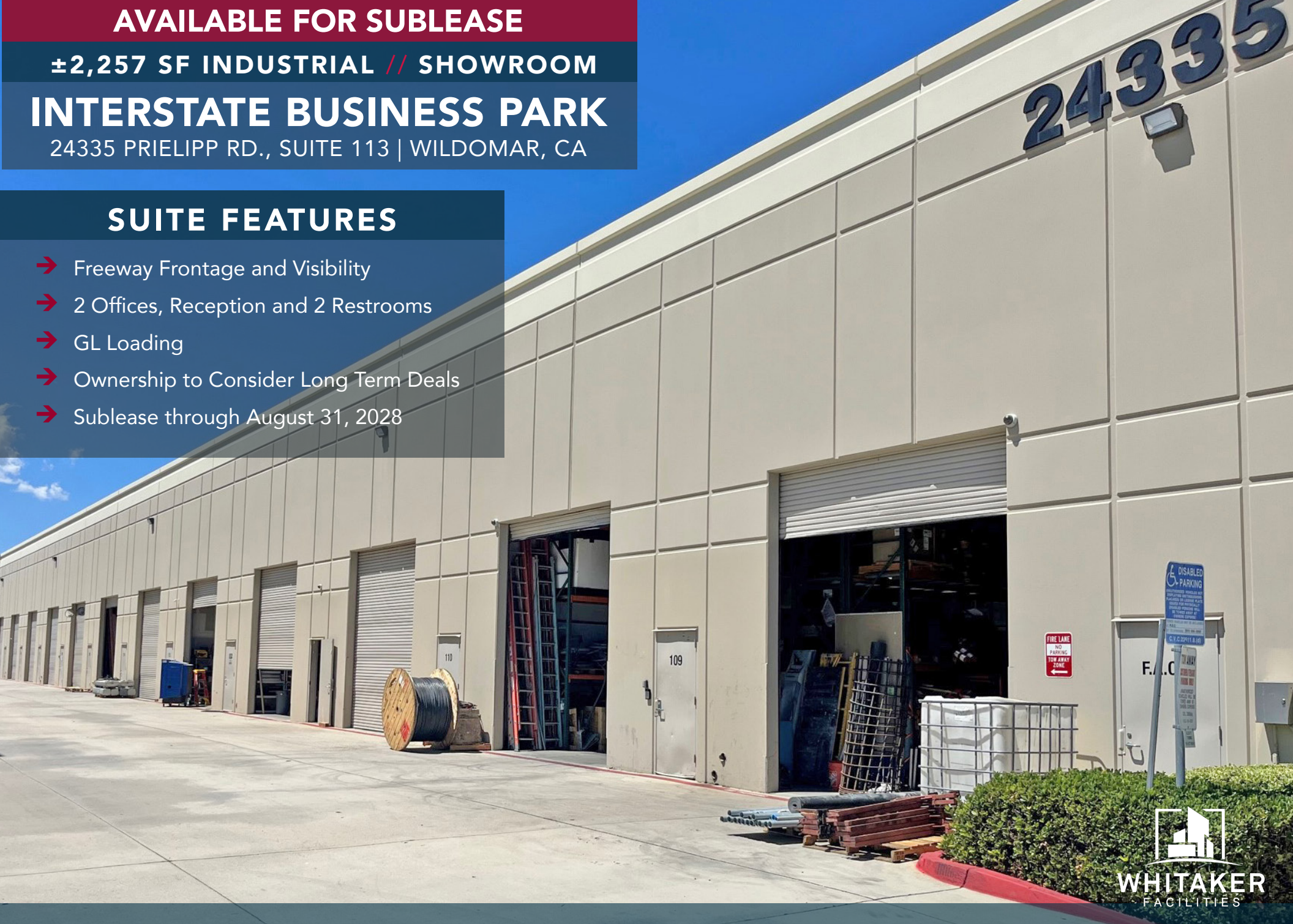

**WHITAKER**  
FACILITIES

**AVAILABLE FOR SUBLEASE**

**±2,257 SF INDUSTRIAL // SHOWROOM**

# **INTERSTATE BUSINESS PARK**

24335 PRIELIPP RD., SUITE 113 | WILDOMAR, CA

**±2,257 SF  
AVAILABLE  
FOR SUBLEASE**



**KEVIN RD.**



**WHITAKER  
FACILITIES**

**AVAILABLE FOR SUBLEASE**

**±2,257 SF INDUSTRIAL // SHOWROOM**

# **INTERSTATE BUSINESS PARK**

24335 PRIELIPP RD., SUITE 113 | WILDOMAR, CA



## **PROPERTY FEATURES**

- ±229,410 SF, Four Building Business Park
- Professionally Owned and Managed by Whitaker Facilities Corporation
- Long-Term Ownership with Extensive Local Portfolio, Stable Operating Expenses, and Highly Responsive Property Management
- Outstanding I-15 Freeway Frontage & Visibility
- 160,000 Cars per Day (I-15 & Clinton Keith Rd.)
- Dock High Loading on Buildings B, C & part of D and Ground Level Loading on all Suites
- Upgraded Power (200 – 1,600 Amps)
- Upgraded Offices
- 21' to 27' Warehouse Clear Height
- 180' Truck Court
- M-SC (Manufacturing/ Service Commercial)  
*Click Here to Learn More*
- ESFR Fire Sprinkler System

**SCOTT STEWART**

951.445.4514

sstewart@leetemecula.com

DRE #01342575



**LEE &  
ASSOCIATES**

COMMERCIAL REAL ESTATE SERVICES



No warranty or representation has been made to the accuracy of the foregoing information. Terms of sale or lease and availability are subject to change or withdrawal without notice. Lee & Associates Commercial Real Estate Services, Inc. - Riverside. 25240 Hancock Avenue, Suite 100 - Murrieta, CA 92562 | DRE# 01048055



**AVAILABLE FOR SUBLEASE**

**±2,257 SF INDUSTRIAL // SHOWROOM**

**INTERSTATE BUSINESS PARK**

24335 PRIELIPP RD., SUITE 113 | WILDOMAR, CA



**AVAILABLE FOR SUBLEASE**

**±2,257 SF INDUSTRIAL // SHOWROOM**

**INTERSTATE BUSINESS PARK**

24335 PRIELIPP RD., SUITE 113 | WILDOMAR, CA

**FLOORPLAN**

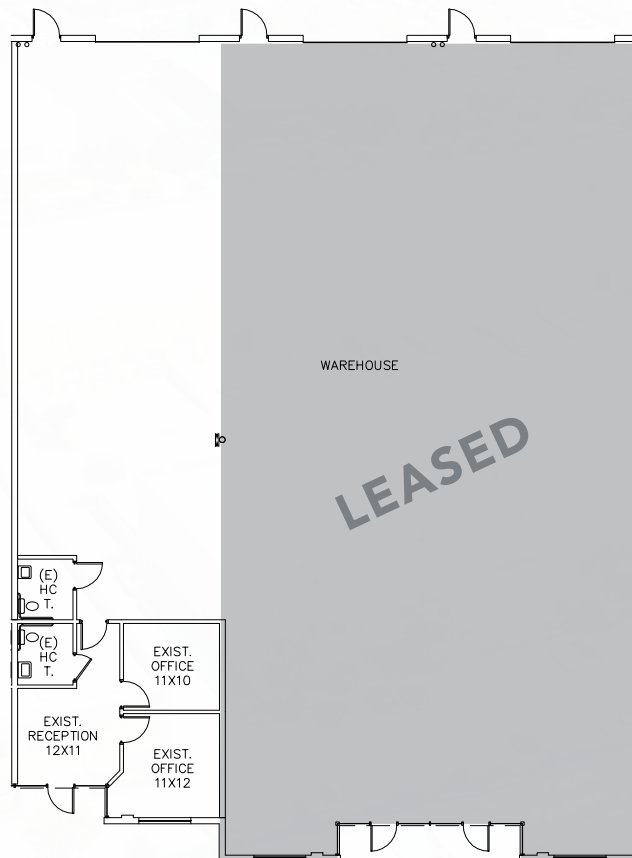

**SCOTT STEWART**  
951.445.4514  
sstewart@leetemecula.com  
DRE #01342575



No warranty or representation has been made to the accuracy of the foregoing information. Terms of sale or lease and availability are subject to change or withdrawal without notice. Lee & Associates Commercial Real Estate Services, Inc. - Riverside. 25240 Hancock Avenue, Suite 100 - Murrieta, CA 92562 | DRE# 01048055