

000 W BARKLEY ROAD
STATESVILLE, NC

±18.64 ACRES

\$350,000

**LAND
FOR
SALE**



Third Creek
Elementary School

PROPERTY HIGHLIGHTS

- Great tract of land for development assemblage opportunity. Adjacent to Third Creek Elementary School. Landlocked parcel, will need additional parcels for access.
- Currently zoned R-20 & RA.
- Utilities-sewer and 8-in water line located at Third Creek Elementary school.
- Approximately 1,700 feet of frontage on I-77 with approximately 2 miles to Interstate access
- Civil engineering review shows approximately 11 Acres developable

DEMOGRAPHICS

	1 Mile	3 Miles	5 Miles
Total Population	1,337	20,012	49,235
Total Households	517	7,875	19,350
AVG HH Income	\$103,107	\$62,393	\$69,046

NAI Piedmont Triad
Commercial Real Estate Services, World Wide

JASON SMITH
BROKER
336.709.6745
jsmith@naipt.com

348 N. Elm Street • Greensboro, NC 27401 • naipt.com

Residential Concept Plan

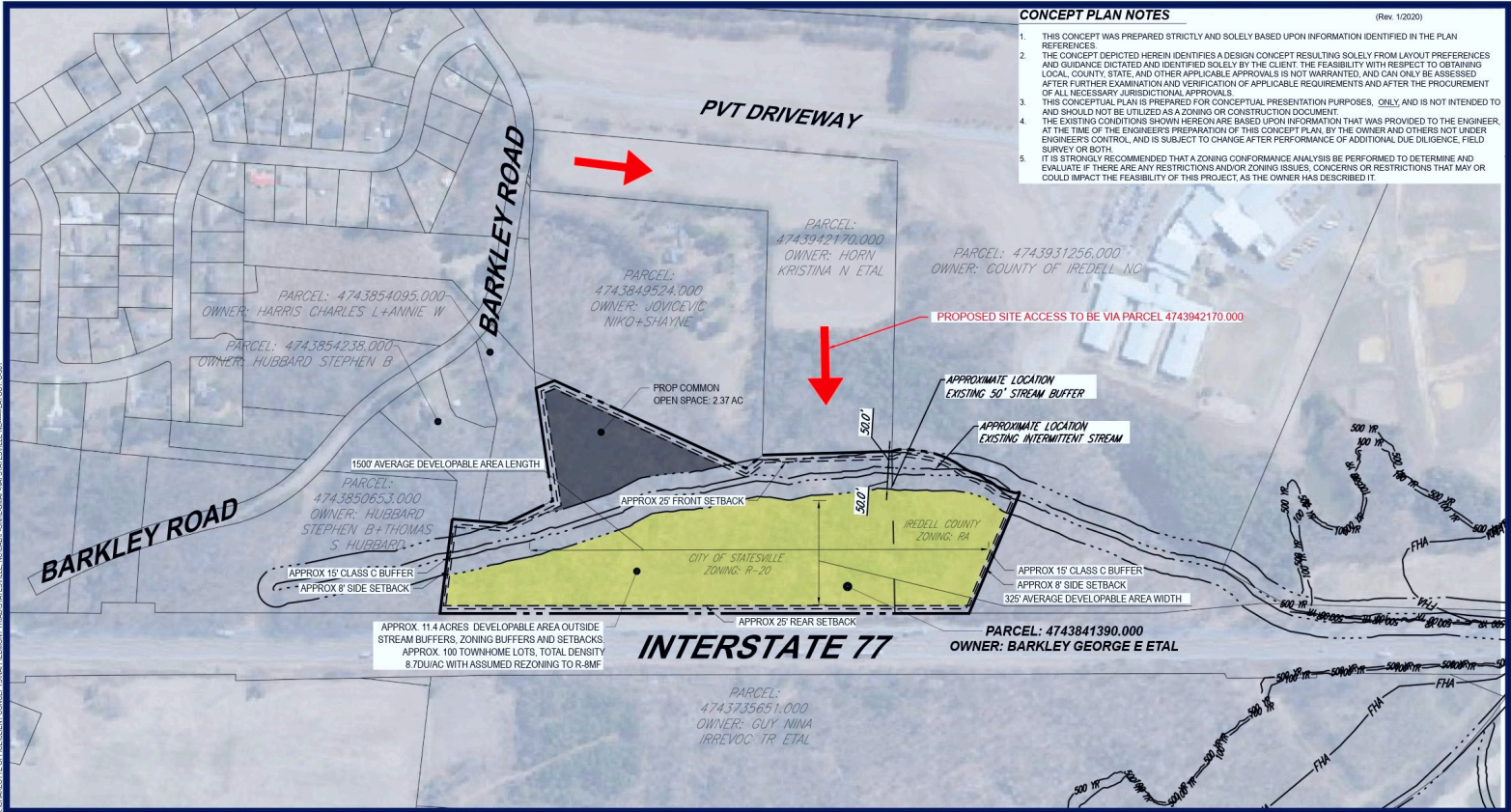

BOHLER
 BOHLER ENGINEERING NC, PLLC
 NC REG. # 1122
 1927 S. TRYON STREET, SUITE 310
 CHARLOTTE, NC 28203 Phone: (980) 272-3400 Fax: (980) 272-3401
 NC@BohlerEng.com

BARKLEY ROAD RESIDENTIAL NAI PIEDMONT TRIAD

STATESVILLE, NC

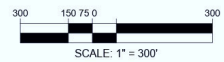

MAR. 17 2026 | MVI Rev. 0

This material may contain content generated with AI assistance and publicly sourced data. NAI Piedmont Triad makes every effort to verify the information but makes no warranties or representations regarding the accuracy, completeness, or reliability of the information. Independent verification of all details is strongly encouraged. Prices, terms, and availability are subject to change without prior notice.

JASON SMITH
 BROKER
 336.709.6745
 jsmith@naipt.com

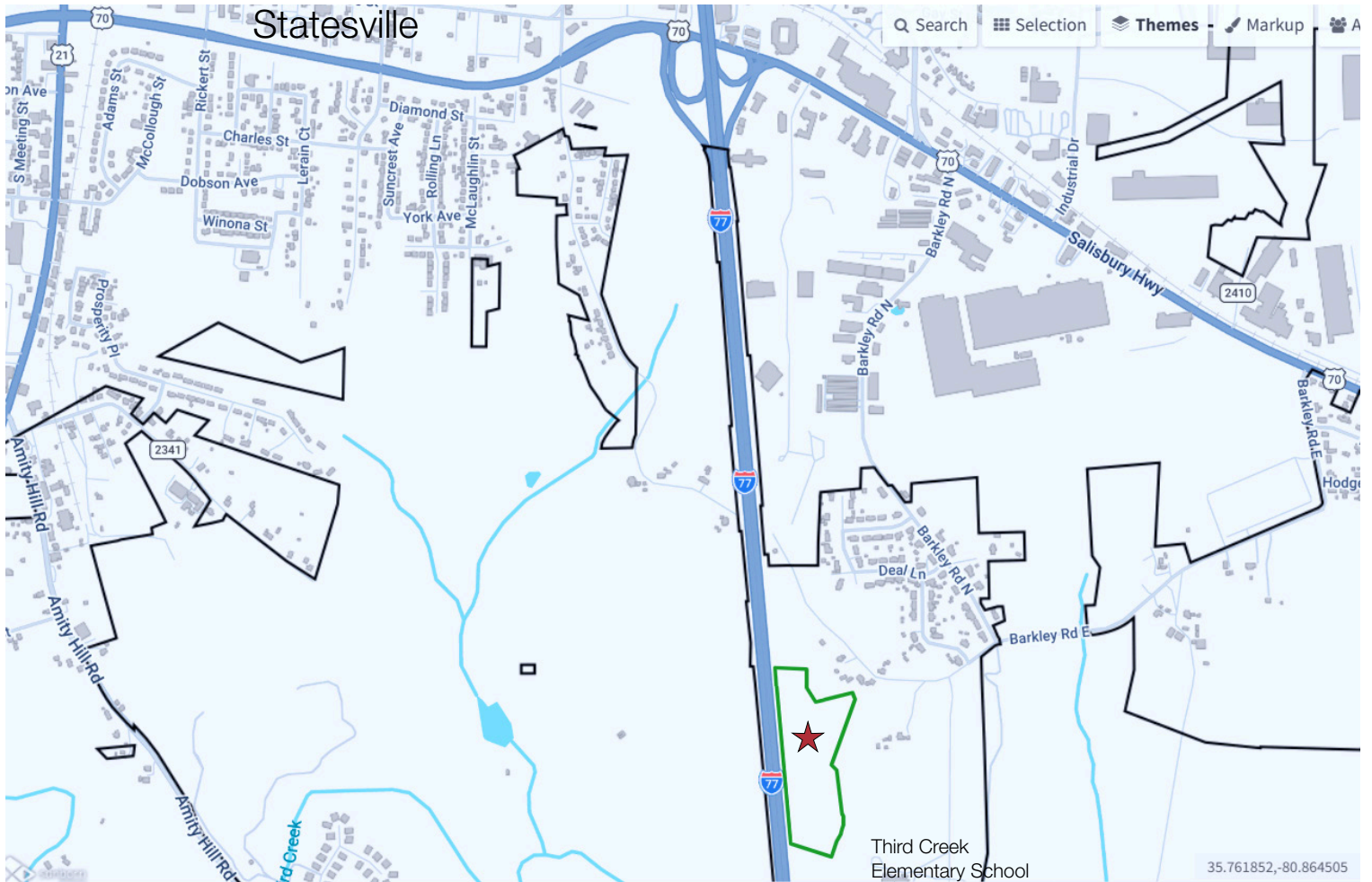

Distances to Points of Interest

Charlotte CBD	40.9 mi
Charlotte Douglas International Airport	45.1 mi
Winston - Salem	44.3 mi
Greensboro	73.7 mi
Salisbury	23.9 mi

This material may contain content generated with AI assistance and publicly sourced data. NAI Piedmont Triad makes every effort to verify the information but makes no warranties or representations regarding the accuracy, completeness, or reliability of the information. Independent verification of all details is strongly encouraged. Prices, terms, and availability are subject to change without prior notice.

JASON SMITH
 BROKER
 336.709.6745
 jsmith@naipt.com

NAI Piedmont Triad

**BROKERAGE
DEVELOPMENT
INVESTMENTS**

FOR MORE INFORMATION, CONTACT:



JASON SMITH
BROKER
336.398.3469
jsmith@naipt.com