



## THE PROPERTY

Property is located in a high demographic area with over \$100,000 income in less than a mile and has a high traffic count of over \$40,000 per day!

**5529 LOUETTA RD.  
SUITE D**

**SPRING, TX 77379**

## SUMMARY

Monthly Rent: \$775-1000  
 BOMA Square Feet: 205  
 Minimum of 1 Year Lease  
 Full Service Gross

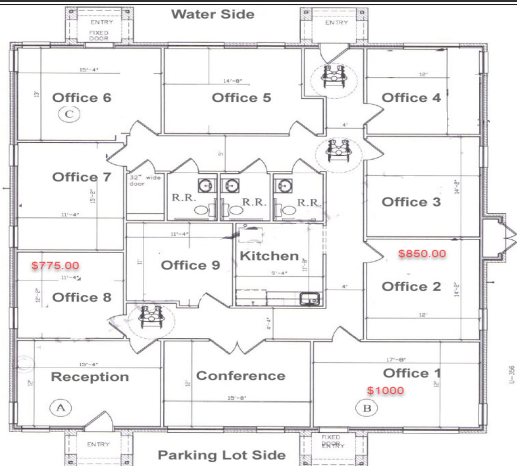

FOR MORE INFORMATION, CONTACT AMYTHYST  
 MANNING AMYTHYST@AIMCB.COM (713) 248-1995





## OFFICE SPACE FOR LEASE

### FEATURES

- Free parking
- First floor
- Shared reception/waiting area
- Conference area
- Kitchen/ Break room
- Coffee Bar
- Free Ethernet Internet and phone service available
- Professional Atmosphere
- Executive Office Space



FOR MORE INFORMATION, CONTACT AMYHYST  
MANNING AMYHYST@AIMCB.COM (713) 248-1995

