



**FULL BUILDING CREATIVE OFFICE SUBLEASE**

SAN FRANCISCO, CA 94107

**850 Folsom St.**

**Available Now | 6,659 RSF**  
Fully Furnished w/ Large Skylights  
LED: December 31, 2030.

# SUMMARY

| 850 Folsom St.

**BUILDING ADDRESS** | 850 Folsom Street

**SQUARE FT** | +/- 6,659 RSF

**PRICE** | Inquire with Broker

**SPACE TYPE** | Creative Office

**AVAILABLE** | Immediately



**95**

Walk Score



**100**

Rider Score



**90**

Bike Score

## EFFICIENT LAYOUT

Open Area plus 6 Meeting Rooms of various sizes

## BEAUTIFUL BUILDING ATTRIBUTES

High Exposed Ceilings w/ Polished Concrete Floors

## PREMIER YERBA BUENA LOCATION

Steps to Moscone Center

## MODERN INTERIOR AMENITIES

Conference Rooms, Phone Booths, Kitchenette

## NATURAL LIGHT FEATURES

Multiple Large Skylights

## PUBLIC TRANSPORTATION

Immediate Access to BART, Muni, and CalTrain

## PLUG & PLAY OFFICE

Fully furnished with 30+ sit/stand desks

# HIGHLIGHTS

## | 850 Folsom St.

### PROPERTY DETAILS

- Ground Floor Space with Large Mezzanine
- Polished Concrete Throughout the Space
- Newly built-out kitchenette with stainless steel appliances
- 4 ADA restrooms (including one shower)
- 1 Glass-Enclosed large room
- 1 Glass-Enclosed medium room
- Second entry to ground floor via 353 Clementina
- Large Skylights Providing Abundant Natural Light



# FLOOR PLAN

| 850 Folsom St.

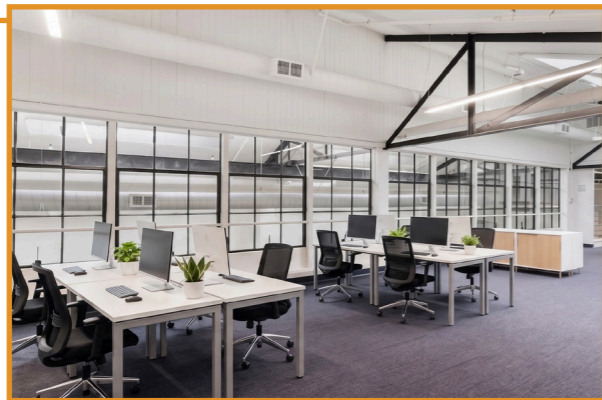
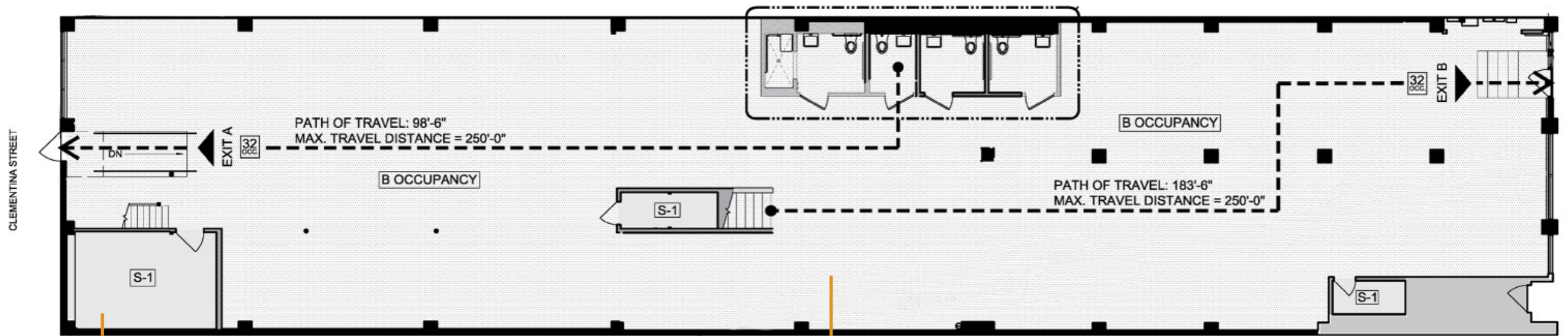

**GALLERY**  
| 850 Folsom St.



# GALLERY

| 850 Folsom St.

 **CALCO**  
COMMERCIAL, INC.



# GALLERY

| 850 Folsom St.

 **CALCO**  
COMMERCIAL, INC.



# LOCATION OVERVIEW

| 850 Folsom St.

Prime location in the heart of San Francisco's SOMA district — surrounded by leading tech offices, creative hubs, dining, and nightlife, with excellent access to public transit and major highways.



**03 MIN** to Powell Street  
BART / MUNI

**05 MIN** to Westfield San  
Francisco Centre

**06 MIN** to Yerba Buena



**03 MIN** to Union Square

**05 MIN** to Financial District

**08 MIN** to Mission District



**02 MIN** to I-80 On-Ramp

**04 MIN** to 101 / 280 Access

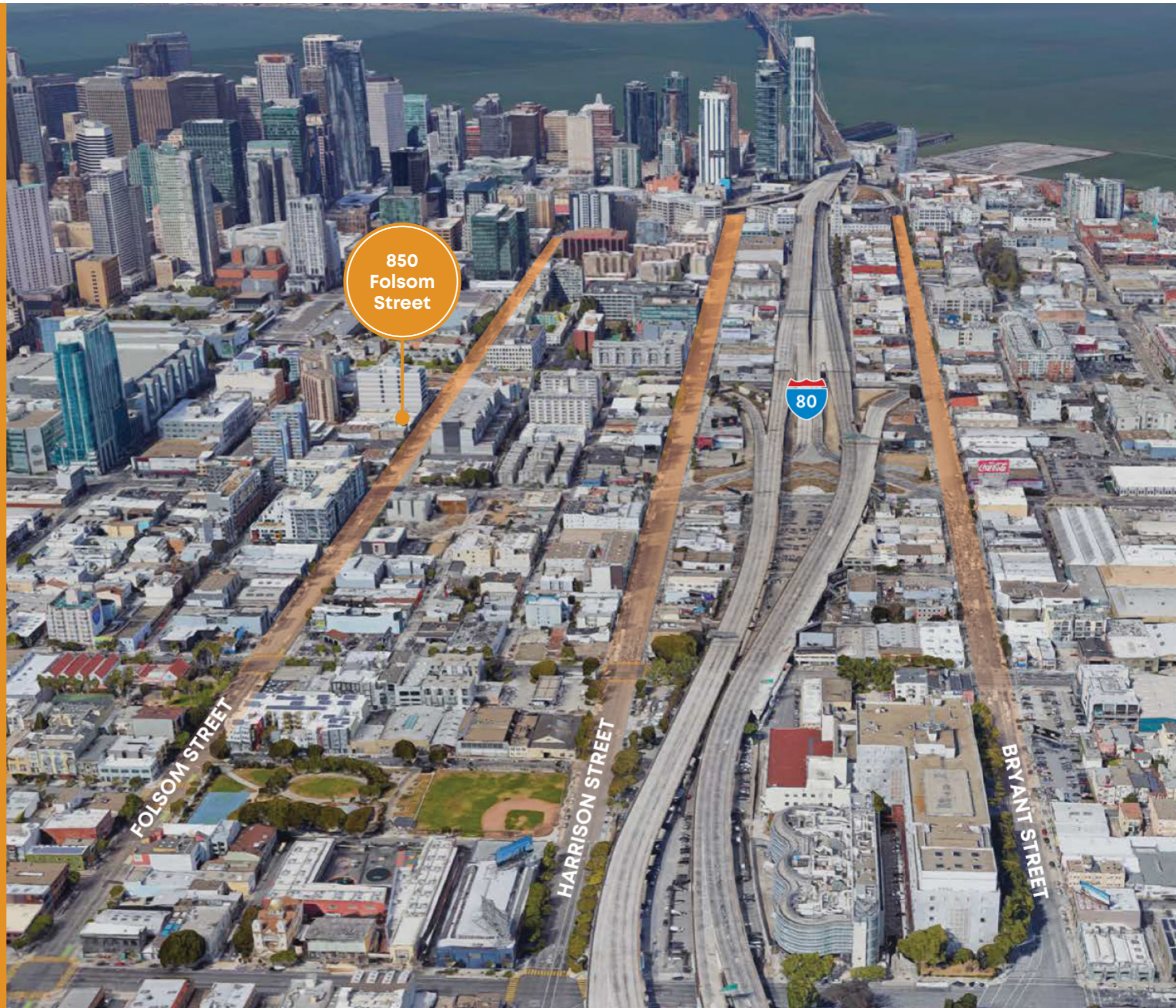

# NEARBY AMENITIES

| 850 Folsom St.

- 1 Deli Board
- 2 Extreme Pizza
- 3 Sightglass Coffee
- 4 Social Cafe
- 5 AyDea
- 6 Pho de Nguyen
- 7 City's Choice Cafe
- 8 All Star Donuts
- 9 Dragon Horse
- 10 Mr. East Kitchen
- 11 Tempest Bar & Box Kitchen
- 12 Bini's Kitchen
- 13 Kiss My Seoul
- 14 Dinosaur Sandwiches
- 15 Basil Thai
- 16 San Francisco Pole and Dance
- 17 Enterprise Brewing Co.
- 18 Whole Foods Market
- 19 Marlowe
- 20 Tin
- 21 The Chieftain Irish Pub
- 22 Thriller Social Club
- 23 Taksim
- 24 Brickhouse Cafe & Bar
- 25 Black Hammer Brewing Company
- 26 Que Viet
- 27 Delah Coffee

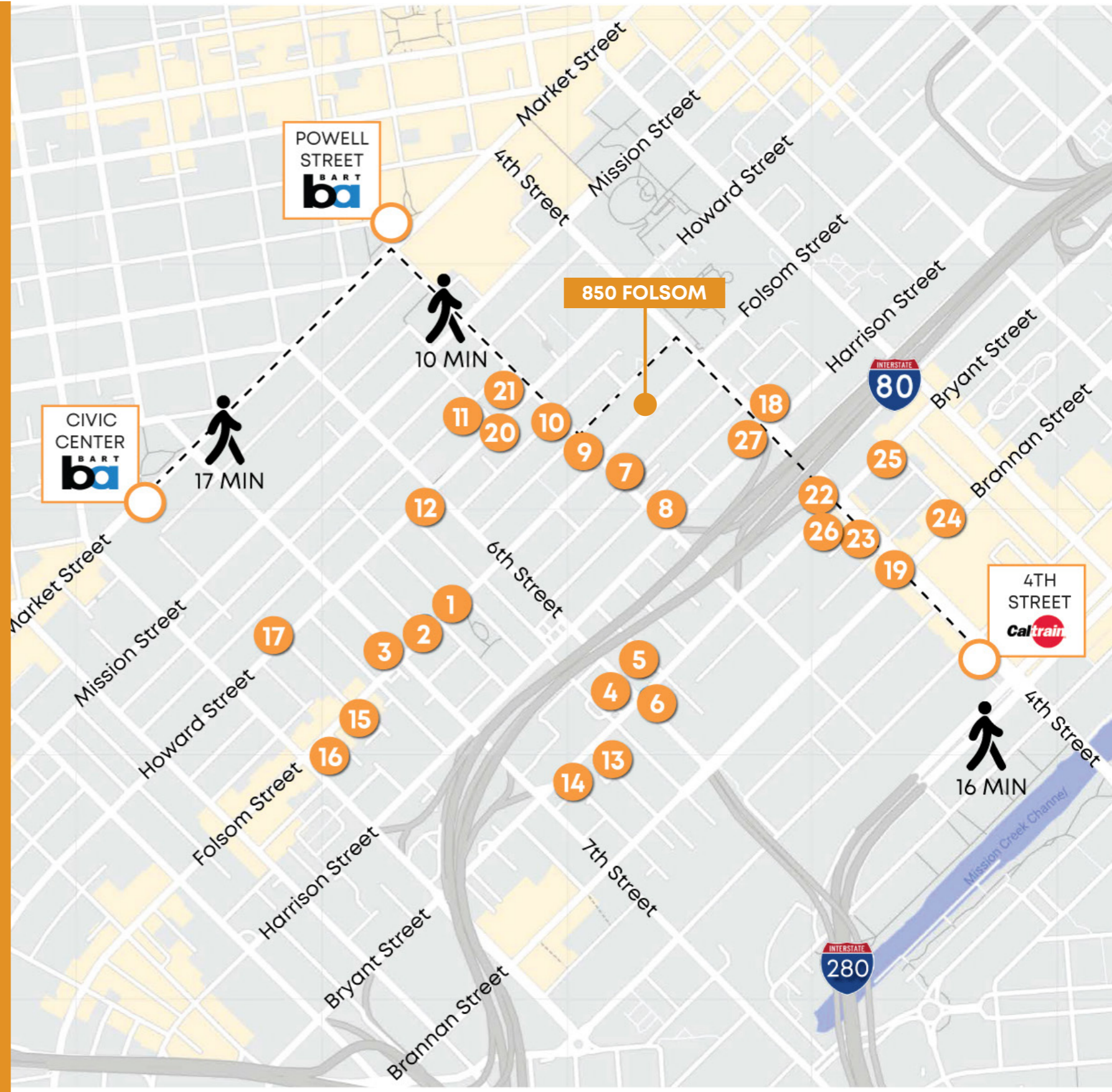



**CHARLIE CUTLER**

Partner  
Email: [charlie@calcosf.com](mailto:charlie@calcosf.com)  
Cell: 415.850.4935  
DRE # 02026787

**CHARLES WILLIAMS**

Associate  
Email: [charles@calco-sf.com](mailto:charles@calco-sf.com)  
Cell: 916.757.3154  
DRE #02244143

**PIONEERING REAL ESTATE SOLUTIONS WITH PROVEN EXPERTISE**

Calco Commercial, founded in 2011 by Scott Mason, brings over 35 years of experience and 2,500+ transactions, totaling over \$2.2 billion in sales and leases. Specializing in leasing and sales of commercial real estate in the San Francisco Bay Area and nationwide, we consistently rank as a top-producing firm. With deep knowledge of the Bay Area market, our team offers clients over three decades of expertise and exceptional customer service, providing the tools and guidance to navigate the ever-changing commercial real estate landscape.