

AREA15

**DISTRICT**

***AREA15'S 747 PLAZA  
10,000 SF RESTAURANT SPACE  
PRIVATE TERRACE WITH STRIP VIEWS***

# THE POWER OF PROXIMITY

Crafting an entertainment ecosystem powered by iconic brands.



A brand-new, permanent horror experience that anchors The District.

## MUSEUM OF ICE CREAM

An interactive art installation that offers immersive experiences and whimsical exhibits celebrating the joy and nostalgia of ice cream.



Combining immersive storytelling with space exploration, *Interstellar Arc* will take guests on an epic 26th-century deep space mission.



A high-tech urban golf experience featuring simulators, access to top pros, and leagues for all levels.



An augmented reality experience averaging one million annual visitors.



An immersive theatre, cinematic environment, and interactive journey that transcends reality.



An immersive indoor skydiving adventure using a vertical wind tunnel that simulates the free-fall sensation up to one minute per flight—without jumping from a plane.



A transportive hub combining 4k interactive projection, 360° audio, in-floor vibrations, and scent systems to teleport visitors.



# A UNIQUE RESTAURANT SPACE

UP TO 10,000 SF AND 1,800 OUTDOOR SF

A rare restaurant site with outdoor seating, panoramic Las Vegas Strip views, and a front-row position next to AREA15's Burning Man 747.



# ***STUNNING LAS VEGAS STRIP VIEWS***



***VIEW FROM 747 EXPERIENCE PLAZA***



***VIEW FROM SECOND FLOOR BALCONY***



**BUILDING 2**

**2ND FLOOR  
BALCONY**

# FLOORPLAN



CLICK OR SCAN  
INTERACTIVE VIRTUAL TOUR

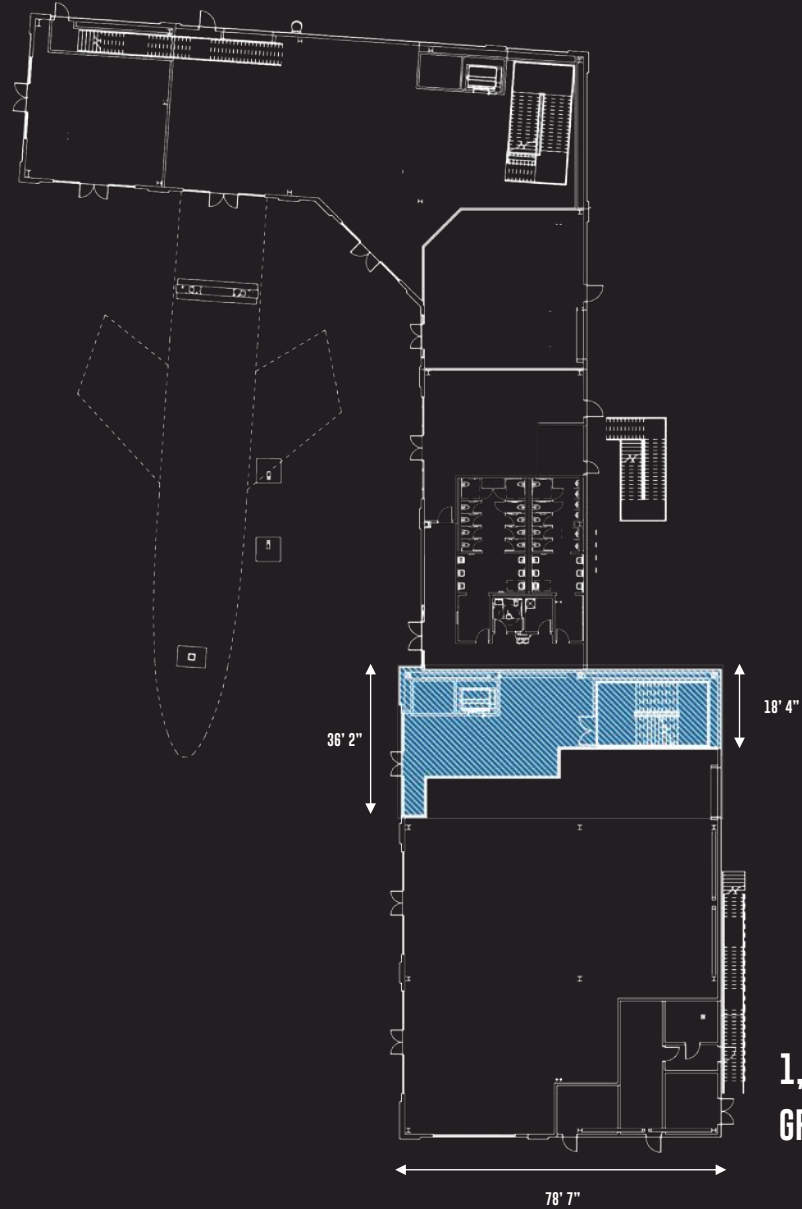

1,956 SF  
GROUND FLOOR



# FLOORPLAN



CLICK OR SCAN  
INTERACTIVE VIRTUAL TOUR

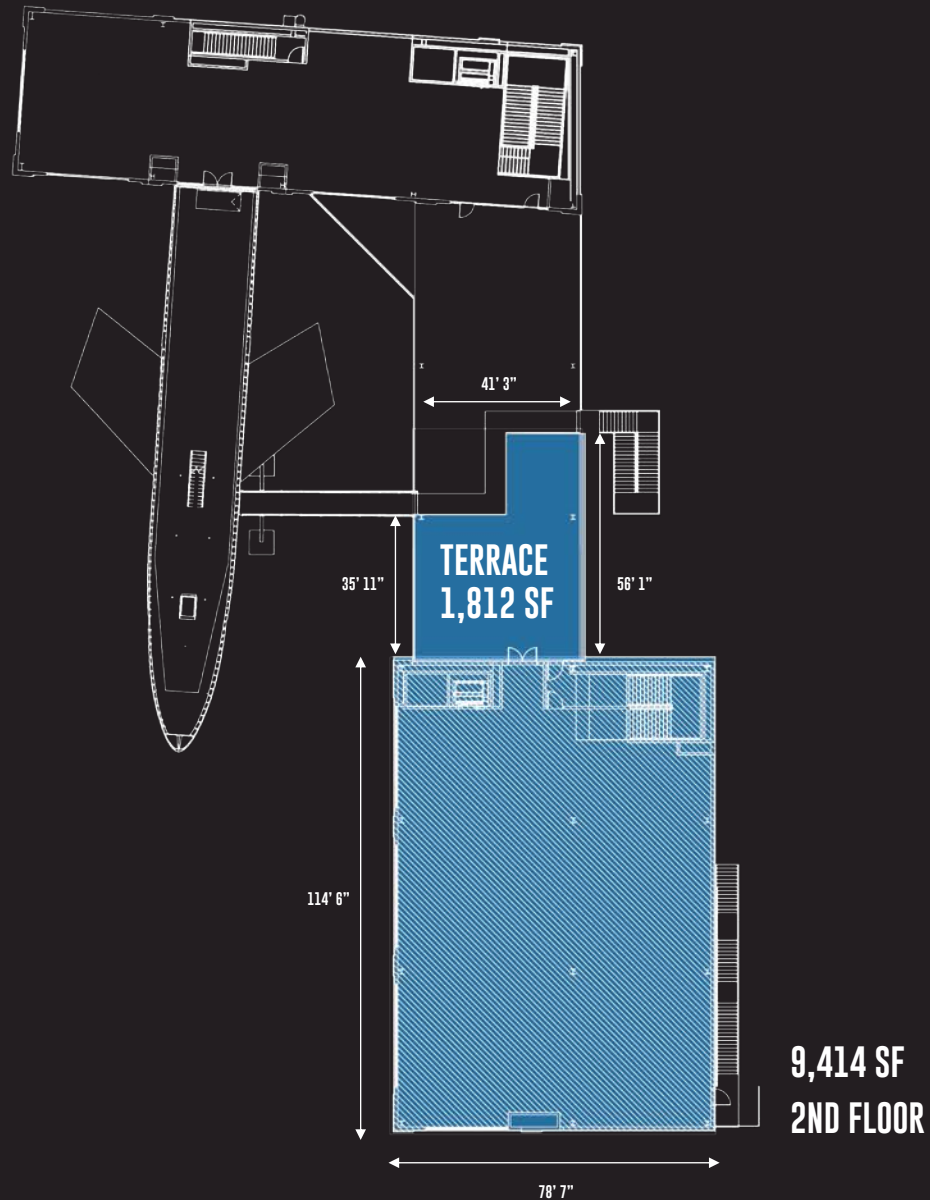



**BRIAN SORRENTINO, CCIM**

702.550.4932  
brian@roicre.com

**CLARK BRIFFEL**

212.940.6821  
cbriffel@fisherbrothers.com

**ANGELICA CLEMMER, CCIM**

702.550.4937  
angelica@roicre.com

**MYLES GROSSMAN**

212.940.6890  
mgrossman@fisherbrothers.com

