

# 10,080 SF

**170 Penney Road, Suite I**  
**Forest Park, GA 30297**

Prologis Southfield

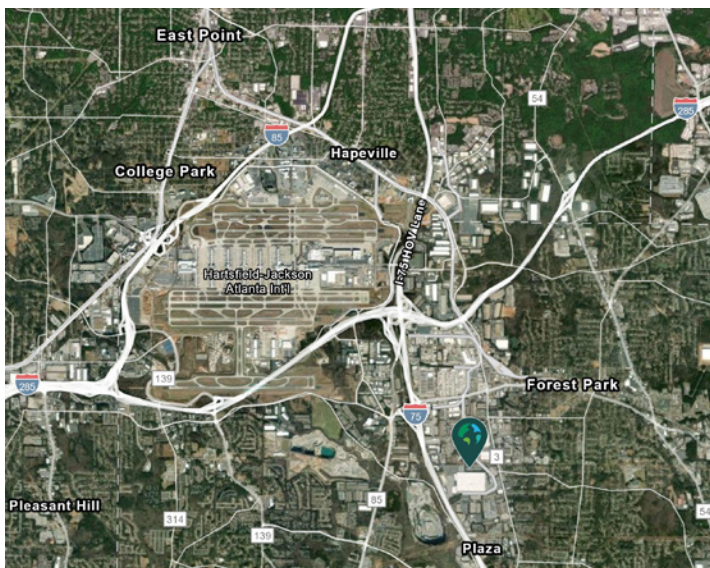

- Approx. 0.8 miles from I-75
- Approx. 2.6 miles from I-285
- Approx. 4.9 miles from Hartsfield-Jackson Atlanta International Airport
- Approx. 8 miles from I-85
- Tax Incentives: Clayton County is a designated Tier 1 county, \$3,500 per qualified job tax credit for up to 5 years

## Property Features

Available Space	10,080 SF
Office SF	2,898 SF
Warehouse SF	7,182 SF
Clear Height	±24'-4" minimum
Column Spacing	40'-0" x 50'-0"
Dock Doors	Three (3)
Drive-In Doors	Two (2)
Car Parking Spaces	Forty (40)
Electrical Service	120/208 V, 100 A
Building Depth	120'-0"
Lighting	LED in office and warehouse



Unlock the full potential of your warehouse with one strategic, single-source partner.

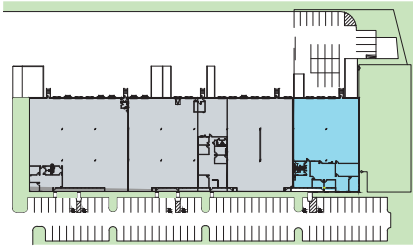

**KEY PLAN**

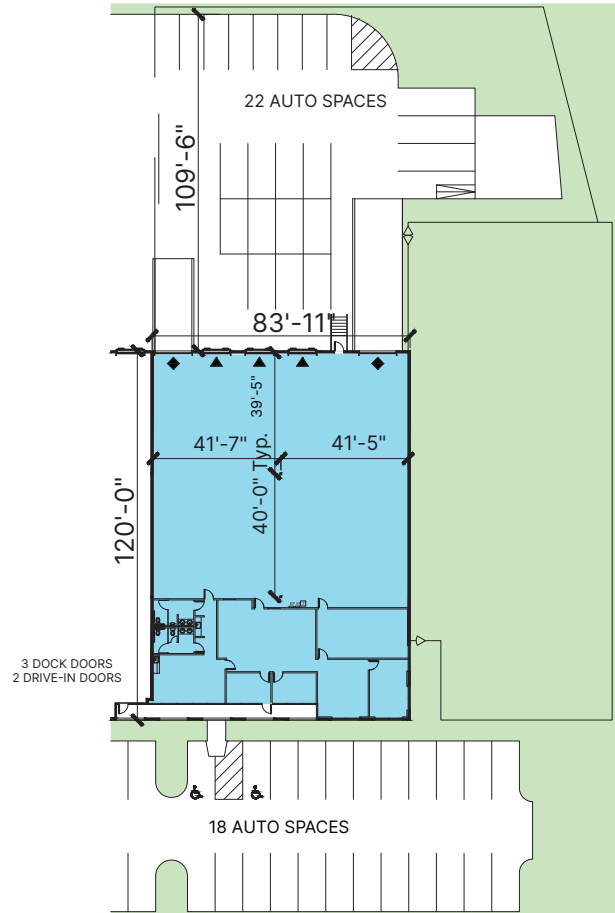

**SUITE I**  
 10,080 SF AVAILABLE  
 7,182 SF WAREHOUSE  
 2,898 SF OFFICE

**LEGEND:**

- ▲ DOCK DOOR
- ▲ DOCK DOOR W/LEVELER
- ◆ DRIVE-IN DOOR
- ▲ ON-GRADE DOOR
- G EDGE OF DOCK LEVELER
- ▭ PIT LEVELER
- LAND
- LEASED AREA
- VACANT AREA



**Seefried Properties**

**Joseph Kriss**

josephk@seefriedproperties.com

ph +1 678 362 4641

**Seefried Properties**

**Tripp Ausband**

tausband@seefriedproperties.com

ph +1 770 825 3391

**Prologis**

**Cassie Hanavich**

chanavich@prologis.com

ph +1 404 760 7256