

LEASE | OFFICE WAREHOUSE

Riverview Business Center

State Street & Fillmore Avenue East, St. Paul, MN



Riverview Business Center is a two-building complex located south of the Mississippi River in the West Side Flats neighborhood of Saint Paul, Minnesota. Currently, there is anywhere from 5,000 square feet to 25,000 square feet available for lease.

Property Features

- 5,000 - 25,000 SF with dock and drive-in doors
- AC in 20,000 SF of the warehouse area
- Located directly off Highway 52 and near Interstate 94, just south of downtown Saint Paul
- 14' clear height
- 40' x 31' column spacing



Tax & CAM \$5.08 SF (2026) - Fillmore building

Tax & CAM \$3.63 SF (2026) - State Street Building



Coax available (Comcast)

Contact Us

ERIC DUEHOLM

Partner



651.621.2550

eric@terracegroupllc.com

BEN BRUNO

Brokerage Services



651.621.2563

ben@terracegroupllc.com

TONY ROSSATO

Brokerage Services



651.621.2507

ben@terracegroupllc.com

Full Property Information at:
riverviewlease.com

LEASE | OFFICE WAREHOUSE
Riverview Business Center
State Street & Fillmore Avenue East, St. Paul, MN



Area Map



ERIC DUEHOLM
Partner
651.621.2550
eric@terracegrouppllc.com

BEN BRUNO
Brokerage Services
651.621.2563
ben@terracegrouppllc.com

TONY ROSSATO
Brokerage Services
651.621.2507
tony@terracegrouppllc.com

Full Property Information at:
riverviewlease.com

LEASE | OFFICE WAREHOUSE
Riverview Business Center
State Street & Fillmore Avenue East, St. Paul, MN



Fillmore Avenue Building



ERIC DUEHOLM
Partner

651.621.2550
eric@terracegrouppllc.com

BEN BRUNO
Brokerage Services

651.621.2563
ben@terracegrouppllc.com

TONY ROSSATO
Brokerage Services

651.621.2507
tony@terracegrouppllc.com

Full Property Information at:
riverviewlease.com

LEASE | OFFICE WAREHOUSE
Riverview Business Center
State Street & Fillmore Avenue East, St. Paul, MN



State Street Building



ERIC DUEHOLM
Partner
651.621.2550
eric@terracegrouppllc.com

BEN BRUNO
Brokerage Services
651.621.2563
ben@terracegrouppllc.com

TONY ROSSATO
Brokerage Services
651.621.2507
tony@terracegrouppllc.com

Full Property Information at:
riverviewlease.com

Available Suites - State Street

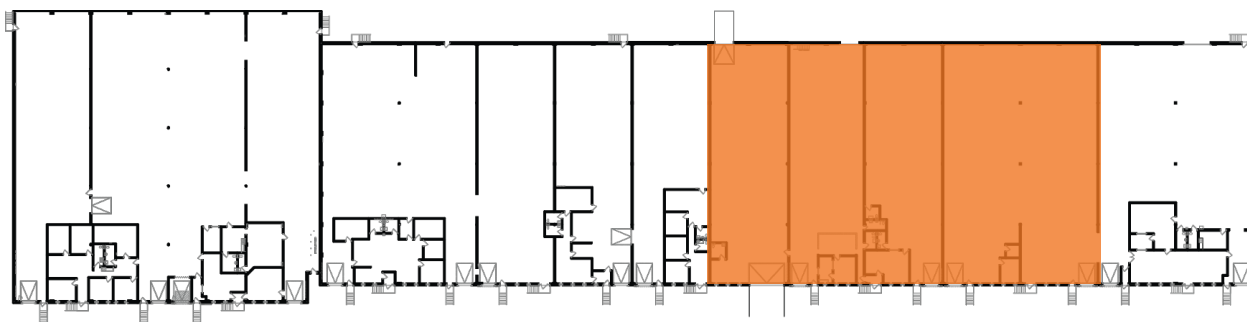
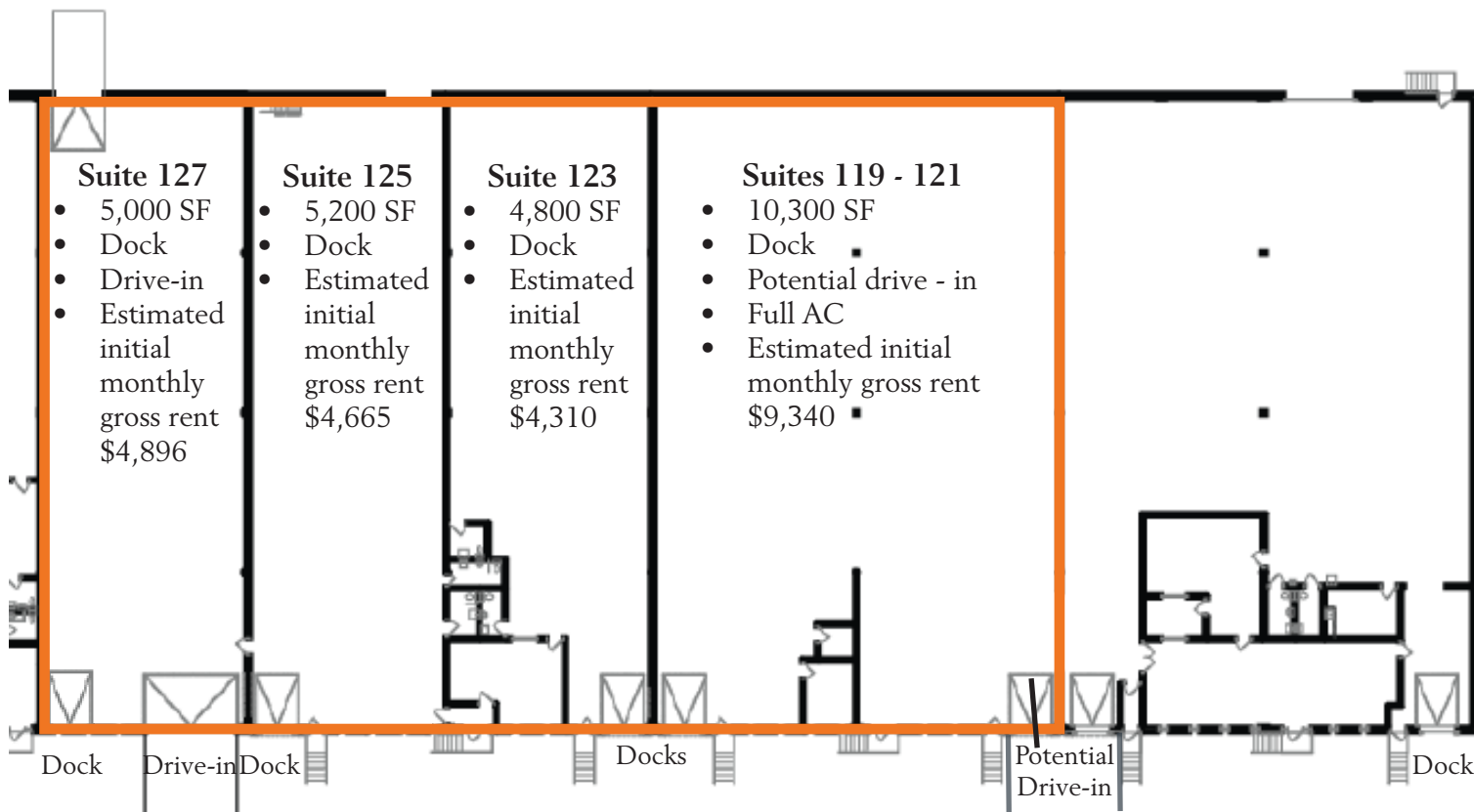

Information is deemed reliable; however, no warranty or representation is made as to its accuracy or completeness. Property is subject to price change, prior sale or lease, and withdrawal from the market, all without notice.

ERIC DUEHOLM
Partner

651.621.2550

eric@terracegrouppllc.com

BEN BRUNO
Brokerage Services

651.621.2563

ben@terracegrouppllc.com

TONY ROSSATO
Brokerage Services

651.621.2507

tony@terracegrouppllc.com

Full Property Information at:
riverviewlease.com