



FOR LEASE

2661 Alvarado Street
San Leandro

MULTI-TENANT INDUSTRIAL PARK – 4,000 – 8,000 SF UNITS

Dan Dowd, SIOR

dan.dowd@nmrk.com

510-300-0223

CA RE LIC #01432679

Spencer Jenkins

spencer.jenkins@nmrk.com

510-300-0350

CA RE LIC #02029699

Conor Deal

conor.deal@nmrk.com

510-786-5283

CA RE LIC #01718911

NEWMARK

The information contained herein has been obtained from sources deemed reliable but has not been verified and no guarantee, warranty or representation, either express or implied, is made with respect to such information. Terms of sale or lease and availability are subject to change or withdrawal without notice.

Floorplan

Unit	Size	Doors	Asking Price
18	4,000	1	\$1.25 psf IG
48	7,989	1	\$1.15 psf IG

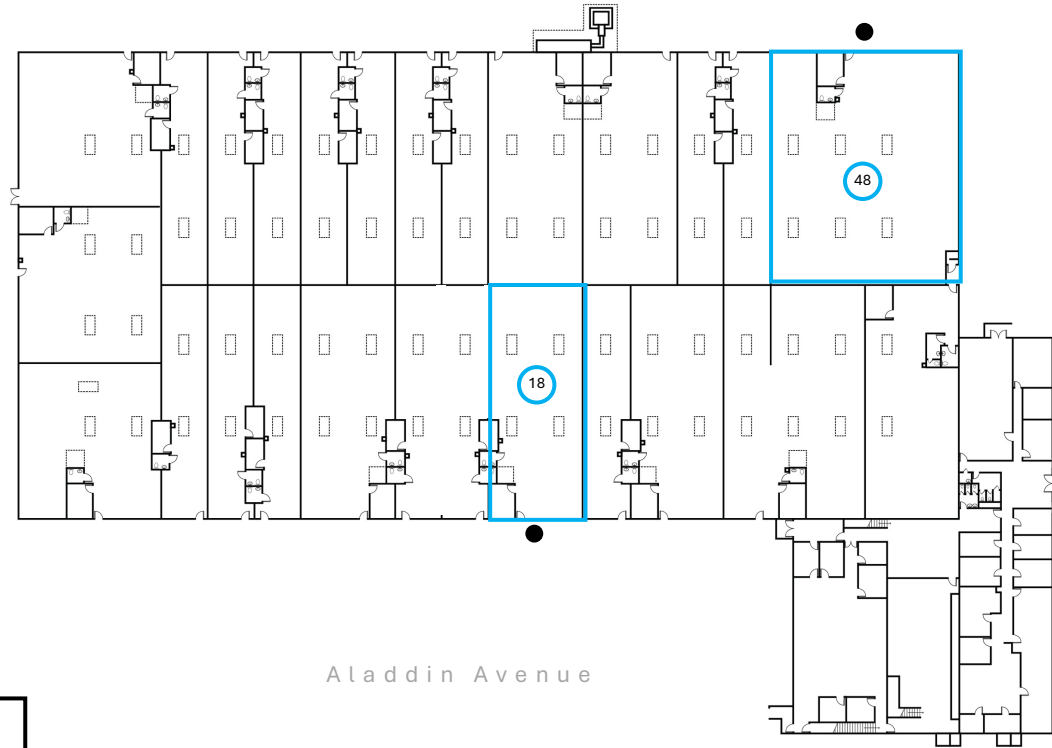

NEWMARK

Dan Dowd, SIOR
dan.dowd@nrmk.com
510-300-0223
CA RE LIC #01432679

Spencer Jenkins
spencer.jenkins@nrmk.com
510-300-0350
CA RE LIC #02029699

Conor Deal
Conor.deal@nrmk.com
510-786-5283
CA RE LIC #01718911