

5651 Mansfield Way

Rare Class “A” Industrial Condominium For Lease



Property Details

APN	6332-023-004	Sprinklers	Yes (ESFR)
Building Area	16,885 Square Feet	Fenced Yard	Yes
Land Area	0.69 Acres	Parking	24 Spaces
Clear Height	24'	Construction Type:	Concrete Tilt Up
Power	800A/480V/3P 4 Wire	Year Built	2003
Docks	Three (3)	Type	Industrial Condominium
Drive-Ins	One (1)	Office	2,703 Square Feet

Site Plan

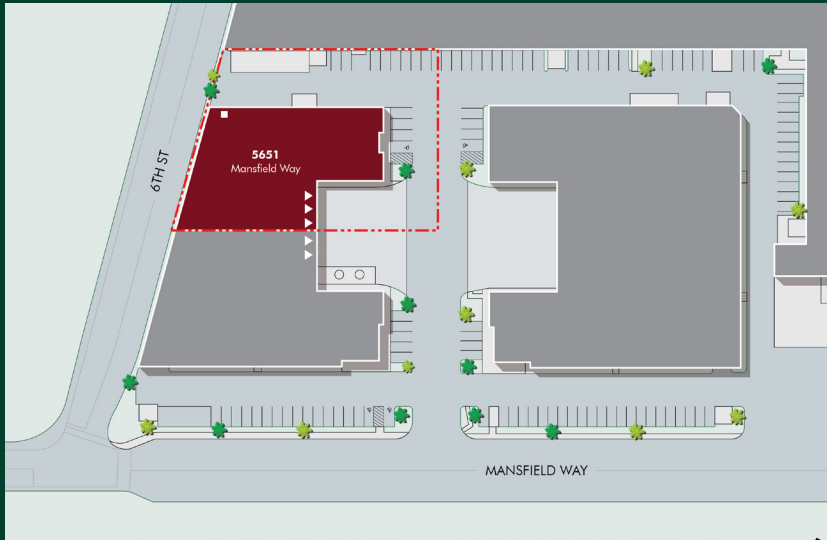

Regional Map

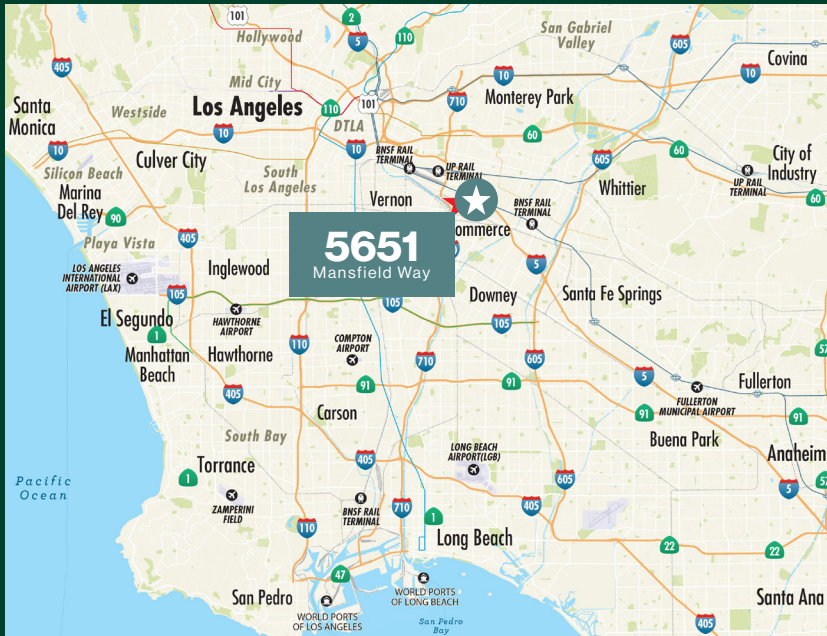

Contact Us

John Hillman
First Vice President
+1 213 613 3755
john.hillman@cbre.com
Lic. 01223571

Jason Martinez
Associate
+1 323 804 5668
jason.martinez@cbre.com
Lic. 02199658

CBRE DTLA
400 S. Hope Street, 25th Floor
Los Angeles, CA 90071

© 2026 CBRE, Inc. All rights reserved. This information has been obtained from sources believed reliable, but has not been verified for accuracy or completeness. You should conduct a careful, independent investigation of the property and verify all information. Any reliance on this information is solely at your own risk. CBRE and the CBRE logo are service marks of CBRE, Inc. All other marks displayed on this document are the property of their respective owners, and the use of such logos does not imply any affiliation with or endorsement of CBRE. Photos herein are the property of their respective owners. Use of these images without the express written consent of the owner is prohibited.