



Space Profile for

Unit: #8801-4

Area: 1100 sq ft

Address

8801 Centre Park Drive, Suite 4  
Columbia, MD 21045



4300 West Cypress St., Suite 160  
Tampa, FL, 33607



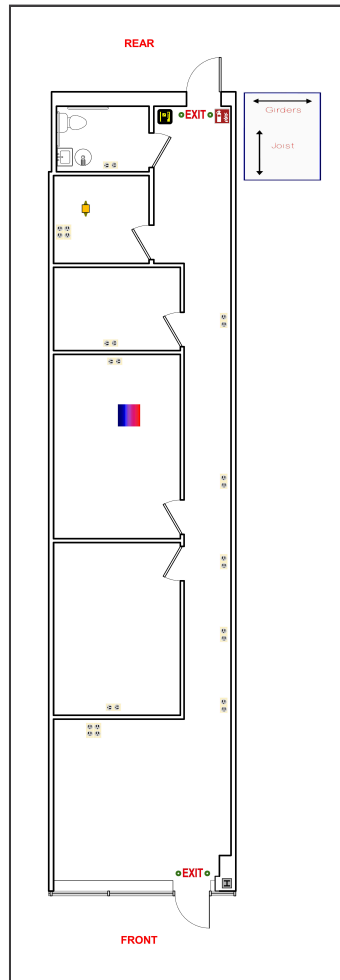

# Legend

	Tenant Water Meter		Air Handler		Rectangular Column		Disconnect
	Sub Water Meter		HVAC Unit		Appliance Outlet		Freezer
	House Water Meter		Blank Air Handler		Outlet		Can Light
	Blank Water Meter		Blank HVAC Unit		Service Panel		Recessed Light
	Tenant Gas Meter		Vertical Fire Riser		Water Heater		Ceiling Fan w/ Light
	Sub Gas Meter		Horizontal Fire Riser		RJ45		Ceiling Fan
	House Gas Meter		Fire Sprinkler		Backflow Preventer		Diffuser
	Blank Gas Meter		Fire Alarm Pull		Water Fountain		Air Vent
	Tenant Electric Meter		Fire Alarm		Grease Trap		Emergency Light
	Sub Electric Meter		Fire Extinguisher		Step Down Transformer		4 Bulb Fluorescent
	House Electric Meter		Thermostat		Floor Drain		2 Bulb Fluorescent
	Blank Electric Meter		Fire Alarm Control Panel		Tankless Water Heater		1 Bulb Fluorescent

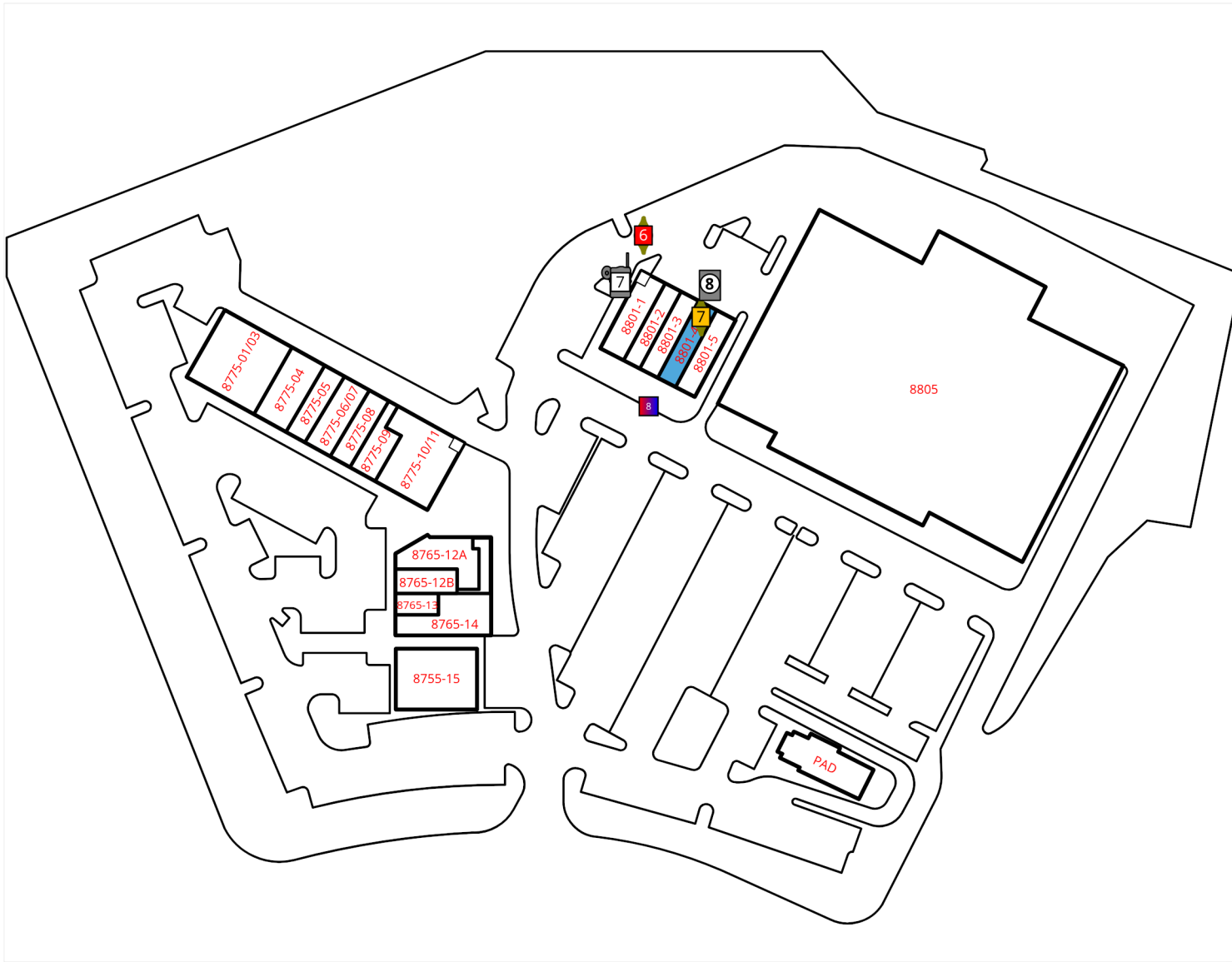

## Space Overview

Overview	Actual Square Footage	Measured Depth of Space
	1100 SQFT	70' 0"

Thickness	Front Wall	Rear Wall	Left Wall	Right Wall
	0' 5"	1' 3"	0' 5"	0' 5"

Flooring	Concrete	Carpet	Tile	Other	Unit	Total
		953.27 SQFT	45.93 SQFT		1100 SQFT	999.2 SQFT

Ceiling Information	Height From Floor To Ceiling	Height From Floor To Bottom Of Deck	Height From Floor To Bottom Of Joist	Height From Floor To Bottom Of Girder
	Front: 9' 11" Back: 9' 11"	Front: 19' 8" Back: 18' 8"	Front: 16' 4" Back: 15' 4"	

Ceiling Information Cont.	Clear Ceiling Height
	9' 9"

## Mechanical

HVAC	Reference	Manufacturer	Model	Serial	Tonnage	Year	Notes
	8	RHEEM	RKPN-A060CK13E	F431701763	5	2017	

Not Present	Assets Not Present
	Air Handler

## Electric

Disconnect	Reference	Amps	Location	UL Number	Manufacturer	Handle or Breaker	Notes
	1	200	Rear Exterior	Not Listed	General Electric	Handle	

Electric Meter	Reference	Meter #	Location	Amps	Notes
	8	G159735429	Rear Exterior		

Not Present	Assets Not Present
	Step-Down Transformer

Service Panel	Reference	Amps	Service Type	Panel Type	Panel UL Number	Manufacturer	Location	Number of Circuit Breakers	Notes
	1	225	120/208	A Series Panelboard	HB 019770	General Electric	Rear Wall		

*\*IDPlans does not provide an Ampacity Report\**

## Plumbing

Not Present	Assets Not Present
	Water Fountains
	Backflows

Water Heater	Reference	Manufacturer	Model	Serial	Gallons	Tank	Water Line (in)	Location	Notes
	1	State Industries	P661OMSK	K03406187	6	Tank	3/4"	Restroom Ceiling	

Water Meter	Reference	Meter #	Location	Meter Size	Meter Type	Notes
	6	43527147	Sprinkler Room	2 inch	House	Water co uses transponder #84418156 in their system as meter #. Would not confirm name on account. Other #s - 18886438
	7	1281041	Ceiling	5/8 inch	Sub	

## Waste

Not Present	Assets Not Present
	Grease Trap
	Grease Container

Fire

Fire Extinguisher	Number of Fire Extinguishers	Notes
	1	

Not Present	Assets Not Present
	Fire Alarm Control Panel

Sprinkler Heads	Sprinkler Type	Sprinkler Heads Present	Sprinklers Located in Space	Riser Located in Space	Additional Information
			Yes	No	

## Gas

Gas Meter	Reference	Meter #	Location	Size	Notes
	7	100106474	Left Exterior	1 1/2 inch	Utility would not confirm name on account. ***Correct gas meter#100106474 for Unit***

Room

Restroom	Unit	Description
	Restroom 1	