

THE WALLER EXCHANGE

O
F
F
I
C
E
S
P
A
C
E



NOW LEASING

SUITE 130

2313 MAIN ST. WALLER, TX

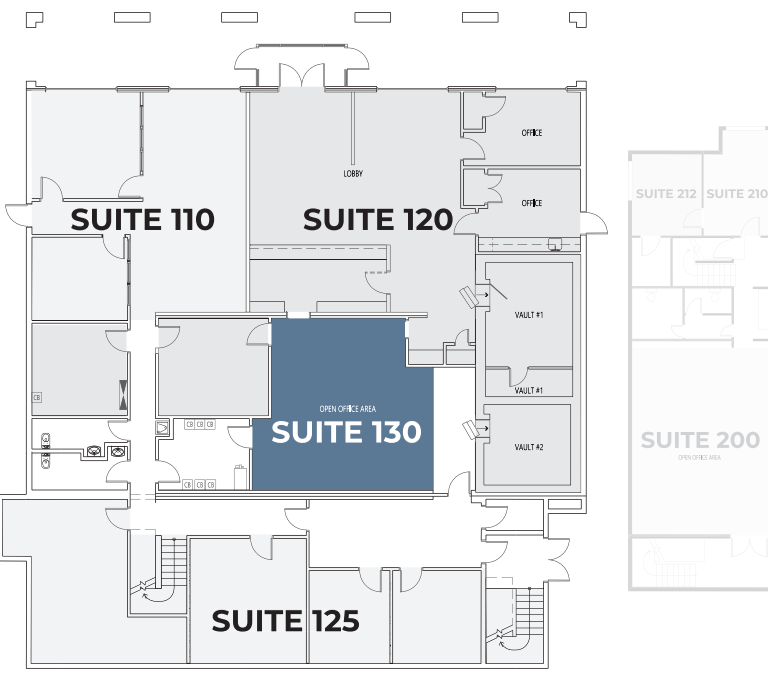
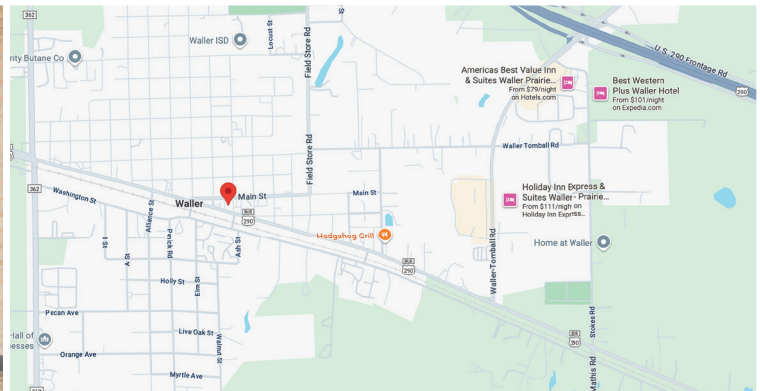

LEASE INFORMATION

TYPE: NNN TERM: 1-5 YEARS

DISCLAIMER: THESE NUMBERS REFLECT WHAT IS CURRENTLY AVAILABLE FOR LEASE AND DO NOT DESCRIBE THE TOTAL SQUARE FOOTAGE

PROPERTY HIGHLIGHTS

- +/- 477 SQ. FT.
- FRONTAGE ON 3 ROADS OLD 290, MAIN ST. AND FARR RD.
- WALLER CHAMBER OF COMMERCE AT YOUR DOORSTEP
- WALLER ECONOMIC DEVELOPMENT CORP. AT YOUR DOORSTEP
- ACROSS FROM FORK & FLAME A NEW FOOD TRUCK PARK
- ON THE CORNER OF WALLER PLAZA, CITY EVENTS AREA

CONTACT US IF YOU HAVE ANY QUESTIONS OR TO SCHEDULE A TOUR

 936-284-5836