



40
WEST
57TH STREET

**BRAND NEW HIGH-END SUBLEASE
WITH CENTRAL PARK VIEWS**

Partial 17th Floor | 20,775 RSF

NEWMARK

AVAILABILITY

Floor / Area: Partial 17th Floor | 20,775 RSF

- *Divisible to 17,525 RSF and 3,250 RSF*

Possession: Immediate

Asking Rent: Upon Request

Sublease Term: Through March 2034

SPACE DETAILS

Recently built, high-end installation

Mix of private offices, meeting rooms/conference rooms
and open area work stations

Open pantry

Fully furnished and wired

Great natural light with views of Central Park

New building Amenity Center on 2nd floor featuring conference rooms,
soft seating, coffee bar and outdoor terrace



PARTIAL 17TH FLOOR | 20,775 RSF

- Divisible to 17,525 RSF and 3,250 RSF

77 workstations

18 offices (2 executive offices)

2 conference rooms

Open pantry

Private restroom/wellness room

Copy/print area

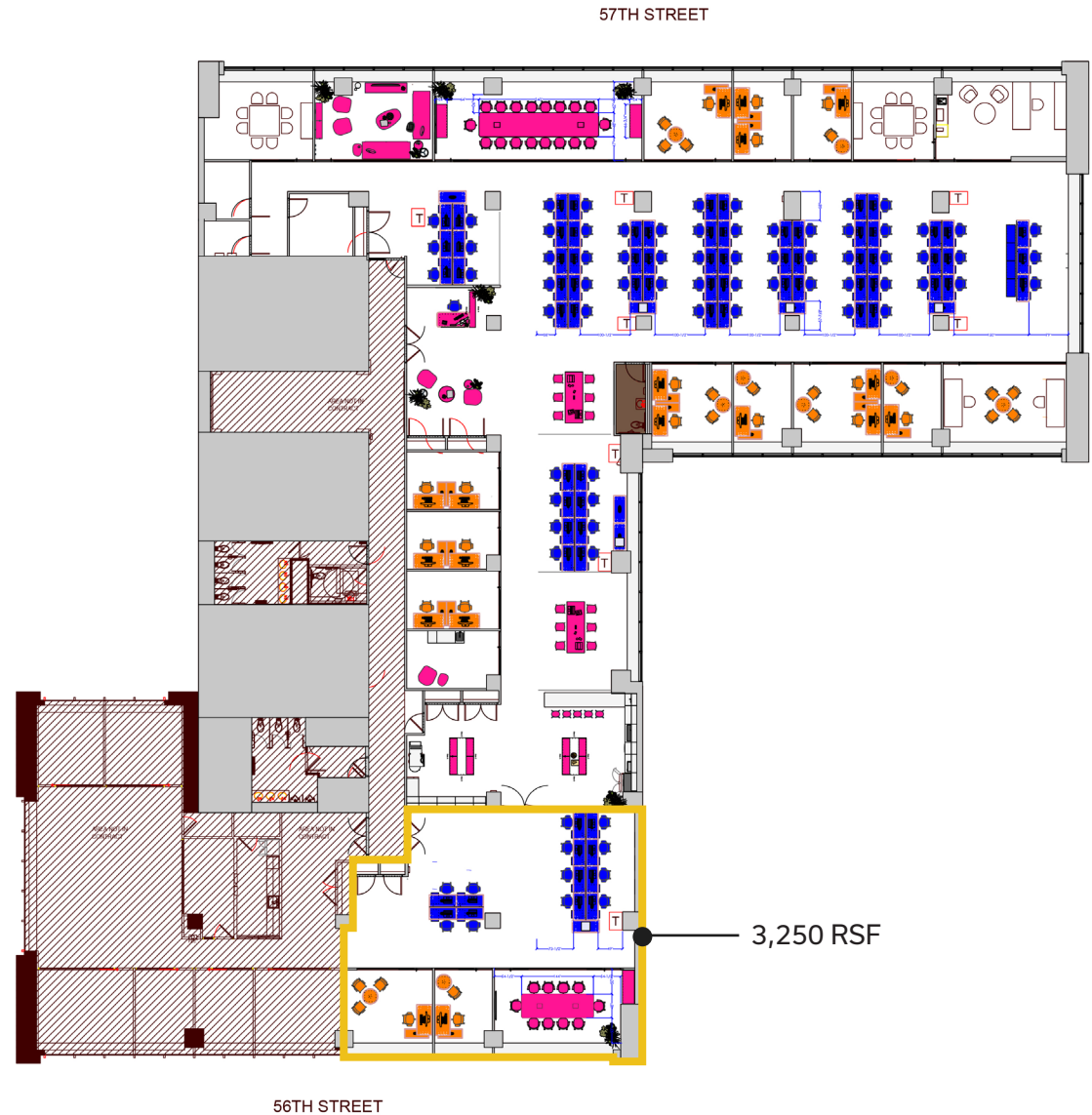





40 West 57th Street





Building Amenity Center



40 West 57th Street





**40
WEST**
57TH STREET

CONTACT

JUSTIN POLLNER

MANAGING DIRECTOR
212-372-0780
Justin.Pollner@nmrk.com

JARED HOROWITZ

VICE CHAIRMAN
212-372-2022
Jared.Horowitz@nmrk.com

NEWMARK

The information contained herein has been obtained from sources deemed reliable but has not been verified and no guarantee, warranty or representation, either express or implied, is made with respect to such information. Terms of sale or lease and availability are subject to change or withdrawal without notice.

©Newmark. All Rights Reserved.