



INDUSTRIAL
LEASE

CEDAR PLAZA

3630 S Cedar Street / 3635 S Lawrence Street, Tacoma, WA 98409

Jack Rosen

425.289.2221

jack@rosenharbottle.com

425.454.3030
rosenharbottle.com

PO Box 5003
Bellevue, WA 98009 - 5003





TACOMA INDUSTRIAL SPACE

2,710 SF Available

PROPERTY DETAILS:

- Dock High Loading Doors
- Near Tacoma Mall and Retail/Restaurant Amenities
- Neighboring Anchor Retailers Include: Ross, Guitar Center, Michael's, McDonald's, Costco, & More
- Ample Parking
- Quick Access to I-5 and Highway-16



BUILDING D (3635) - SUITE G FLOOR PLAN

Suite	Square Feet	Rate	Notes
G	2,710 SF	Call Agent for Rates	Warehouse space with one dock high loading door, one office and one restroom. Available Now.

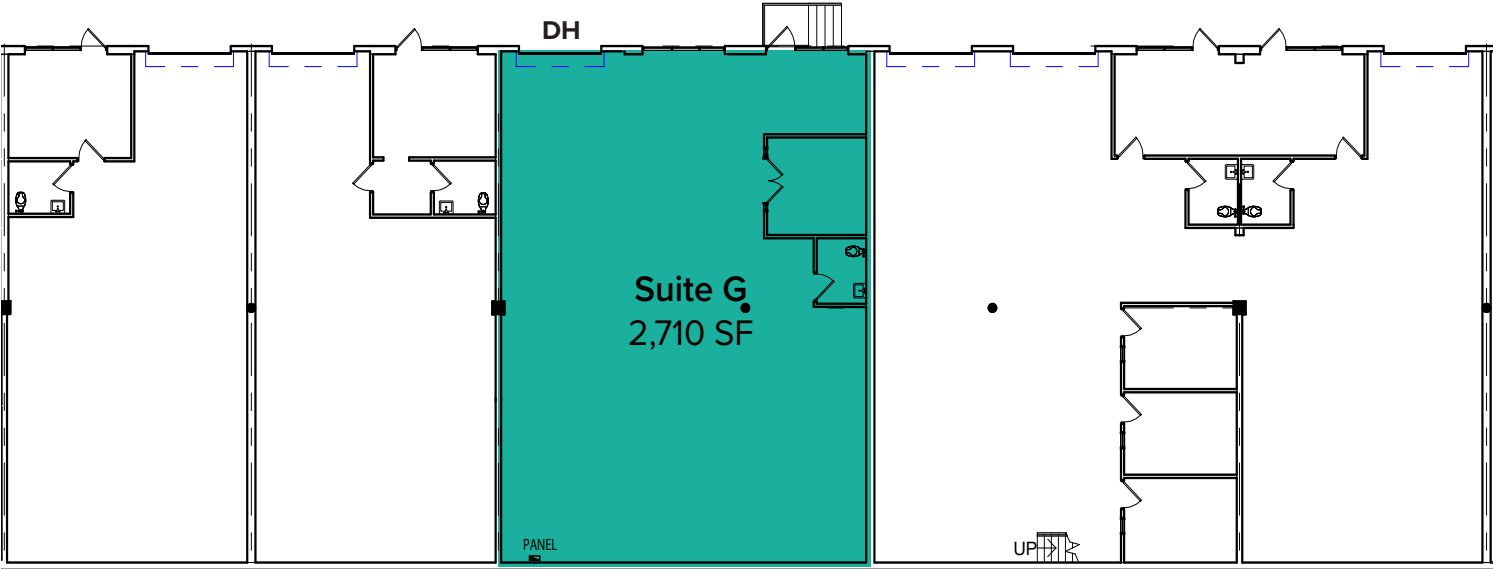

The information provided herein has been obtained from sources believed to be reliable, but no representation or warranty, express or implied, is made with respect to the accuracy or completeness of any such information. Each prospective buyer or tenant should independently investigate, evaluate and verify all information provided herein and any other matters deemed material. Please consult your attorney, tax advisor or other professional advisor. The terms of sale or lease set forth herein are subject to change or withdrawal at any time and without notice.

SITE PLAN



The information provided herein has been obtained from sources believed to be reliable, but no representation or warranty, express or implied, is made with respect to the accuracy or completeness of any such information. Each prospective buyer or tenant should independently investigate, evaluate and verify all information provided herein and any other matters deemed material. Please consult your attorney, tax advisor or other professional advisor. The terms of sale or lease set forth herein are subject to change or withdrawal at any time and without notice.