

901 N West St

Raleigh, NC 27603

OFFICE/SHOWROOM FOR LEASE





PROPERTY SUMMARY

Address	901 N West St
Available	10,572 SF
Rate	\$32.00/SF NNN

901 N West St offers 10,572 SF of showroom-warehouse space just steps from Raleigh's Smoky Hollow district and Glenwood South. Positioned in a highly walkable area with direct access to downtown amenities, this property is ideal for businesses needing a blend of visibility, function, and accessibility.

HIGHLIGHTS

- Large open space warehouse with dock-high
- On-site surface parking for staff and customers
- Walk Score: ~85 ("Very Walkable")
- Close to Smoky Hollow retail, restaurants, Publix grocery, apartments, and offices

FLOORPLANS

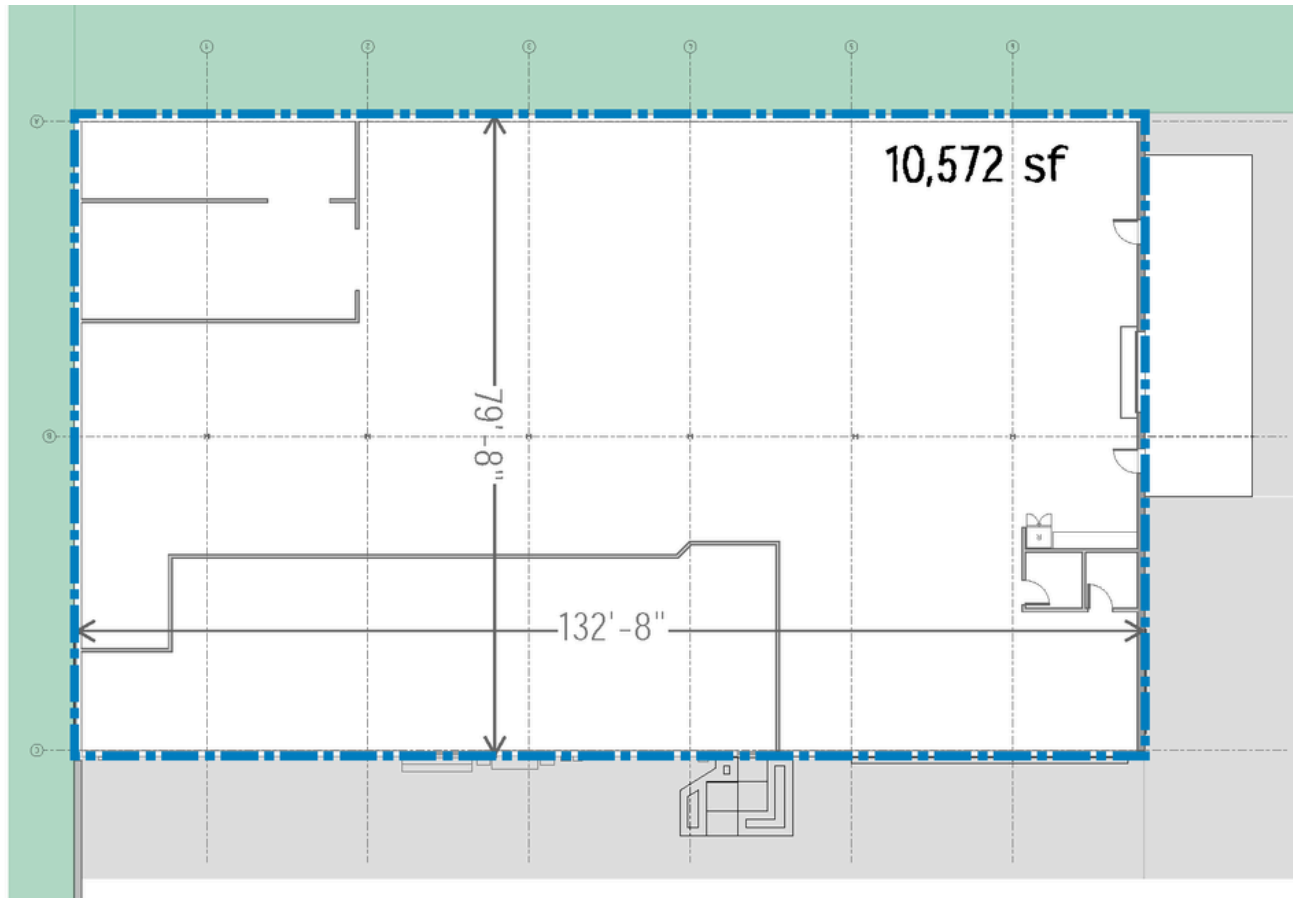



DOWNTOWN
RALEIGH

NC STATE
UNIVERSITY

SULLIVAN'S
STEAKHOUSE
VIDRIO
HAMPTON INN
& SUITES

THE
LINE
APARTMENTS

GLENWOOD
SOUTH
DISTRICT

THE DEVON
APARTMENTS

712 TUCKER
APARTMENTS

PUBLIX 

PEACE RALEIGH
APARTMENTS

MADRE
DOSE

MIDWOOD
SMOKEHOUSE

SMOKY
HOLLOW
DISTRICT

MOJOE'S
BURGERS

MELLOW
MUSHROOM 

THE CARDINAL
BAR 

KNUCKLE UP
BOXING GYM 

SITE

LAGANA
PAUL & JACKS
STELLA'S ON
WEST

DOWNTOWN RALEIGH

Downtown Raleigh has experienced tremendous growth over the past decade and is poised for even more growth as one of the fastest-growing downtowns and hottest residential markets in the country. Downtown Raleigh's many amenities are attracting new residents, office tenants, and business owners.

96

HIGHEST WALK SCORE IN THE REGION



8,543 RESIDENTIAL UNITS
DOWNTOWN



\$4.9B IN DEVELOPMENT PROJECTS COMPLETED
OR
UNDER CONSTRUCTION DOWNTOWN



48,000+ TOTAL NUMBER OF EMPLOYEES (2020)



20+ MILES OF BUS RAPID TRANSIT (BRT) PLANNED



13 MILES OF BIKE LANES IN DOWNTOWN RALEIGH



27% INCREASE IN VISITORS TO DOWNTOWN
RALEIGH IN THE PAST DECADE



21,000+ RESIDENTS LIVE WITHIN ONE MILE OF
DOWNTOWN

CONTACT

Trent Ragland, Broker

(C) 919.815.8414

tragland@atlasstark.com

Tyler Christensen, Broker

(C) 828.999.9459

tchristensen@atlasstark.com



Atlas Stark Holdings LLC |
1020 E Whitaker Mill Rd Suite 110, Raleigh, NC

