

Diversified Development Group

7519 N. Ingram #104, Fresno CA 93711

(559) 225-6363



Central Ave.

DDG- 515

Available For Lease
78,400 sf

DDG-182

Minnerama Ave.





Available For Lease

78,400 sf

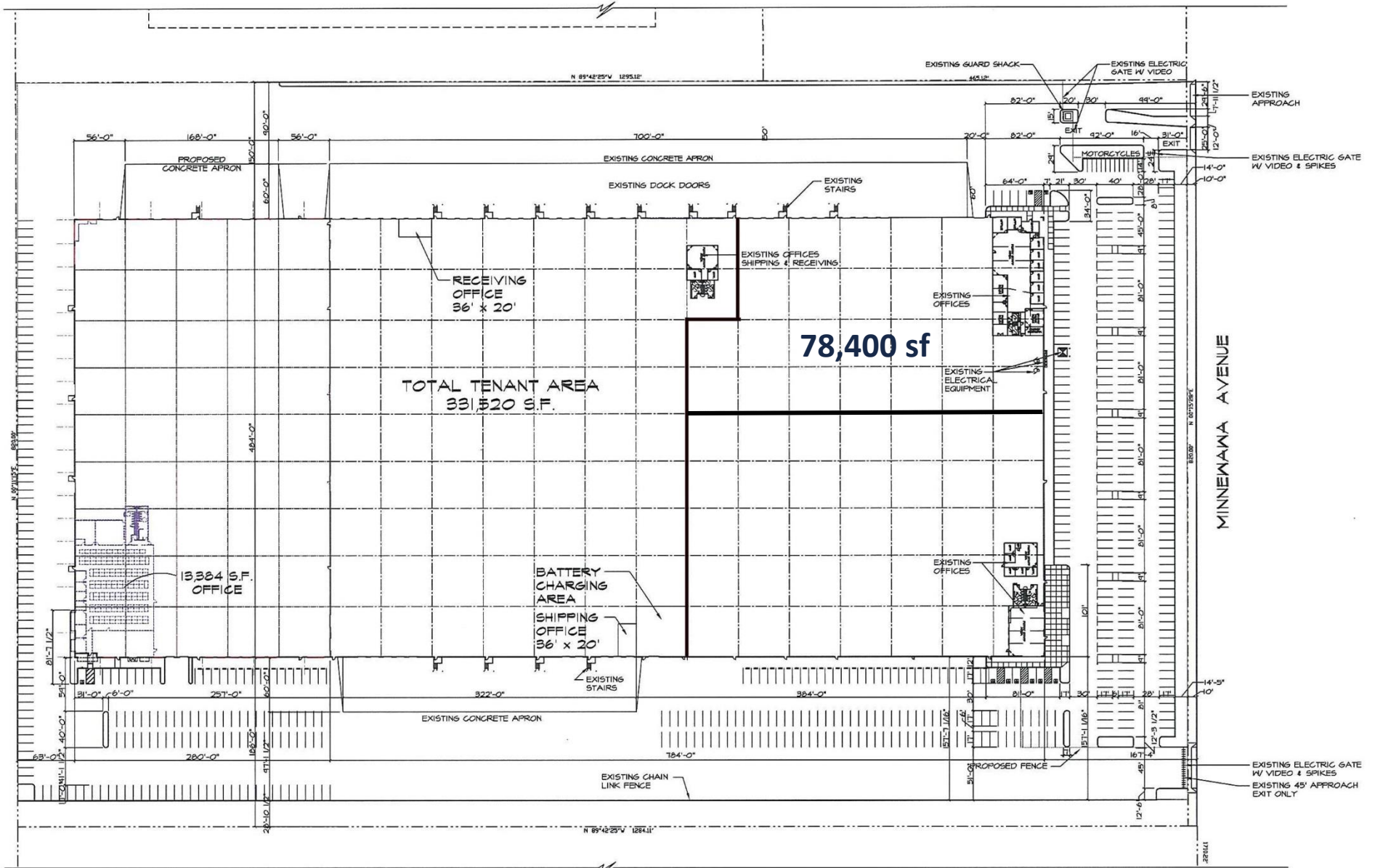

DDG-515

SPECIFICATIONS

BUILDING SIZE:	514,976 sq. ft.
SPACE AVAILABLE:	78,400 sq. ft.
DIMENSIONS:	216' x 392'
COLUMN SPACING:	56' x 52'
CONCRETE WALLS:	8"
CONCRETE SLAB:	6", laser screed
CLEAR HEIGHT:	32' minimum clear height
ROOF CONSTRUCTION:	Panelized System
ROOFING:	4-ply built up system - heat reflective white
SKY LIGHTS:	4' x 8' - 9 per bay
CROSS DOCK:	145' truck court from edge-of-dock to curb on north and south elevations
DOCK CONSTRUCTION:	60' reinforced 6" concrete dock apron, ±1% slope
TRUCK DOORS:	<u>North Elevation.</u> (13) 9' x 10' dock high doors and (1) 12' x 14' grade level door.
FIRE SYSTEM:	ESFR System with 150 horsepower booster pump
OFFICE:	7,300 SF Main office northeast corner
ADDRESS:	4247 S. Minnewawa, Fresno, CA 93725

For further information, please contact
Marcus Pignotti

(559) 225-6363, ext. 8