

FIRST FLOOR
SUITE 152

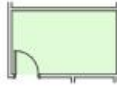

TENANT AREA	COMMON (16%)	RENTABLE AREA
111 SF	18 SF	129 SF

1" = 20' 0 5' 10' 15' 20'



4021 AMBASSADOR CAFFERY PKWY
LAFAYETTE, LA 70503

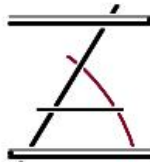

ZILER
ARCHITECTS
A PROFESSIONAL
ARCHITECTURAL
CORPORATION

JAMES O. ZILER, ARCHITECT
SEAN R. PRIMEAUX, ARCHITECT
101 Calco Boulevard
Lafayette, Louisiana 70503
Ph: 337-269-6326

CONTACT:
CHAMPION REAL ESTATE SERVICES
100 RUE IBERVILLE, SUITE 200
LAFAYETTE, LA 70508
(337) 593-0444

FIRST FLOOR

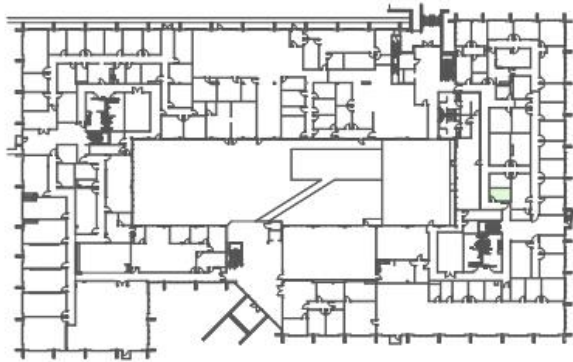

07/10/24