

New Construction Warehouse Condos

EXCLUSIVELY OFFERED BY
WILSON HUTCHISON REALTY, LLC



WILSON HUTCHISON
REALTY, LLC

***Delivering August*
2025**

**Industrial and Personal
Small-Bay Warehouse
Condominiums**

**2723 Pine Grove Road
Cumming, GA 30005**

Six 2,044 SF bays
With Dock & Drive-In Doors

12' x 14' Drive-In
9' x 8' Dock High

Asking \$598,892

***Artistic rendering –
Subject to change***

**Robert Wilson
770-318-9439 – Cell
Or
Robert@wilsonhutch.com**

Industrial / Personal Use • Warehouse / Manufacturing

The information has been secured from sources we believe to be reliable, but we make no representations or warranties, expressed or implied, as to the accuracy of the information.

5755 North Point Parkway, Suite 44, Alpharetta, GA 30022 Tel: 770-242-7917 Fax: 678-325-4824 | www.wilsonhutch.com

**2723 Pine Grove Road
Cumming, GA 30005
Forsyth County**

**EXCLUSIVELY OFFERED BY
WILSON HUTCHISON REALTY, LLC**



**WILSON HUTCHISON
REALTY, LLC**

- **Zoned: M1**
- **20' clear height**
- **100% HVAC**
- **Half Bath with additional stub out for future bath/shower**
- **LED lighting**
- **Sprinkler System**
- **Polished concrete floor**

OPTIONS:

- **Mezzanine**
- **Office space**
- **Water drain in floor**
- **3 Phase power**
- **Additional outlets around walls**
- **Utility sink**



**Robert Wilson
770-318-9439 – Cell
Or
Robert@wilsonhutch.com**

The information has been secured from sources we believe to be reliable, but we make no representations or warranties, expressed or implied, as to the accuracy of the information.

5755 North Point Parkway, Suite 44, Alpharetta, GA 30022 Tel: 770-242-7917 Fax: 678-325-4824 | www.wilsonhutch.com

2723 Pine Grove Road
Cumming, GA 30005
Forsyth County

EXCLUSIVELY OFFERED BY
WILSON HUTCHISON REALTY, LLC



BUILDING 600 (APPROX SQ FTG)
12,250 SQ FT BUILDING
2,041.66 SQFT UNITS

BUILDING 600 - (APPROX DIMENSIONS)
INDIVIDUAL UNITS 29.2' W X 70' D
OVERALL 175' W X 70' D

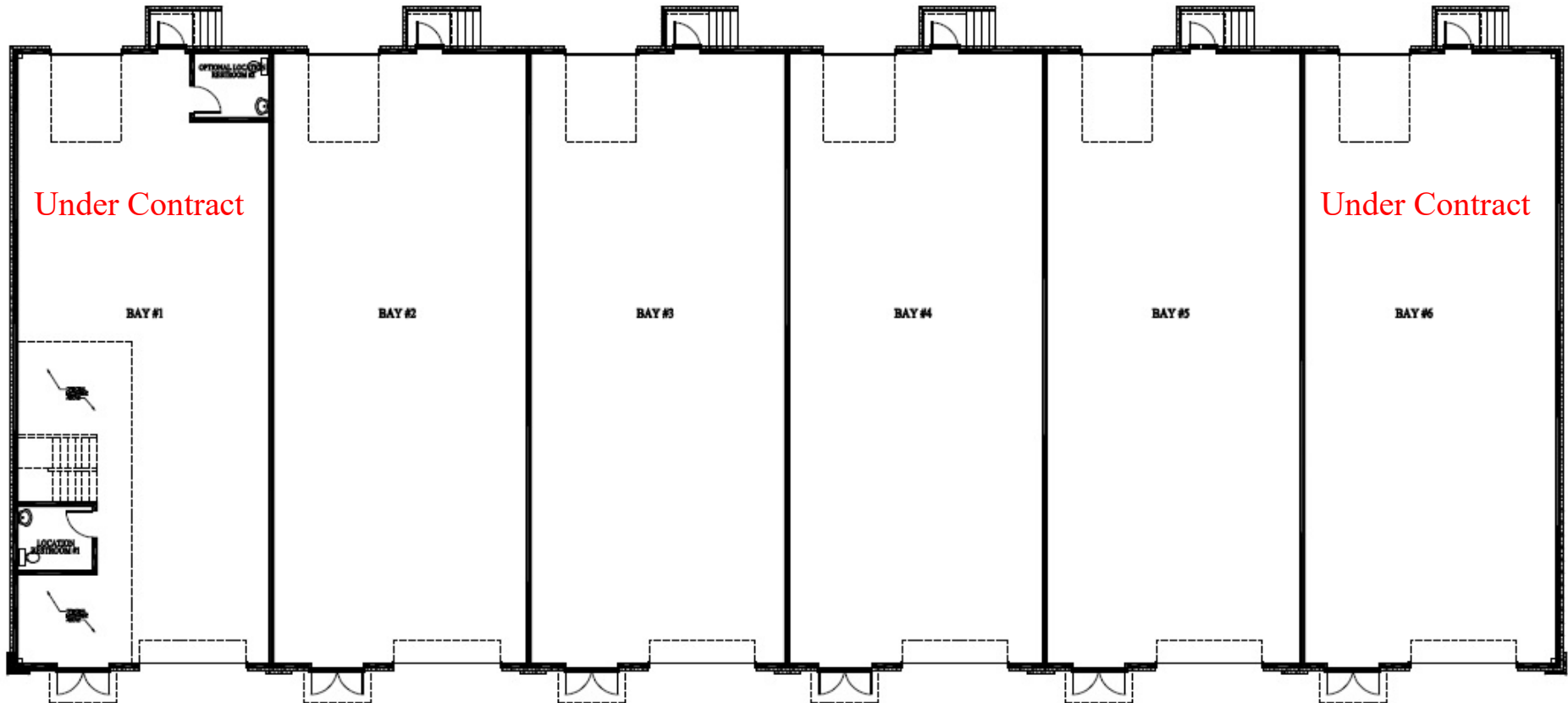

FLOOR PLAN (UNIT)

The information has been secured from sources we believe to be reliable, but we make no representations or warranties, expressed or implied, as to the accuracy of the information.

5755 North Point Parkway, Suite 44, Alpharetta, GA 30022 Tel: 770-242-7917 Fax: 678-325-4824 | www.wilsonhutch.com