

- KEY:**
- Square Footage
 - Total SF = 4620
 - Construction Type
 - 5B
 - Occupancy Load
 - Warehouse 500 gross SF/person
 - 10
- NOTES:**
- Girts to allow for 3070 doors, even if not shown
 - Veneer: Colored
 - Architectural Metal Panel
- ROOF:**
- 2:12
 - Metal R Panel

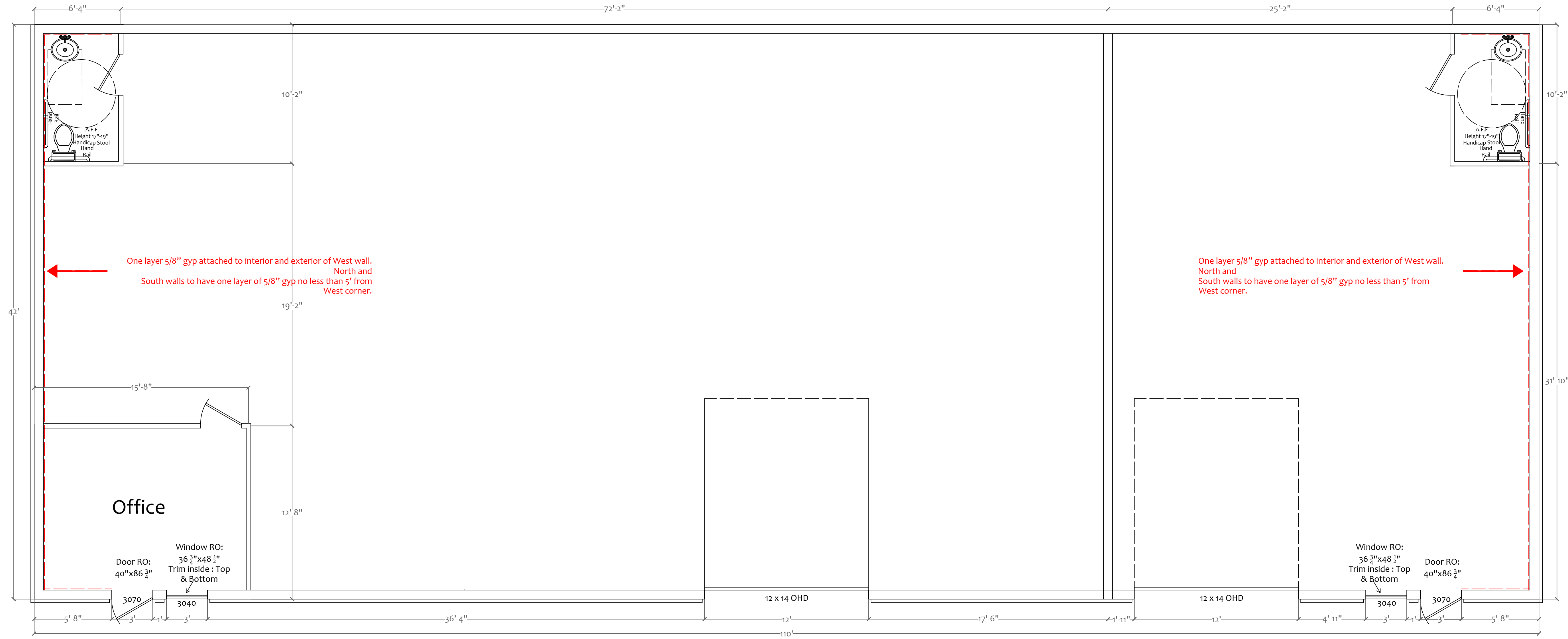
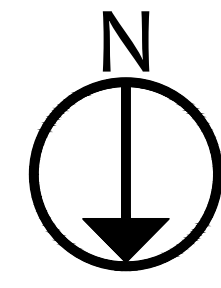

One layer 5/8" gyp attached to interior and exterior of West wall. North and South walls to have one layer of 5/8" gyp no less than 5' from West corner.

One layer 5/8" gyp attached to interior and exterior of West wall. North and South walls to have one layer of 5/8" gyp no less than 5' from West corner.

General Notes

7720 NW Passage Business Park

Oklahoma City, Oklahoma 73132

No.	Revision/Issue	Date

Firm Name and Address

Project Name and Address

7720
NWP
OKC, OK 73132

Project	7720	Sheet	1
Date	10.15.2025	Rev	FP Rev
Scale	1/4" = 1'	Date	10.15.25