

Former Gym 38,162 SF For Lease in OKC

3625 Northwest Expy | Oklahoma City, OK 73112



Property Information:

+Located west of Hefner Parkway which has a high traffic count of 121,300 ADT.

+Co-Tenants include: Pruett's Food, Affordable Dentures & Implants and Access Medical Centers Urgent Care

+Great Visibility

+Pylon Sign

+ Parking Spaces: 235

+ 366 feet of frontage on NW Expressway

+Neighbors include:Pruett's Food, Optimal Smiles, Chase Bank, IBC Bank Building, OnCue, OECU Oklahoma Educators Credit Union, Clark Crew BBQ, On the Border, and more.

+Space Available: ±38,162 SF and ±10,000 SF

+Lease Rate: Call Broker for Rate

Contact Us

Stuart Graham

Senior Vice President

+1 405 607 6027

stuart.graham@cbre.com

Mark Inman

Senior Vice President

+1 405 503 7727

mark.inman@cbre.com

Wil Scofield

Associate

+1 405 607 6093

wil.scofield@cbre.com

Former Gym Space - 38,162 SF For Lease in OKC

3625 Northwest Expy | Oklahoma City, OK 73112

For Lease

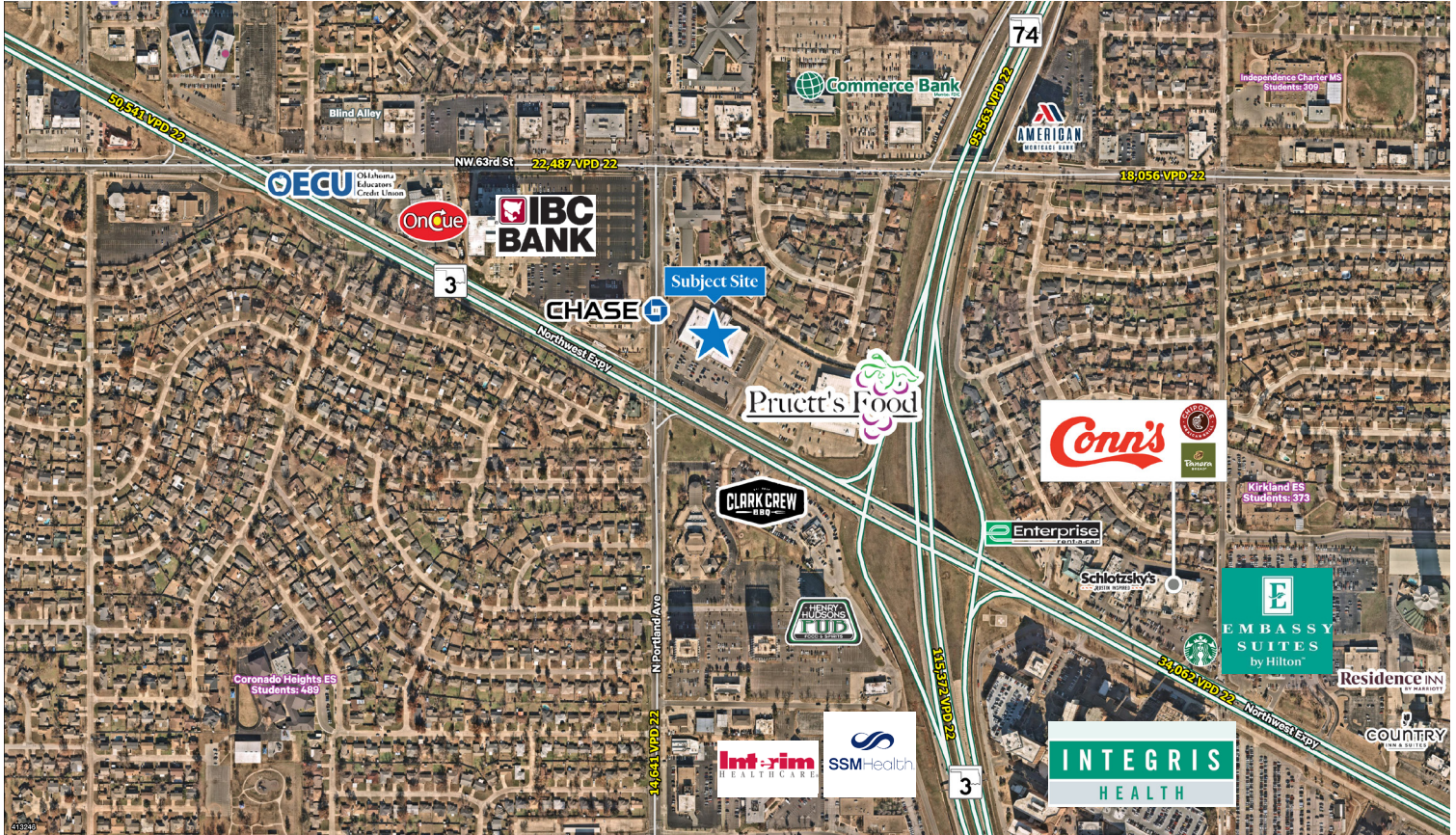

2022 Demographics	1 Mile	3 Miles	5 Miles
Population	11,587	92,185	249,095
Households	5,571	40,682	108,786
Average Household Income	\$83,247	\$93,314	\$87,100
Daytime Employees	19,841	62,631	156,223

Traffic Count	
N Portland Ave	12,000 ADT
Northwest Expressway	47,600 ADT
Lake Hefner Pkwy	121,300 ADT

Source: Oklahoma Department of Transportation

© 2023 CBRE, Inc. All rights reserved. This information has been obtained from sources believed reliable, but has not been verified for accuracy or completeness. You should conduct a careful, independent investigation of the property and verify all information. Any reliance on this information is solely at your own risk. CBRE and the CBRE logo are service marks of CBRE, Inc. All other marks displayed on this document are the property of their respective owners, and the use of such logos does not imply any affiliation with or endorsement of CBRE. Photos herein are the property of their respective owners. Use of these images without the express written consent of the owner is prohibited.