

Retail Leasing Opportunities Available in a High-Traffic Center in Sparks Submarket

PAD E  
DRIVE-THRU  
AVAILABLE

S-110  
AVAILABLE

Pioneer Meadows West



Pioneer Meadows East



FOR LEASE

# Pioneer Meadows Marketplace

Vista Blvd & Wingfield Hills Rd, Sparks, NV

**Smith Retzloff** Retail Team

**Shawn Smith**

Executive Vice President  
+1 775 823 4667  
shawn.smith@colliers.com  
LIC # NV 00046702

**Sean Retzloff**

Senior Vice President  
+1 775 823 6621  
sean.retzloff@colliers.com  
LIC # NV 0182046

**Colliers**

**Colliers Reno**

5520 Kietzke Lane, Suite 300  
Reno, NV 89511  
Colliers.com/Reno

# The Redefined Retail Experience

With major co-tenants and convenient location, Pioneer Meadows is an excellent option for employers looking to be at the heart of it all.



## PROPERTY HIGHLIGHTS

Generous tenant improvement allowance for qualified tenants

One Mile East of Golden Eagle Regional Park which draws over one million visitors annually

Adjacent properties include the Trails at Pioneer Meadows, Morning Star Assisted Living, and Wingfield Hills Health & Wellness Skilled Nursing Facility

Located on Vista Blvd, one of three main arterials providing access to Spanish Springs

Morning Star and Wingfield Hills have around the clock staffing with hundreds employed at full capacity

Drive-thru Pad available

## CO-TENANTS INCLUDE



Available for Lease

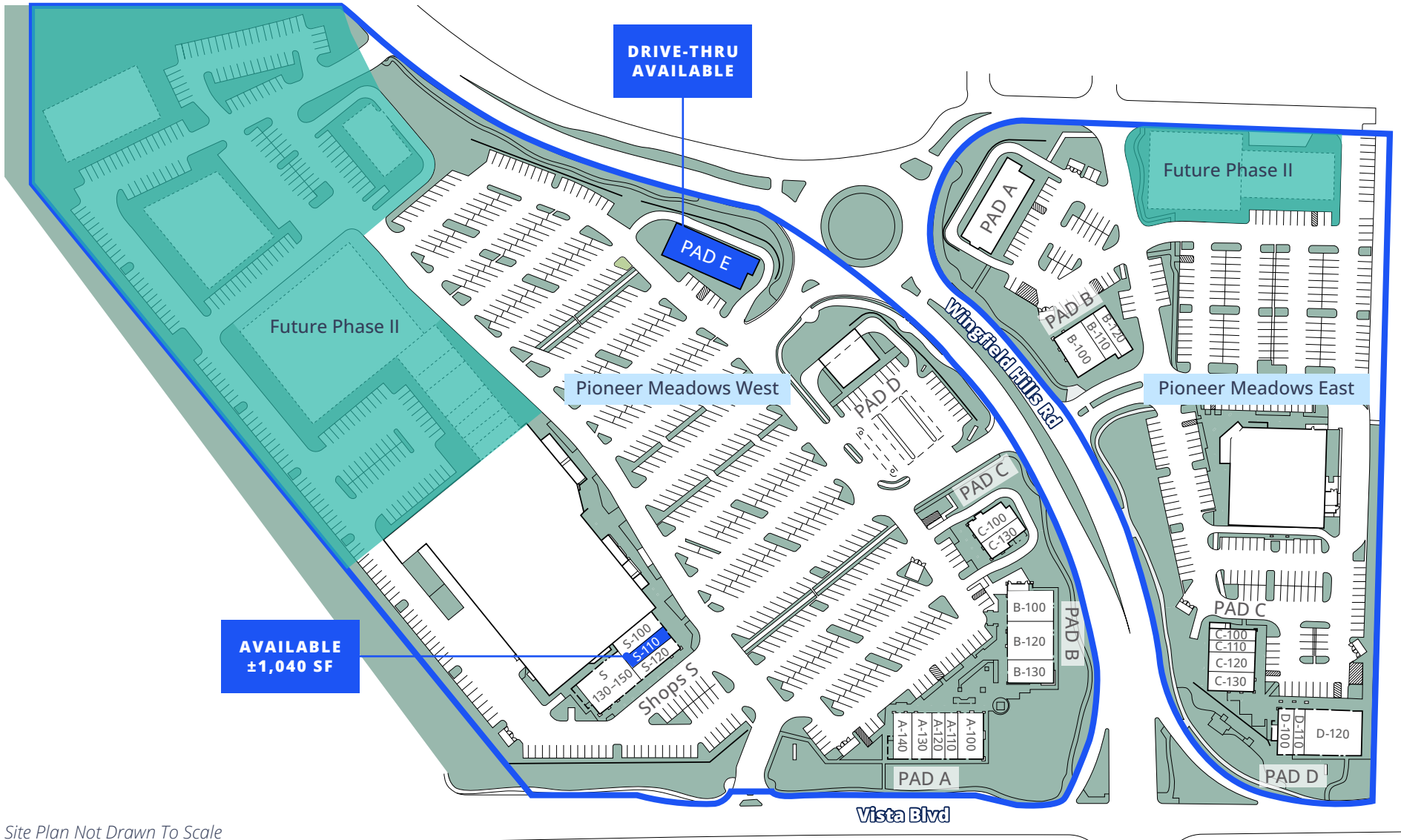

Site Plan Not Drawn To Scale

Available for Lease

© 2026 Colliers International. Information herein has been obtained from sources deemed reliable, however its accuracy cannot be guaranteed. The user is required to conduct their own due diligence and verification.





Site Plan Not Drawn To Scale

Available for Lease

© 2026 Colliers International. Information herein has been obtained from sources deemed reliable, however its accuracy cannot be guaranteed. The user is required to conduct their own due diligence and verification.



# Pioneer Meadows West

E Pad    ±5,000 Square Feet    Drive-Thru Available Now

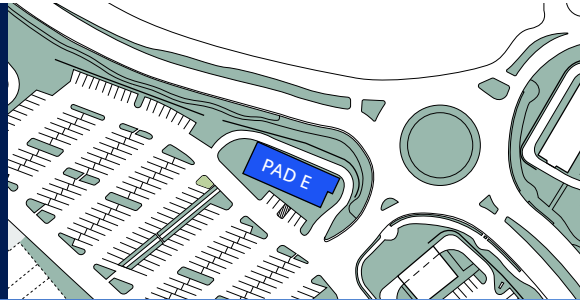

Available for Lease

© 2026 Colliers International. Information herein has been obtained from sources deemed reliable, however its accuracy cannot be guaranteed. The user is required to conduct their own due diligence and verification.



# Pioneer Meadows West

S-110  
Suite ±1,040  
Square Feet

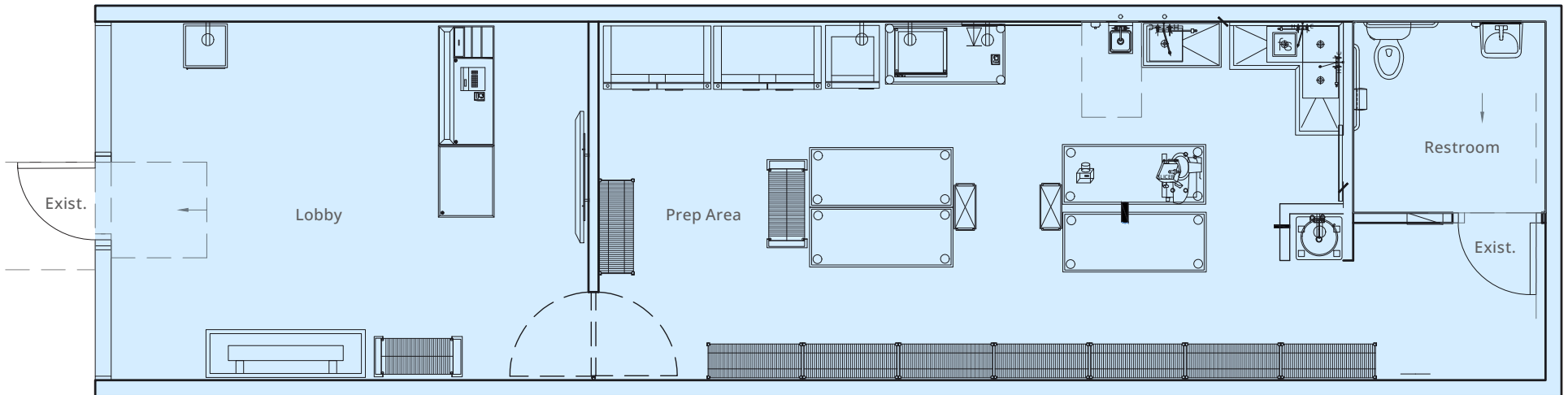
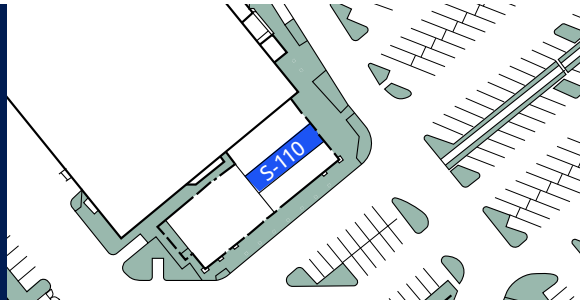

Available for Lease

PIONEER MEADOWS MARKETPLACE



Available for Lease

© 2026 Colliers International. Information herein has been obtained from sources deemed reliable, however its accuracy cannot be guaranteed. The user is required to conduct their own due diligence and verification.



Population	5 Miles	7 Miles	10 Miles
2025 Est. Population	120,673	186,116	326,970
2030 Proj. Population	126,534	195,950	342,728
2025 Med. Age	39.1	37.5	36.8
Daytime Population	77,759	158,689	336,139

Household Income	5 Miles	7 Miles	10 Miles
2025 Est. Avg. HH Income	\$128,668	\$113,065	\$102,448
2030 Proj. Avg. HH Income	\$144,578	\$127,201	\$115,177
2025 Est. Med. HH Income	\$104,867	\$88,520	\$79,131
2030 Proj. Med. HH Income	\$119,806	\$102,211	\$89,566
2025 Est. Per Capita Income	\$46,538	\$42,204	\$40,304

Household	5 Miles	7 Miles	10 Miles
2025 Est. HH	43,620	69,244	128,323
2030 Proj. HH	46,013	73,455	135,537
Proj. Annual Growth (2025-2030)	1.07%	1.19%	1.10%
Avg. HH Size	2.76	2.67	2.50

Consumer Expenditure	5 Miles	7 Miles	10 Miles
Annual HH Expenditure	\$109,696	\$97,399	\$88,749
Annual Retail Expenditure	\$35,339	\$31,206	\$28,253
Monthly HH Expenditure	\$9,141	\$8,117	\$7,396
Monthly Retail Expenditure	\$2,945	\$2,600	\$2,354

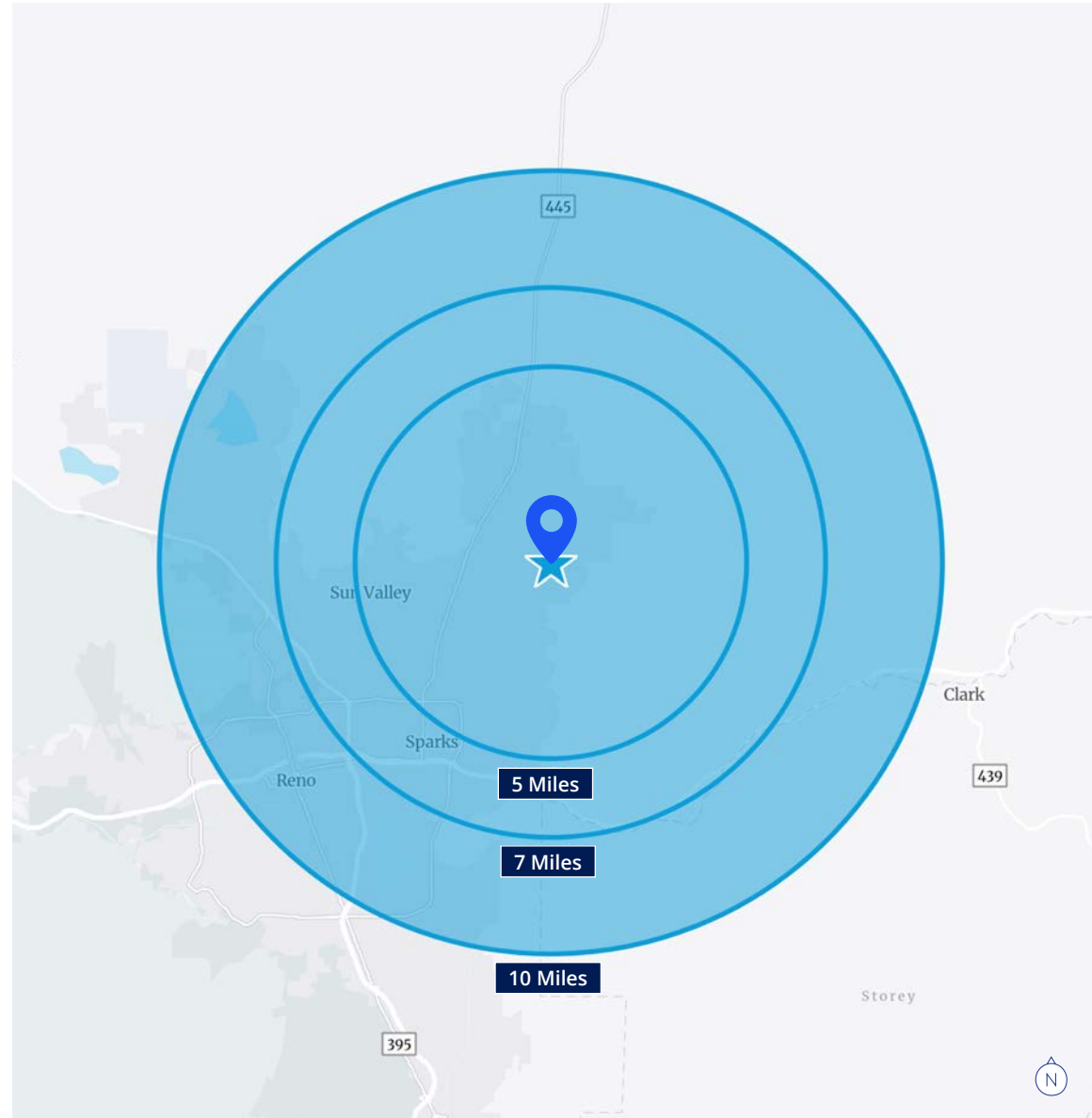

Available for Lease

© 2026 Colliers International. Information herein has been obtained from sources deemed reliable, however its accuracy cannot be guaranteed. The user is required to conduct their own due diligence and verification.





## Pioneer Meadows Marketplace

### Smith Retzloff Retail Team

#### Shawn Smith

Executive Vice President  
+1 775 823 4667  
shawn.smith@colliers.com  
LIC # NV 00046702

#### Sean Retzloff

Senior Vice President  
+1 775 823 6621  
sean.retzloff@colliers.com  
LIC # NV 0182046



Accelerating success.

#### Colliers Reno

5520 Kietzke Lane, Suite 300  
Reno, NV 89511  
Colliers.com/Reno