

**FOR SUBLEASE**  
**50,000 to 88,560 SF**

**100% Climate Controlled Warehouse**



**Eisenhauer North Business Park - Bldg. 3**

**5935 EISENHAUER ROAD, SUITE B300, SAN ANTONIO, TX 78218**



5935 EISENHAUER ROAD, SUITE B300, SAN ANTONIO, TX 78218

# PROPERTY HIGHLIGHTS

Building Size: 152,915 SF

Sublease Space: 50,000 to 88,560 SF

- 2,700 SF Office

22 dock high with 10 dock levelers & seals

1 drive up ramp (12' X 14')

14 trailer parking spaces

32' clear height

Climate controlled warehouse (68 degrees)

LED warehouse lighting

ESFR fire protection

Lease Expiration Date: 1/31/2029



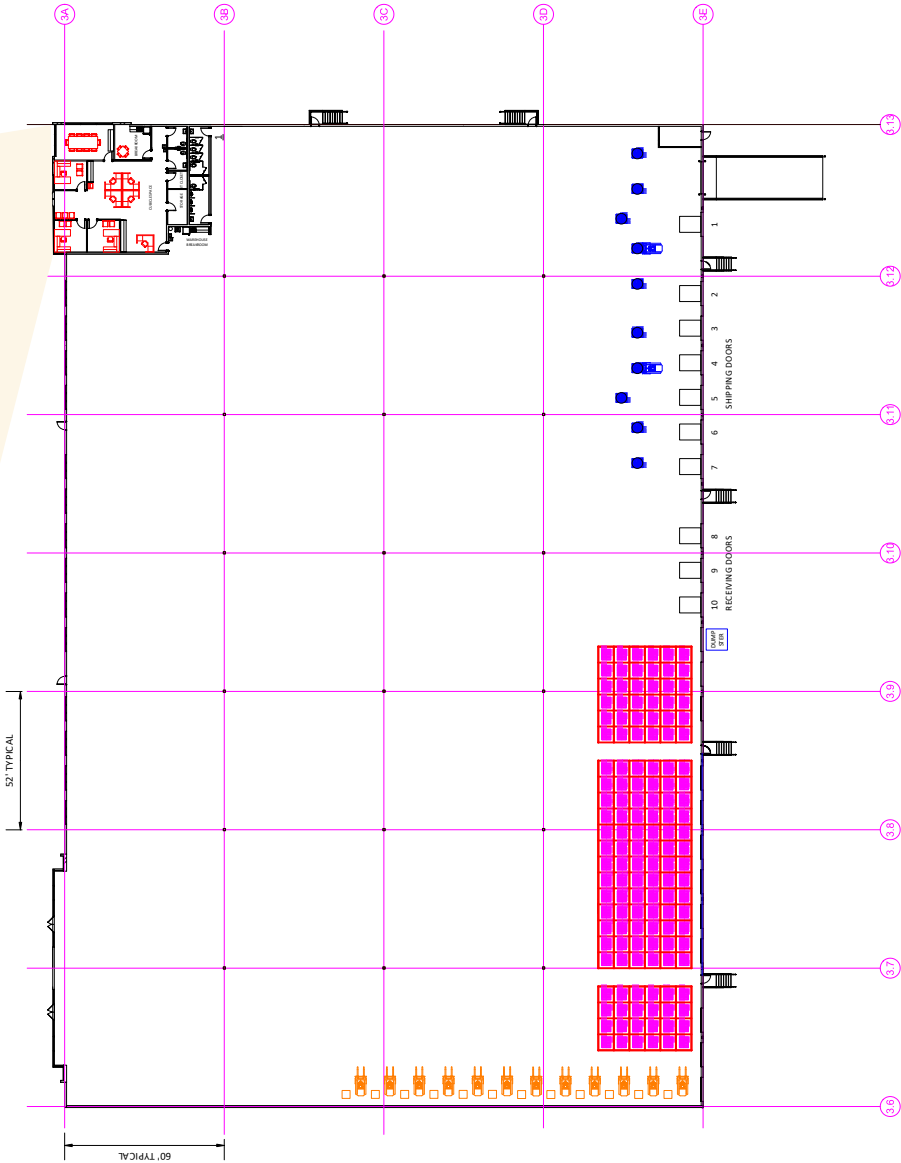
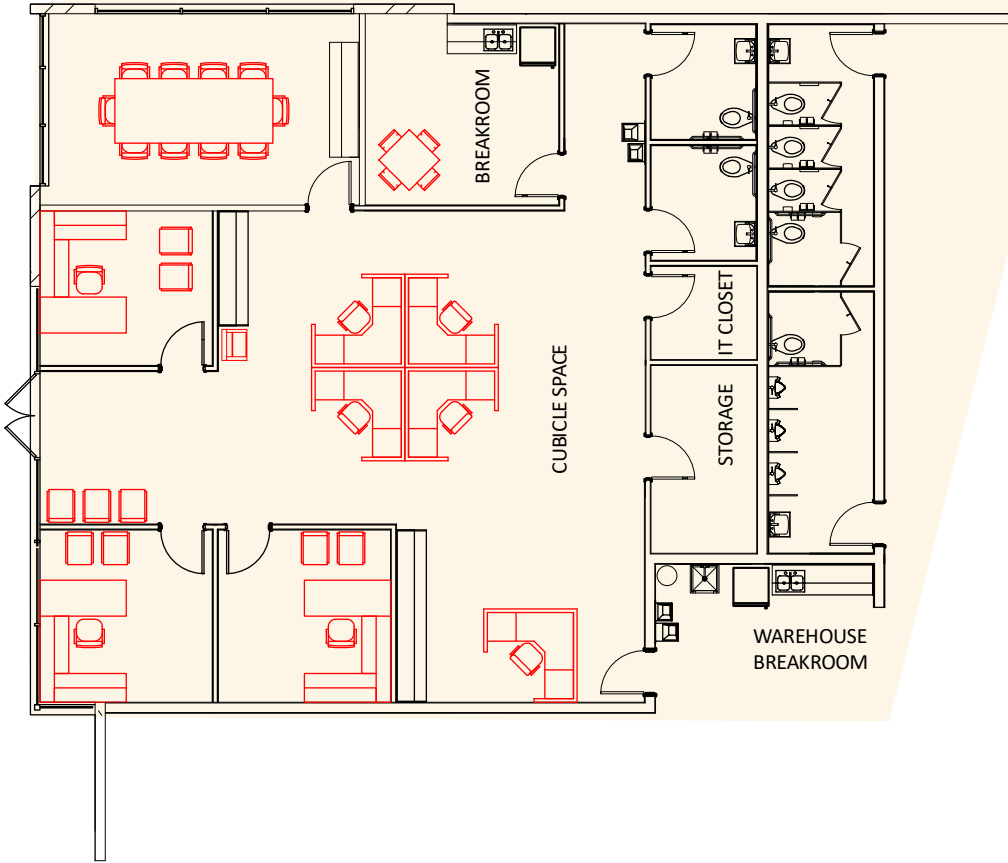

# FLOOR PLAN

## 88,560 SF

**1.7 MILES**

TO INTERSTATE 35

**2.0 MILES**

TO INTERSTATE 35

**5935 Eisenhower Road**

1.7 Miles

2.0 Miles

**CAMELOT 1**

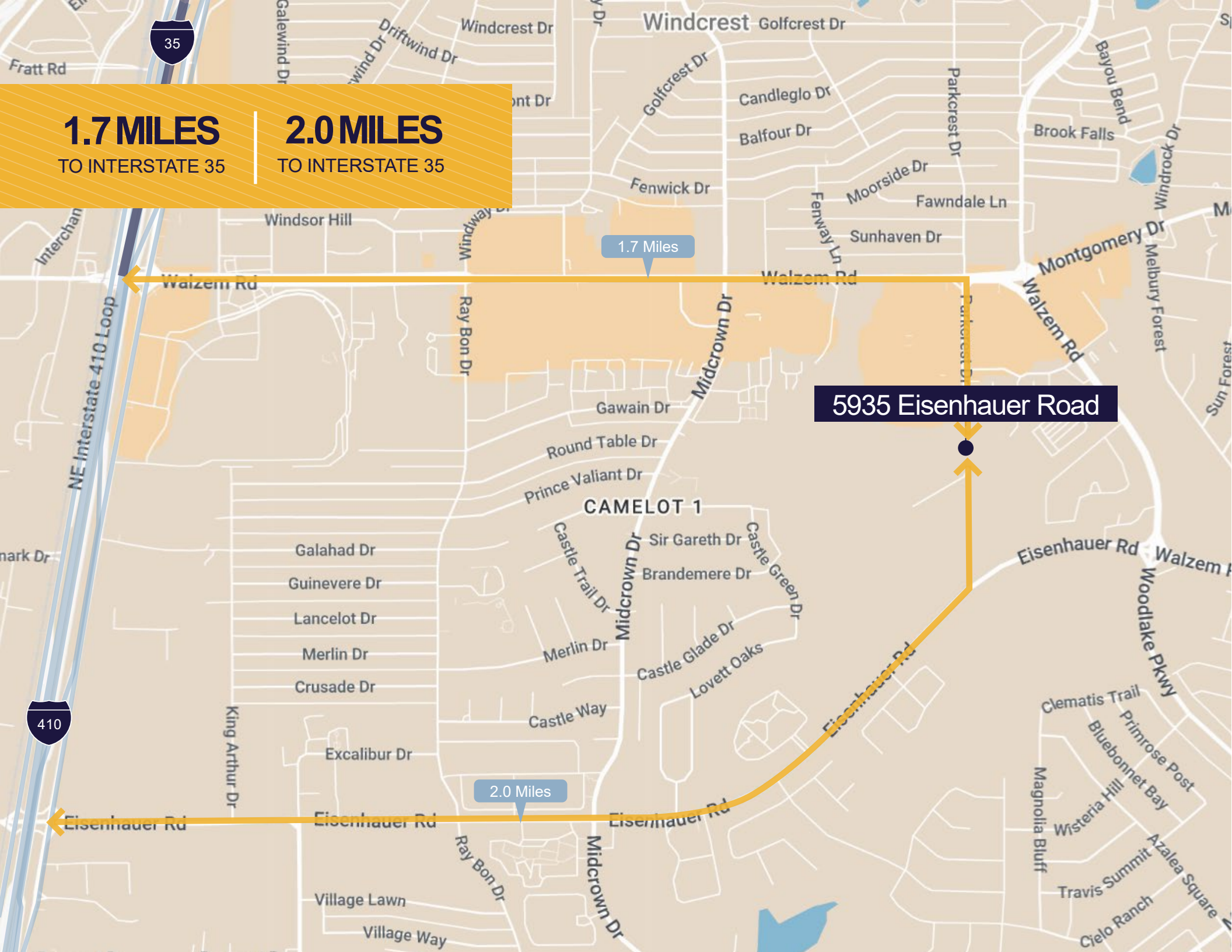



# AMENITY MAP

# CONTACT INFORMATION

## **Carlos Marquez, SIOR**

Senior Director

+1 210 896 2525

[carlos.marquez@cushwake.com](mailto:carlos.marquez@cushwake.com)

## **Sergio Acosta**

Senior Director

+1 210 304 4284

[sergio.acosta@cushwake.com](mailto:sergio.acosta@cushwake.com)

4040 Broadway Street, Suite 602

San Antonio, TX 78209

[cushmanwakefiled.com](http://cushmanwakefiled.com)

