

2775 Betty Lane

Las Vegas, NV 89156

Secured Yard For Lease

+/-4.77 Acres



Leasing Information:
702.221.8226

Ali Roesener, SIOR
NRE: S.0172338
Senior Vice President
702-765-8894
Ali.Roesener@lpc.com

Tony Alvarez
NRE: S.0200369
Associate
702-765-8880
Tony.Alvarez@lpc.com

4755 Dean Martin Drive
Las Vegas, NV 89013

Lincoln

www.lpc.com

2775 Betty Lane

Las Vegas, NV 89156

Secured Yard For Lease

+/-4.77 Acres

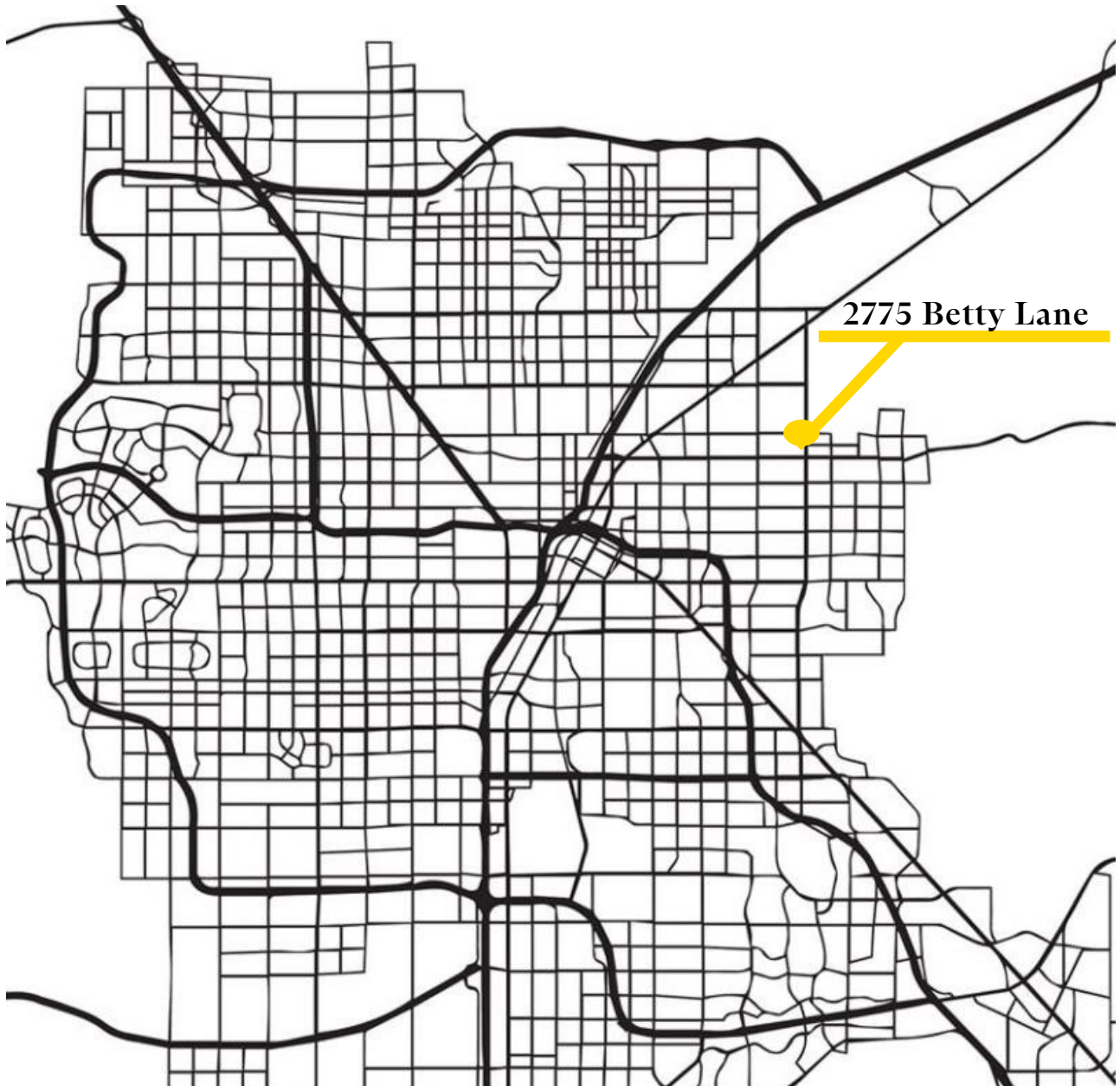

2775 Betty Lane is an IOS (Industrial Outside Storage) site located in the Las Vegas North Industrial submarket.

Ali Roesener, SIOR

702-765-8894

Ali.Roesener@lpc.com

Tony Alvarez

702-765-8880

Tony.Alvarez@lpc.com

Lincoln

2775 Betty Lane

Las Vegas, NV 89156

Secured Yard For Lease

+/-4.77 Acres

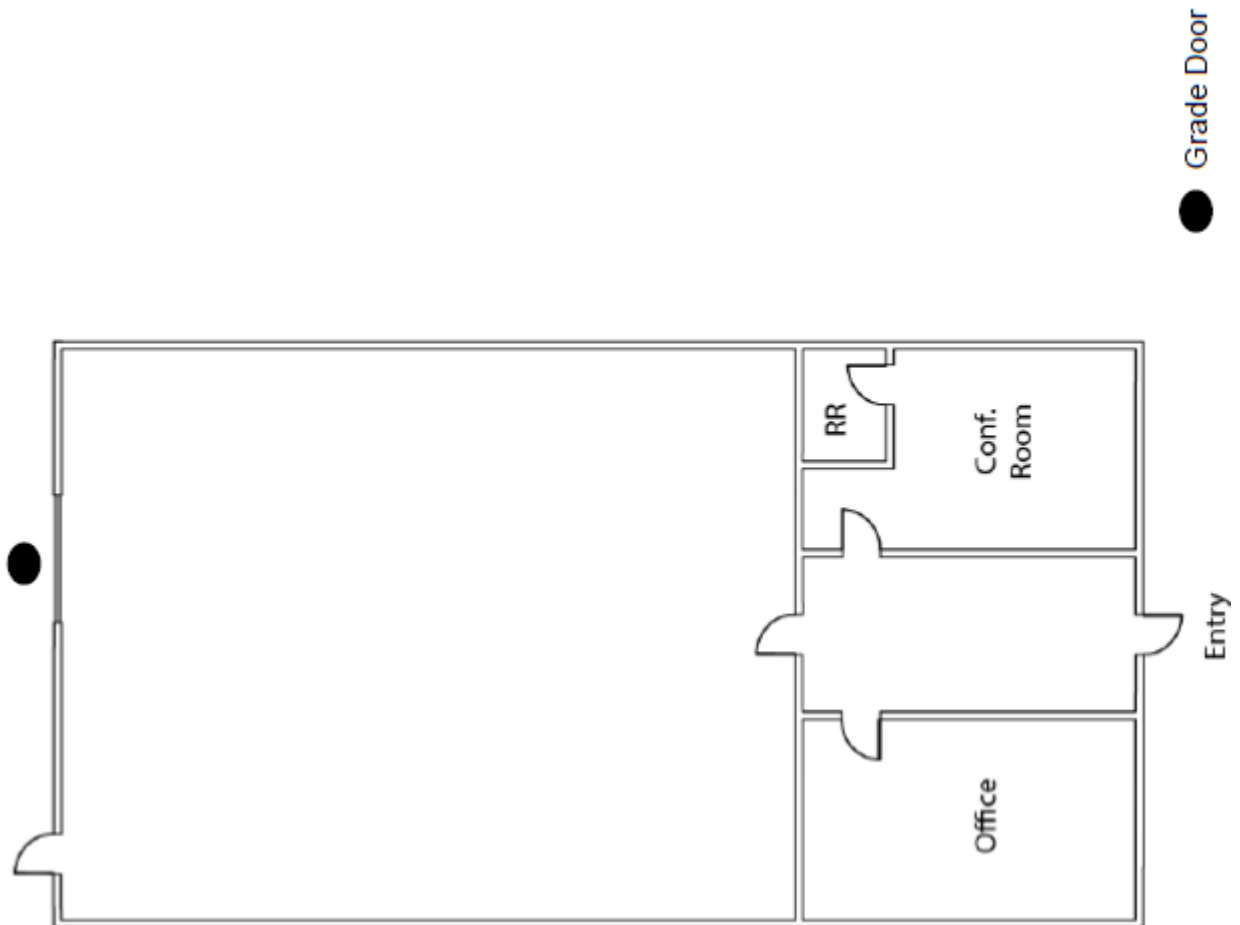

Quonset Hut Highlights:

- ±5,300 SF Quonset Hut
- ±4.77 Secured Yard
- 17' Clear Height
- Power: 3 Phase 225 amps
- 16' x 16' Grade Door
- Two (2) Restrooms
- Evaporative Cooled Warehouse
- Pricing: \$0.22/PSF
- Lease Rate PSF on the total acreage
- \$45,711.86 NNN per month
- OpEx: TBD

Ali Roesener, SIOR

702-765-8894
Ali.Roesener@lpc.com

Tony Alvarez

702-765-8880
Tony.Alvarez@lpc.com

Lincoln

2775 Betty Lane

Las Vegas, NV 89156

Secured Yard For Lease

+/-4.77 Acres

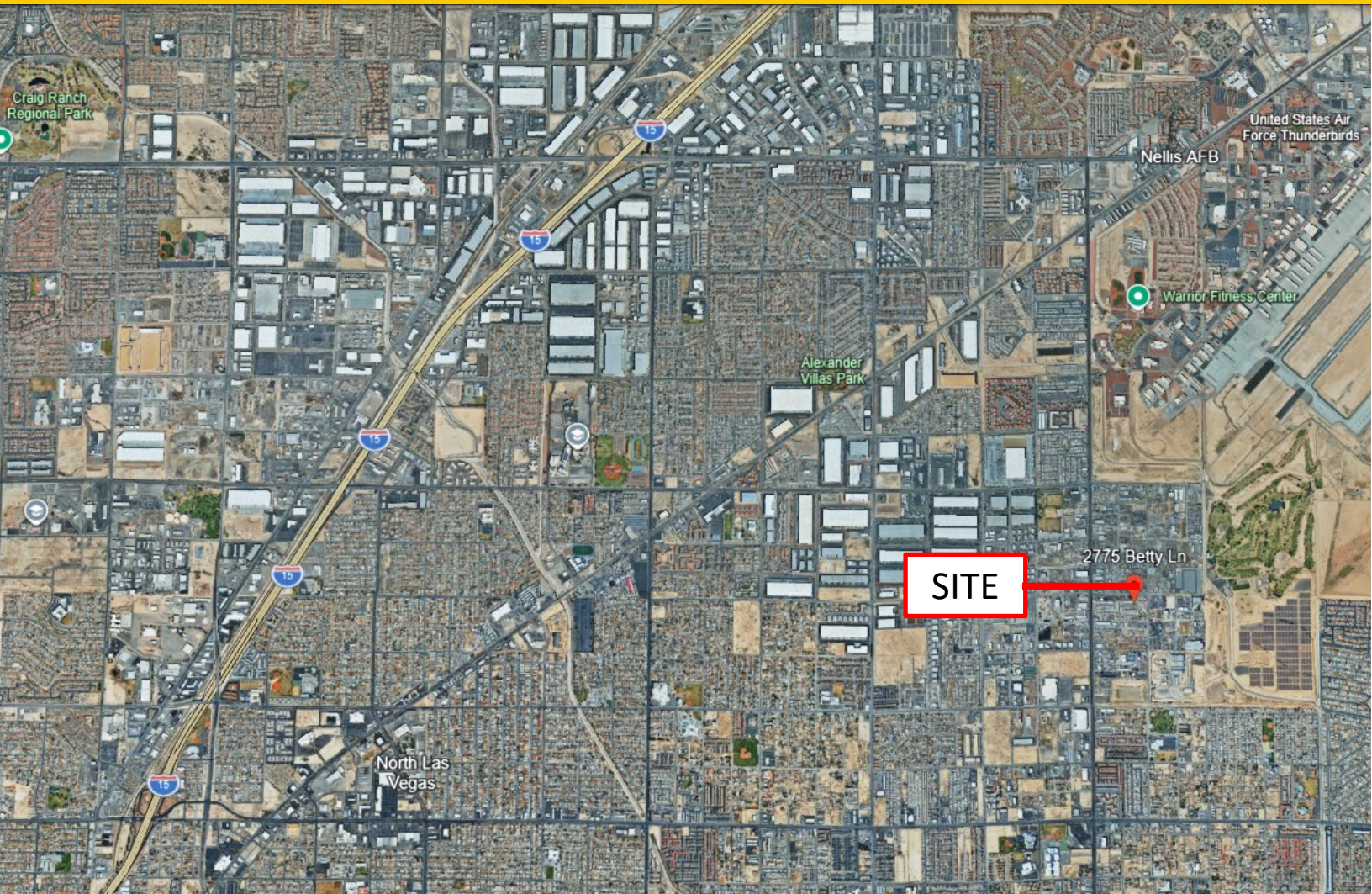

Property Overview

- ±5,300 SF Quonset Hut
- ±4.77 Acres
- Fully Fenced Yard
- Zoning IP(Industrial Park)
- Lighting
- Move-in Ready

Ali Roesener, SIOR

702-765-8894
Ali.Roesener@lpc.com

Tony Alvarez

702-765-8880
Tony.Alvarez@lpc.com

Lincoln