

4340 South Padre Island Dr.

Suite 2-4

SHOWROOM AND WAREHOUSE SPACE
AVAILABLE NOW



Cherylyn Boyd

361-585-0300

cherylyn@stonewaterproperties.com

www.stonewaterproperties.com



The Unit

Located just off South Padre Island Drive, this recently renovated property offers a mix of office and warehouse space with strong exposure in a high-traffic Corpus Christi corridor.

The unit features a large showroom, warehouse component, and rear loading, allowing for efficient flow between front-of-house and back-end operations.

Scan to Learn More



Total Square Footage	37,275 SF (approx.)
Warehouse	4,145 SF
Showroom	33,130 SF
Base Rent	\$14.01 NNN
Availability	Immediate



4340 South Padre Island Dr.

Suite 2-4



FLOOR PLAN

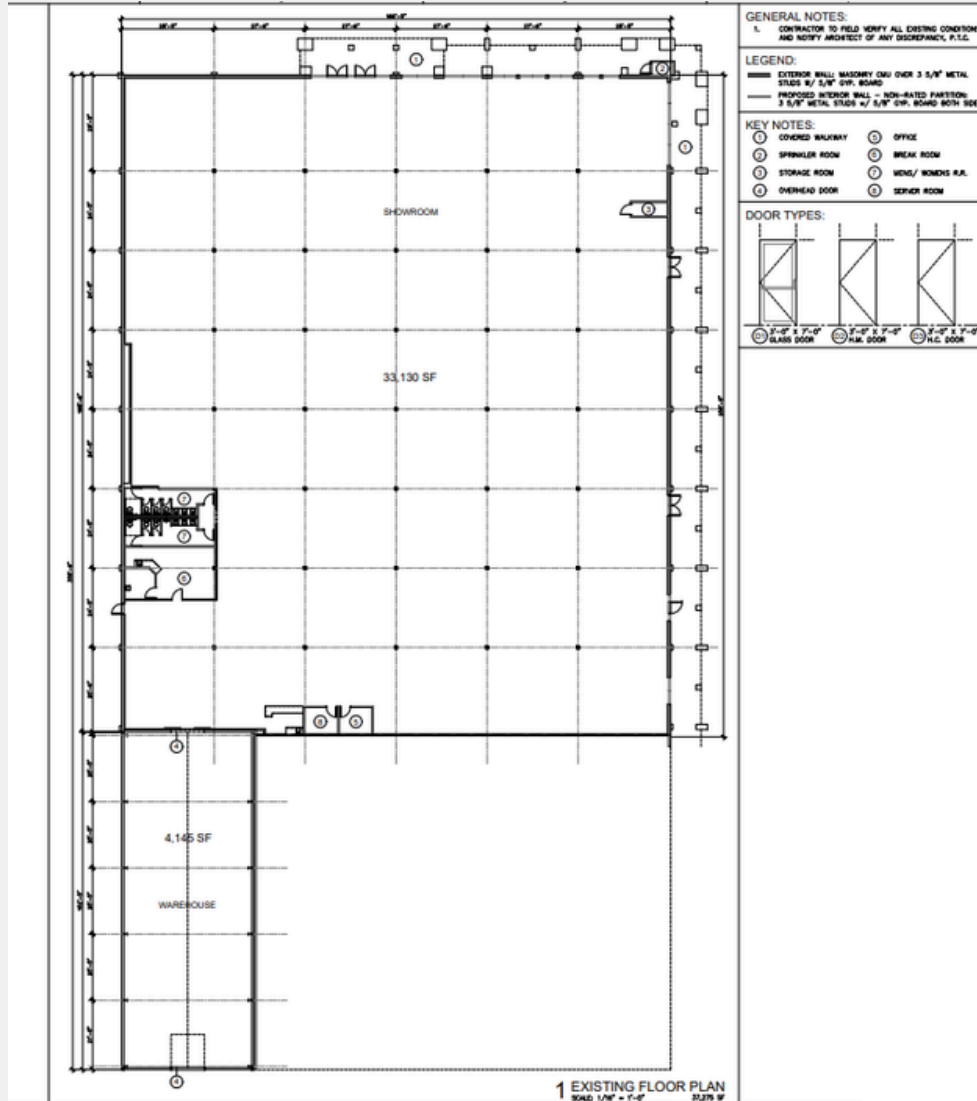

Scan to Learn More



Cherylyn Boyd

361-585-0300
cherylyn@stonewaterproperties.com

www.stonewaterproperties.com