

SCOTTSDALE AIRPARK

FOR LEASE ±3,190 RSF

THIRD FLOOR CLASS "A" OFFICE SUITE

7345 E ACOMA DRIVE • SUITE 305 • SCOTTSDALE AZ 85260

\$25/SF/YR FULL SERVICE
INCLUDES
ELECTRIC & JANITORIAL



For additional information or to schedule a tour please contact Randy or Amanda



Randy Shell
Designated Broker
C 480.694.4100
randy@shellcommercial.com



Amanda Wright
Senior Associate
C 480.236.0037
amanda@shellcommercial.com

 **SHELL**
Commercial Investment Real Estate
480.443.3992 • shellcommercial.com
16410 N 91st St | Ste 112 | Scottsdale, AZ 85260

All information contained herein is subject to prior sales and leasing. This information has been secured from sources we believe to be reliable, but we make no representation or warranties, expressed or implied, as to the accuracy of this information.

±3,190 RSF THIRD FLOOR CLASS “A” OFFICE SUITE

BUILDING FEATURES:

- Three Story Class “A” Office / Hangar building adjacent to airport taxiway
- Beautiful contemporary lobby area with waiting areas and seating for guests
- Common Conference room in lobby area for tenant’s use
- High-end tenant mix with tenant directory on first floor
- Secure Access Control throughout building
- Common restrooms on each floor
- Three story office portion of building has open atrium-like setting w/ great natural light and seating area on ground floor
- Elevator
- Great views from the offices
- Convenient impressive drive-up front entrance with parking for guests
- Covered parking available
- Amazing location near high-end restaurants and amenities such as Kierland, Scottsdale Quarter, The Promenade Scottsdale and future new major development, The Parque
- Direct northbound/southbound access from Scottsdale Road with signal light at Scottsdale Road and Acoma Drive
- I-1 Zoning, City of Scottsdale



SUITE FEATURES:

- 3,190± RSF Class “A” Office
- Third floor/top floor unit
- Expansive windows throughout with both mountain and airport views
- Currently open flex floor plan with optional floor plan available
- Exposed ductwork for modern feel



Only suite in the building with its own private patio providing views from Camelback all the way to Pinnacle Peak. Beautiful!



±3,190 RSF

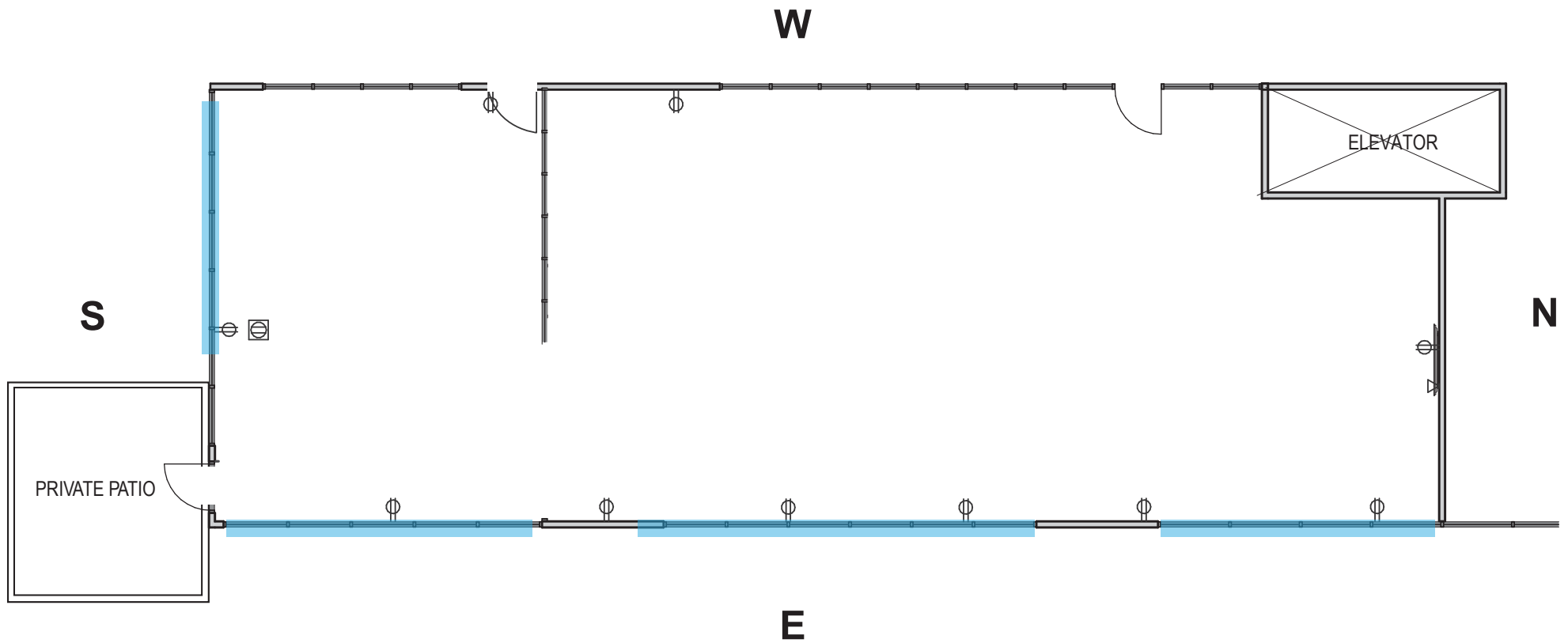

NOT TO SCALE

All information furnished regarding property for sale, rental or financing is from sources deemed reliable, but no warranty or representation is made to the accuracy thereof and same is submitted to errors, omissions, change of price, rental or other conditions, prior to sale, lease or financing or withdrawal without notice. No liability of any kind is to be imposed on the broker herein. This information has been secured from sources deemed reliable, however, we make no warranties as to its accuracy.

OPTIONAL FLOOR PLAN

7345 E ACOMA DRIVE • SUITE 305 • SCOTTSDALE AZ 85260

±3,190 RSF

W

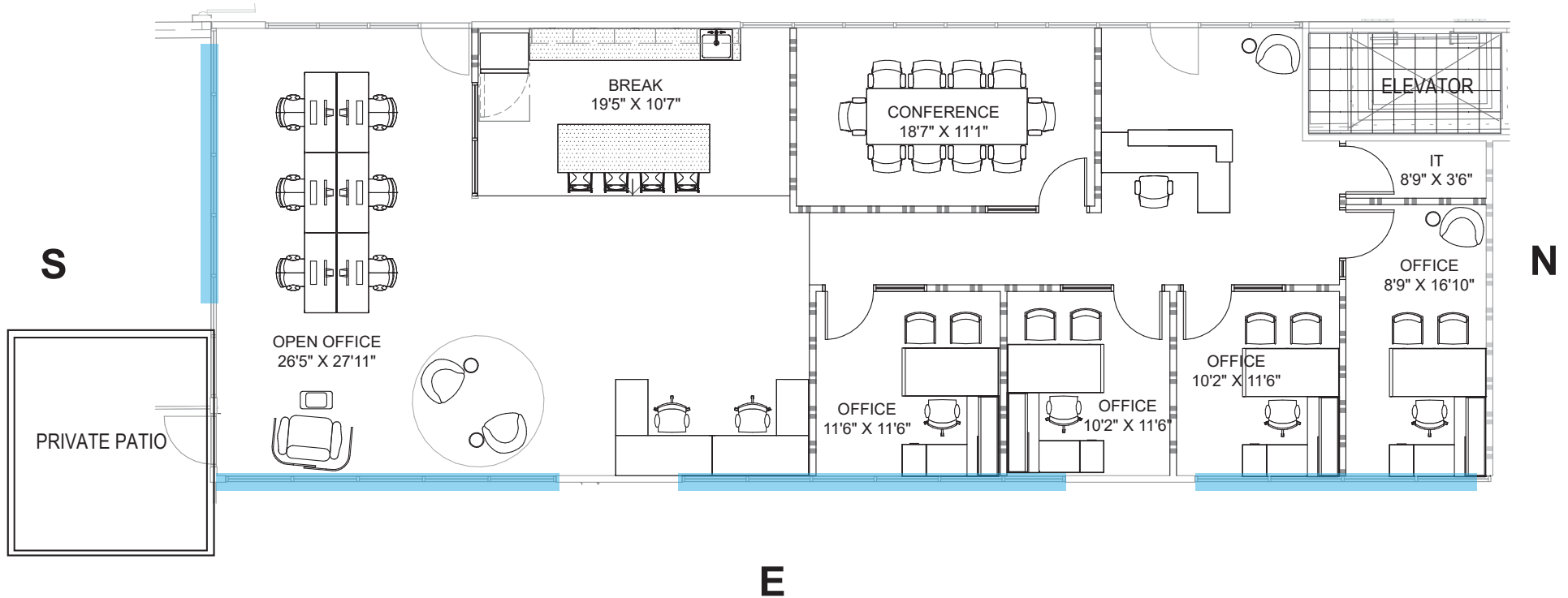

NOTE: ASKING RATE DOES NOT APPLY TO OPTIONAL FLOOR PLAN

NOT TO SCALE

All information furnished regarding property for sale, rental or financing is from sources deemed reliable, but no warranty or representation is made to the accuracy thereof and same is submitted to errors, omissions, change of price, rental or other conditions, prior to sale, lease or financing or withdrawal without notice. No liability of any kind is to be imposed on the broker herein. This information has been secured from sources deemed reliable, however, we make no warranties as to its accuracy.



EXTERIOR PHOTOS

7345 E ACOMA DRIVE • SUITE 305 • SCOTTSDALE AZ 85260



All information contained herein is subject to prior sales and leasing. This information has been secured from sources we believe to be reliable, but we make no representation or warranties, expressed or implied, as to the accuracy of this information.

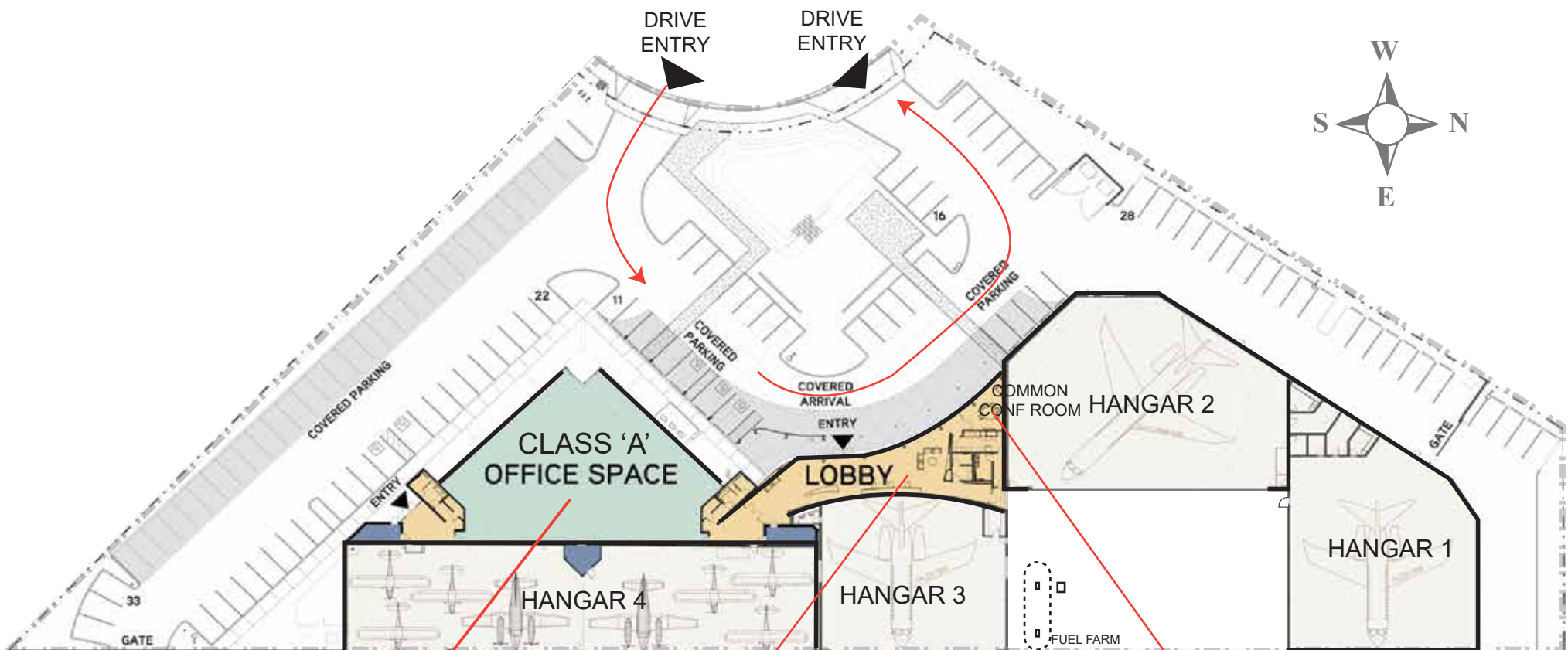

← RUNWAY ACCESS →



7345 E ACOMA DRIVE • SUITE 305 • SCOTTSDALE AZ 85260

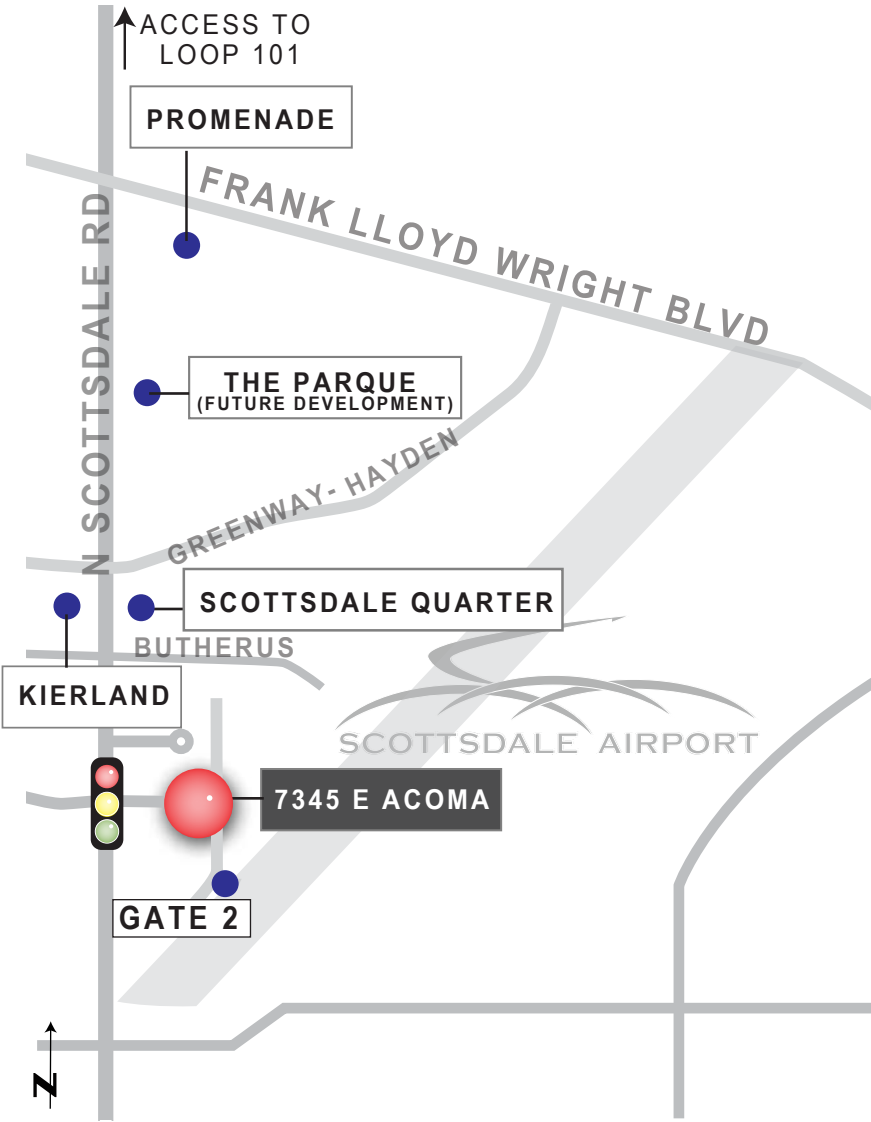

KIERLAND COMMONS



SCOTTSDALE AIRPORT



SCOTTSDALE QUARTER