

FOR LEASE

Airport Park

6105-6113 NE 92nd Dr., Bldg 1, Portland, OR 97220

Tom Knecht, SIOR

Vice President
+1 503 499 0069
tom.knecht@colliers.com

Jerry Matson, SIOR, MBA

Vice Chairman
+1 503 499 0077
jerry.matson@colliers.com

Brian Yoakum, SIOR

Senior Vice President
+1 503 499 0070
brian.yoakum@colliers.com



Airport Way Industrial Park

6105-6113 NE 92ND DR, PORTLAND, OR

Leasing Opportunity | ±10,000 SF Industrial Space Available

Distribution/Logistics/Warehousing

Centrally located in the Airport Way/East Columbia Corridor submarket.

FOR LEASE

Call Brokers for Pricing

Airport Way/East Columbia Corridor:

The Airport Way / North Columbia Corridor is Portland's most established logistics and industrial hub, defined by its unparalleled transportation access and concentration of high-quality corporate occupiers (Amazon, UPS, Boeing, Costco, Home Depot and more). Direct connections to Interstates 84 and 205, immediate proximity to Portland International Airport, and convenient routes to the Port of Portland have made this submarket a vital gateway for regional, national, and international distribution. Not only is the submarket supported by one of the region's deepest labor pools, with nearly two million people living within a 30-mile radius, it also provides seamless transportation access and the advantage of operating within a well-established ecosystem of leading corporate neighbors.

Property Details

Total Building SF	±20,000
Available Space	±9,950
Warehouse SF	±6,750
Office SF	±3,200 SF finished office space
Construction	Concrete
Ceiling Height	20'
Dock Doors	2 doors
Grade Doors	1 doors
Power	200a, 480 volt, 3 phase
Auto Parking	10 stalls
Management	Professionally managed and well-maintained building
Available	September 1, 2026

Floor Plan

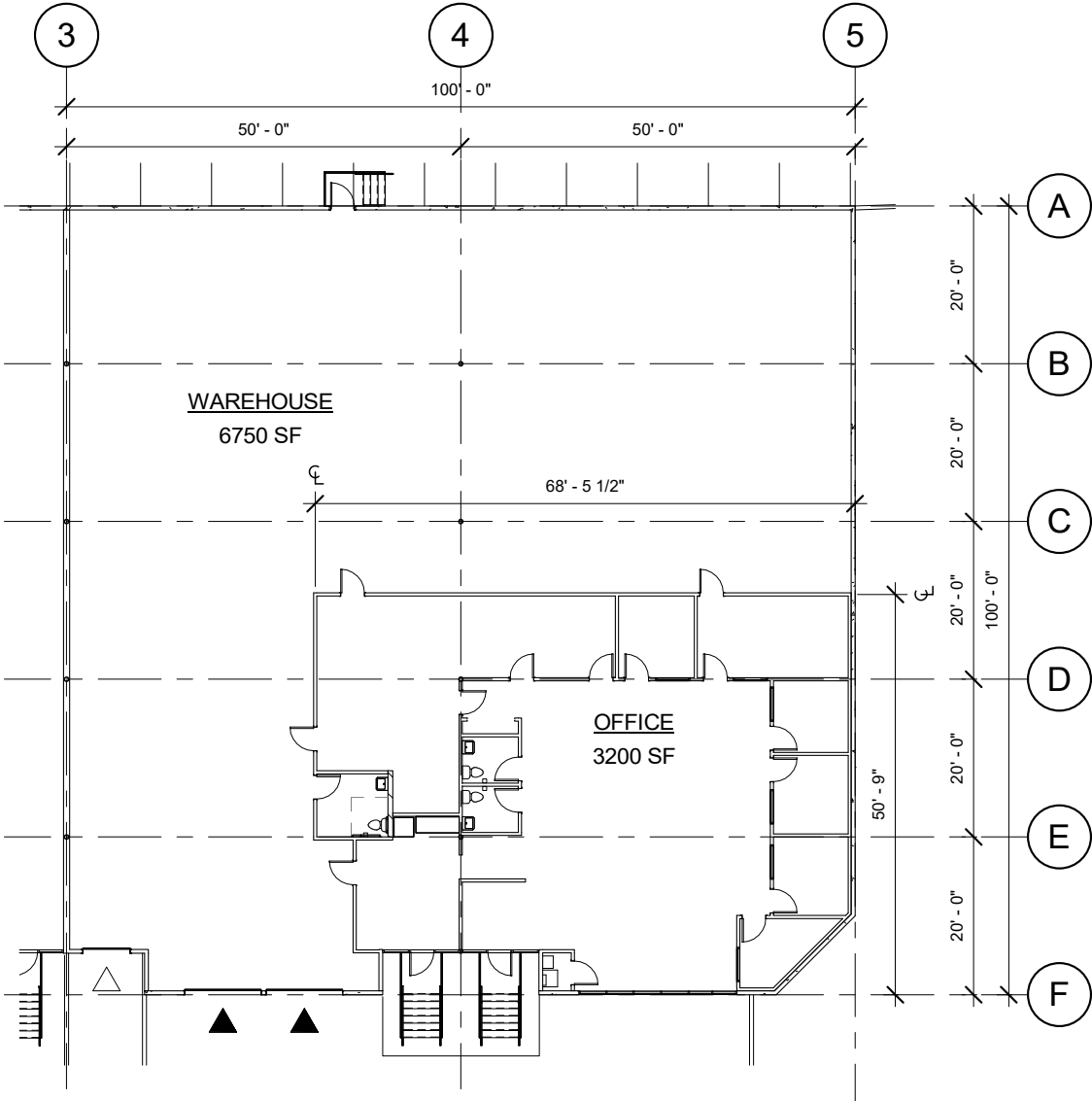

Property Highlights

- Flexible I-G2 zoning allows for a wide variety of general industrial uses.
- Adjacent to Portland International Airport and Cargo facilities
- Excellent corporate neighborhood

±10,000
square feet available

Area Map



Driving Distances

Interstate 205 0.8 miles

Portland Airport 1.5 miles

Interstate 84 2.2 miles

WA State Route 14 2.3 miles

Interstate 5 9.0 miles

Downtown Portland 10.6 miles

Downtown Vancouver 11.1 miles

Tacoma 142 miles

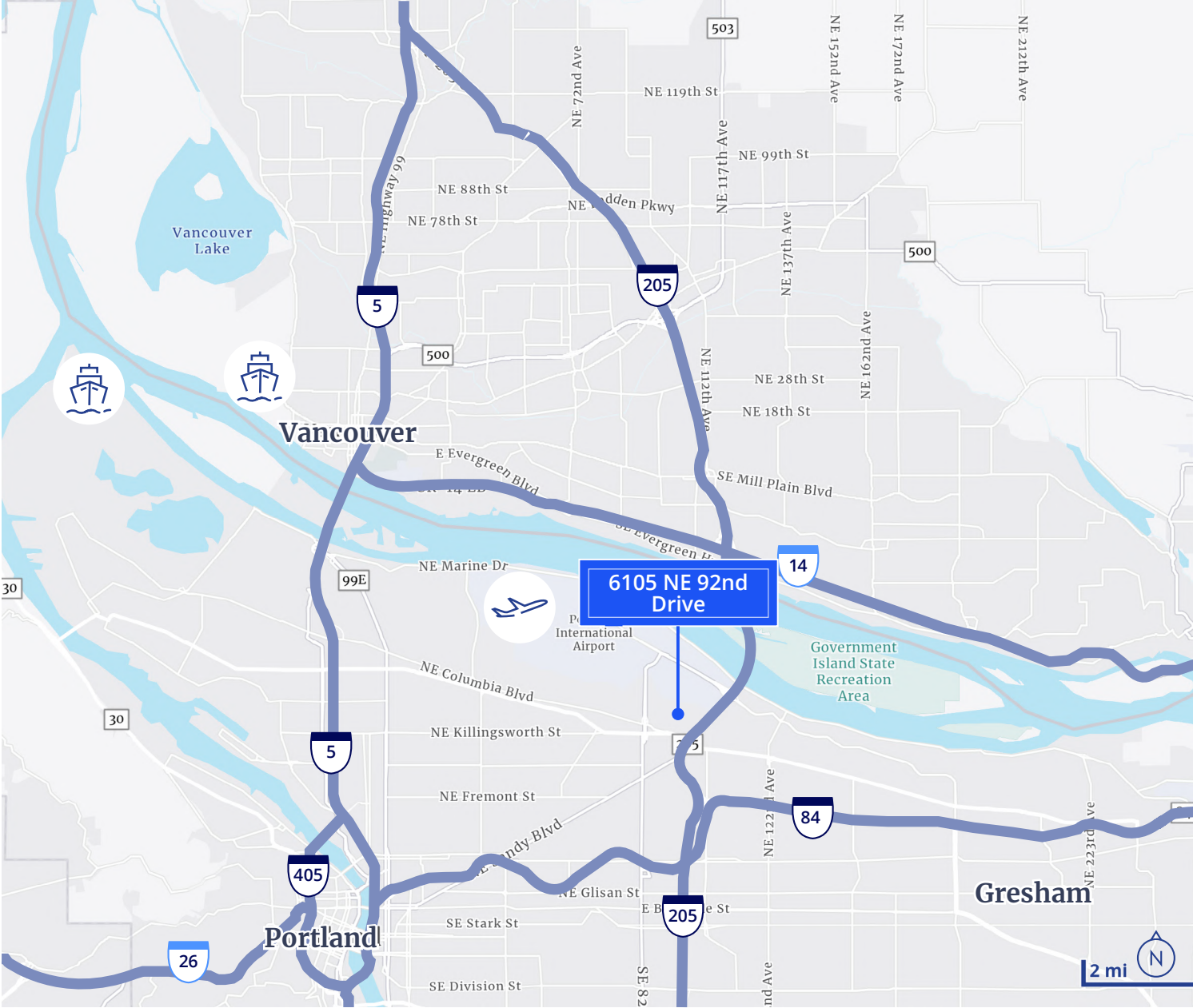



For more information, contact:

Tom Knecht, SIOR

Vice President
+1 503 499 0069
tom.knecht@colliers.com

Jerry Matson, SIOR, MBA

Vice Chairman
+1 503 499 0077
jerry.matson@colliers.com

Brian Yoakum, SIOR

Senior Vice President
+1 503 499 0070
brian.yoakum@colliers.com



Accelerating success.

This document/email has been prepared by Colliers for advertising and general information only. Colliers makes no guarantees, representations or warranties of any kind, expressed or implied, regarding the information including, but not limited to, warranties of content, accuracy and reliability. Any interested party should undertake their own inquiries as to the accuracy of the information. Colliers excludes unequivocally all inferred or implied terms, conditions and warranties arising out of this document and excludes all liability for loss and damages arising there from. This publication is the copyrighted property of Colliers and /or its licensor(s). © 2025. All rights reserved. This communication is not intended to cause or induce breach of an existing listing agreement. Colliers International OR LLC.