



KATY BUILDING

701 COMMERCE STREET
DALLAS, TX



EXPANSIVE
workspace

TEAM SUITE 400C

\$2699/MONTH

AVERAGE \$150/PERSON
ACCOMODATES HEADCOUNT OF UP TO 18

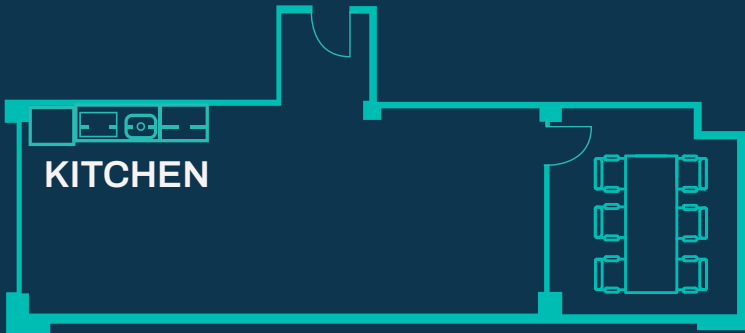

1259 SQUARE FEET OF PRIVATE SPACE
PLUS 3000+SF OF SHARED WORKSPACE,
COWORKING LOUNGE, KITCHEN, PHONE
BOOTH & MORE

SOLUTION INCLUDES:



FULLY
FURNISHED



DIRECT FIBER
INTERNET &
WIFI ACCESS



EXPANSIVE
LOUNGE



COFFEE &
TEA



24/7 ACCESS



ON-SITE
MGMT



HIGH SPEED
PRINTERS



UTILITIES



MOTHERS'
ROOM



COMMUNITY
APP



BIKE ROOM



NETWORK
ACCESS

**EXPLORE OUR AVAILABLE
TEAM SUITE OPTIONS TODAY!**

CONTACT BRENNAN WALKER

469.461.4196 | brennan.walker@expansive.com