

AVAILABLE

2910 N. 30th Avenue 12,000 Sq. Ft.

Features:

- Located just min. from I-10 & I-17 freeways
- 1,500 sq. ft. a/c office area (Rec/showroom, three offices, breakroom, & 4 restrooms).
- Additional 1,300 s.f. floor to deck a/c room.
- Freestanding building/with approximately 8,000 s.f. fenced secured yard area.
- 10,500 sq. ft. +/- evap cooled warehouse
- 16' Minimum clear height
- Four (4) 12' x 12' grade doors
- A-2 Zoning, City of Phoenix
- 400 amps, 120/208 volt, 3 phase power
- Building Signage
- **Competitive Gross Rental Rates**

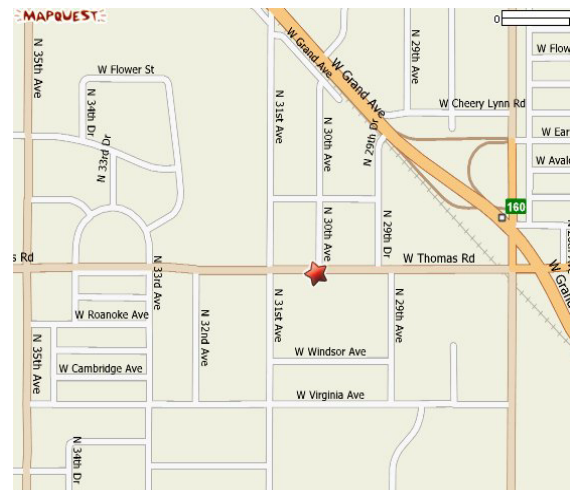

**Arizona
Industrial
Properties**

5100 N. 40th Street
Phoenix, Arizona 85018
(602) 438-8000
(602) 438-7940 fax
www.azindprop.com

For More Information Contact:

Randy S. Warner
(602) 438-8000

randy@azindprop.com

No CAM's

The information contained herein has been obtained from sources we deem reliable. However, no warranties or representations, expressed or implied, are made as to the accuracy of any information contained herein, and the information is subject to errors and omissions. This information is also subject to change of price, rental or other conditions, withdrawal without notice, and to any special listing conditions imposed by our principals.

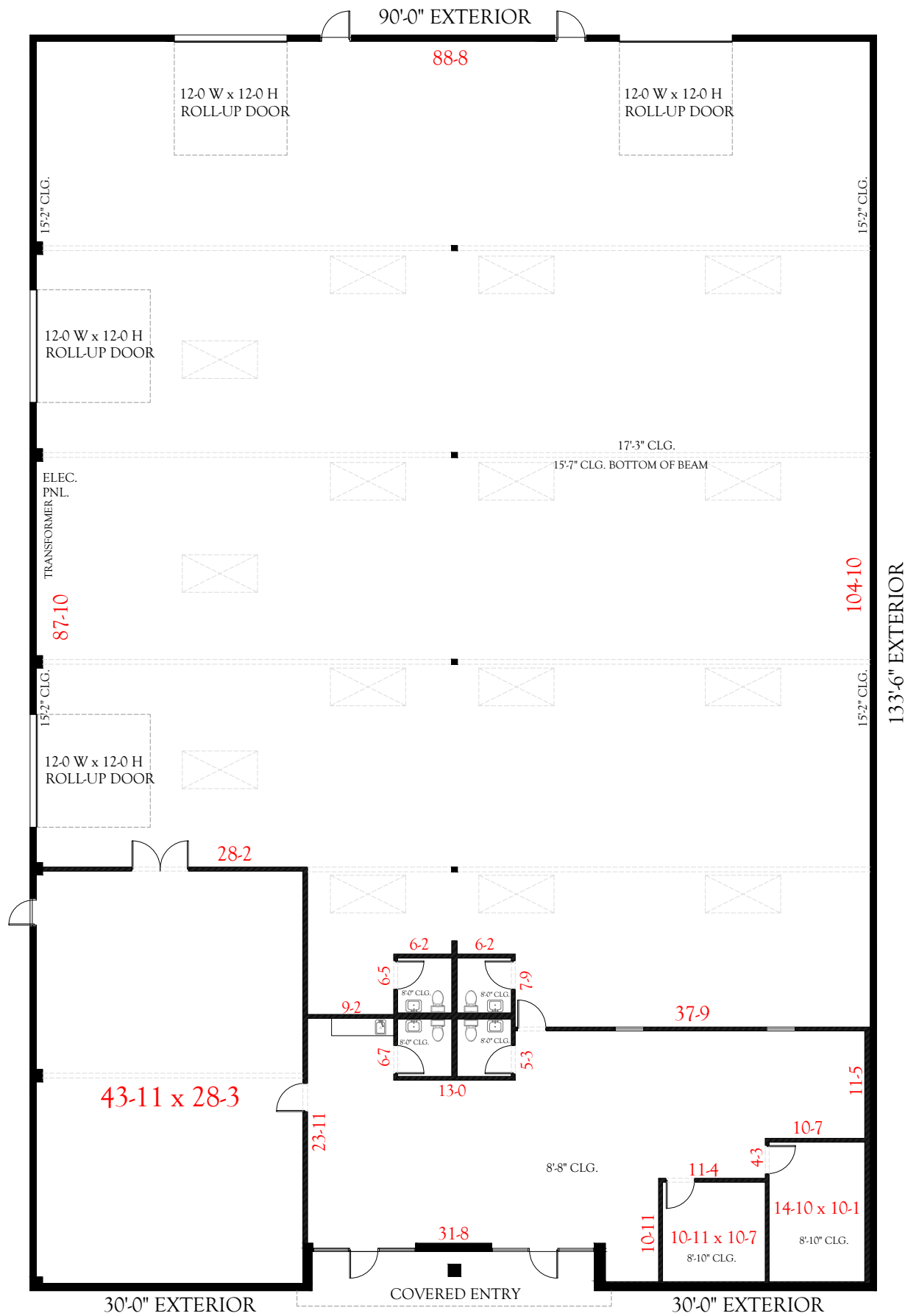

TOTAL SF: 12,000

2910 N. 30th Avenue
Phoenix, Arizona 85017



Randy S. Warner
randy@azindprop.com

602.438.8000 (office)
602.438.7832 (direct)
602.438.7040 (fax)
602.882.6666 (cell)

W. CATALINA DRIVE



N. 30th AVENUE

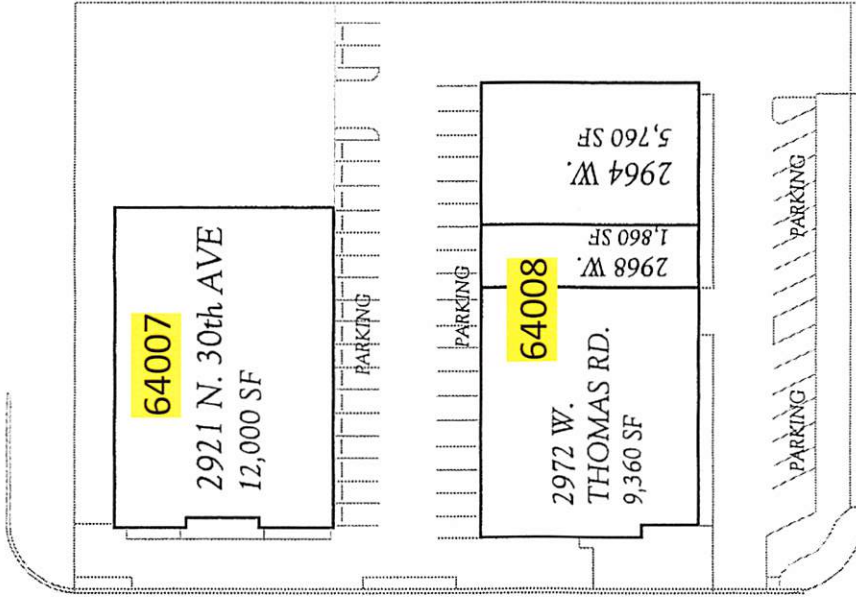

W. THOMAS ROAD

NOT TO SCALE