

# 8,640 SF AVAILABLE

7275 Appling Farms Pkwy  
Memphis, TN 38133  
[www.cbre.com/memphis](http://www.cbre.com/memphis)



## PROPERTY INFO

- + Entire 2nd Floor available for sublease, approximately 8,640 SF (excludes +/- 150K SF LAN/phone room)
- + Prime location in Northeast Submarket with access from two exits along I40 - Daily Traffic count over 100,000
- + 2-story 17,500 SF Building
- + Built in 2011
- + 202 parking spaces
- + Rate: Negotiable



2nd Floor

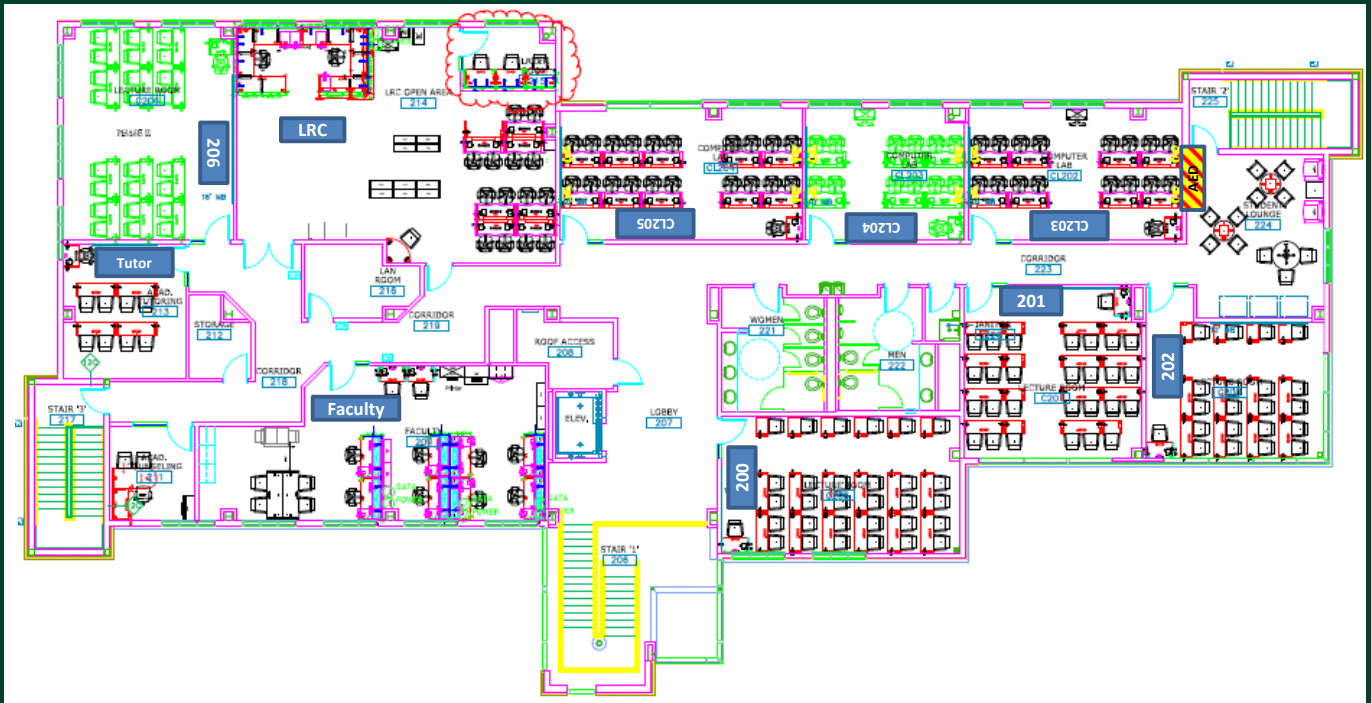

## Contact Us

**Patrick Reilly**  
First Vice President  
+1 901 260 1054  
patrick.reilly@cbre.com

© 2022 CBRE, Inc. All rights reserved. This information has been obtained from sources believed reliable, but has not been verified for accuracy or completeness. You should conduct a careful, independent investigation of the property and verify all information. Any reliance on this information is solely at your own risk. CBRE and the CBRE logo are service marks of CBRE, Inc. All other marks displayed on this document are the property of their respective owners, and the use of such logos does not imply any affiliation with or endorsement of CBRE. Photos herein are the property of their respective owners. Use of these images without the express written consent of the owner is prohibited.