

BUILDINGS B, C, D & E

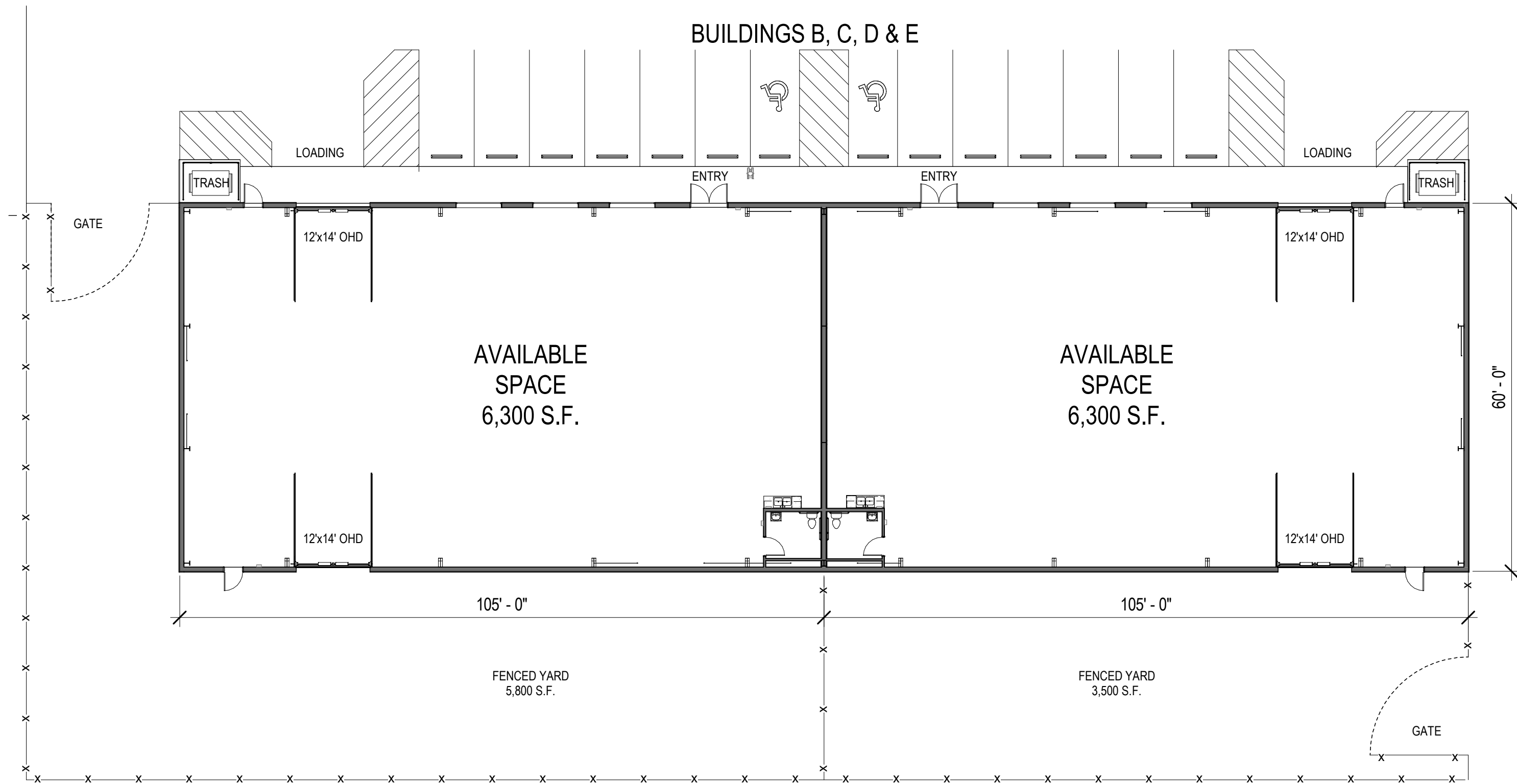

TRASH

LOADING

LOADING

TRASH

ENTRY

ENTRY

12x14' OHD

12x14' OHD

AVAILABLE SPACE
6,300 S.F.

AVAILABLE SPACE
6,300 S.F.

12x14' OHD

12x14' OHD

105' - 0"

105' - 0"

60' - 0"

FENCED YARD
5,800 S.F.

FENCED YARD
3,500 S.F.

GATE

GATE