

# FOR LEASE

5722 BUCKINGHAM DRIVE, HUNTINGTON BEACH

±10,675 SF FREESTANDING INDUSTRIAL BUILDING



## PROPERTY FEATURES

- ±10,675 SF Two-Story Industrial Building
- ±21,617 SF Parcel (0.50 AC)
- ±7,939 SF of Two-Story Office
- 400 Amps - Tenant to Verify
- ±22' Ceiling Height
- 1 GL Door (10' x 12')
- 29 Parking Stalls (2.72:1,000 Parking Ratio)
- Easy Access to 405, 22 & 605 Freeways
- **Asking Lease Rate: \$1.08 NNN + \$0.22 Nets**

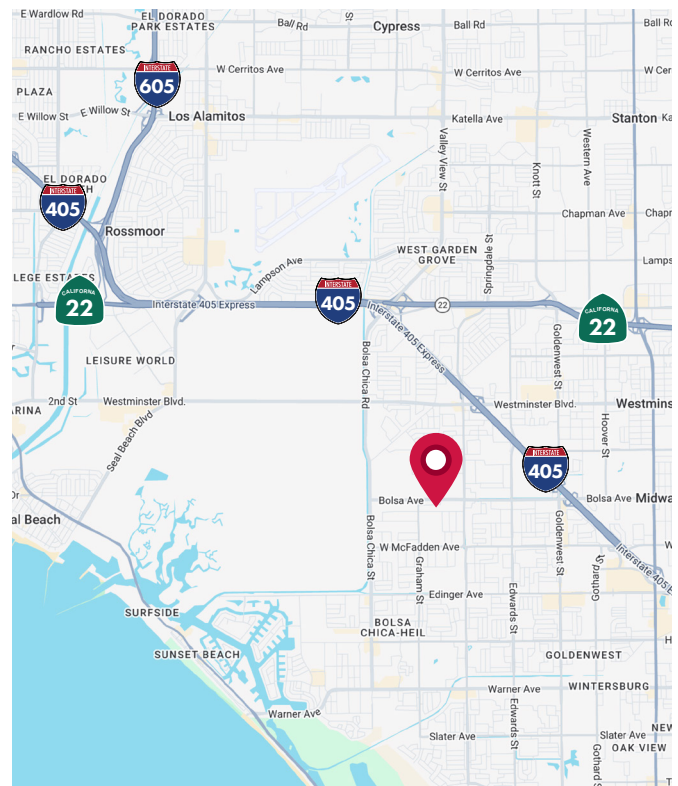

DALE CAMERA  
Senior Vice President  
License ID# 01313921  
949.790.3132  
dcamera@leeirvine.com

JASON HELMICK  
Senior Vice President  
License ID# 01786729  
949.790.3119  
jhelmick@leeirvine.com

ZACH SCHWANER  
Senior Vice President  
License ID# 02009623  
949.790.3159  
zschwaner@leeirvine.com

DYLAN DAVEY  
Associate  
License ID# 02219560  
949.790.3162  
ddavey@leeirvine.com

**LEE & ASSOCIATES**  
COMMERCIAL REAL ESTATE SERVICES

**ORANGE COUNTY INDUSTRIAL**

# FOR LEASE

5722 BUCKINGHAM DRIVE, HUNTINGTON BEACH

±10,675 SF FREESTANDING INDUSTRIAL BUILDING

## SITE PLAN

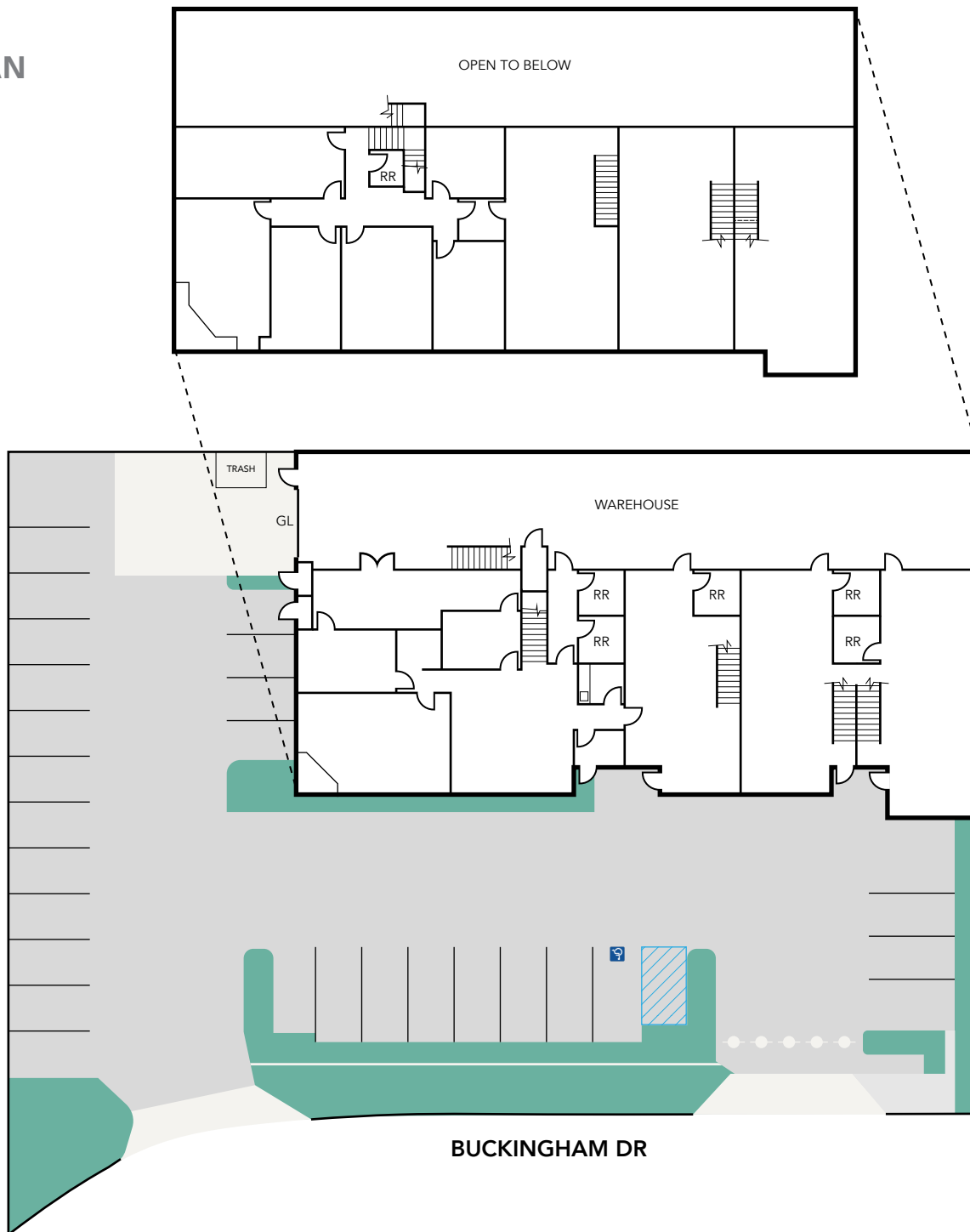

**DALE CAMERA**  
Senior Vice President  
License ID# 01313921  
949.790.3132  
dcamera@leeirvine.com

**JASON HELMICK**  
Senior Vice President  
License ID# 01786729  
949.790.3119  
jhelmick@leeirvine.com

**ZACH SCHWANER**  
Senior Vice President  
License ID# 02009623  
949.790.3159  
zschwaner@leeirvine.com

**DYLAN DAVEY**  
Associate  
License ID# 02219560  
949.790.3162  
ddavey@leeirvine.com

**LEE & ASSOCIATES**  
COMMERCIAL REAL ESTATE SERVICES

**ORANGE COUNTY INDUSTRIAL**

# FOR LEASE

5722 BUCKINGHAM DRIVE, HUNTINGTON BEACH

±10,675 SF FREESTANDING INDUSTRIAL BUILDING



**DALE CAMERA**  
Senior Vice President  
License ID# 01313921  
949.790.3132  
dcamera@leeirvine.com

**JASON HELMICK**  
Senior Vice President  
License ID# 01786729  
949.790.3119  
jhelmick@leeirvine.com

**ZACH SCHWANER**  
Senior Vice President  
License ID# 02009623  
949.790.3159  
zschwaner@leeirvine.com

**DYLAN DAVEY**  
Associate  
License ID# 02219560  
949.790.3162  
ddavey@leeirvine.com

