



KOKO MARINA CENTER

*Make life fun!*

 **SOFOS REALTY**  
CORPORATION  
Commercial Brokerage • Property Management

# PROPERTY HIGHLIGHT

- EAST OAHU'S PREMIERE SHOPPING CENTER
- OVER 2 MILLION VISITORS ANNUALLY
- GATHERING PLACE FOR BOTH LOCAL AND VISITORS
- EASY ACCESS FROM KALANIANA'OLE HWY AND CLOSE TO HANAUMA BAY



Kahuku •

Laie •

• Haleiwa

Wahiawa  
•

• Makaha

Waipahu Pearl City  
•

Aiea  
•

Kaneohe  
•

Kapolei  
•

Ewa Beach  
•

**Koko Marina Center**

Honolulu  
•

## PROPERTY HIGHLIGHT

Location:	Hawaii Kai
Land Area:	~16.748 AC
Gross Leasable Area:	~277,420 SF
Zoning:	B-2 Community Business
Base Rent:	Negotiable Ground lease applies the following January
Percentage Rent:	8% over natural breakpoint
Restaurant Spaces:	Negotiable
CAM:	\$0.90 / SF
Real Property Taxes:	\$0.32 / SF
Promotional Fee:	\$0.16 / SF
Parking:	Ample parking available

## PROPERTY FEATURES

- *Great frontage along main highway*
- *Retail and entertainment center*
- *Excellent visibility*
- *Limited competition*

## TRAFFIC COUNTS

Kalaniana'ole Highway/Portlock RD: ~34,601 VPD

## DEMOGRAPHICS

Source: CoStar	1 Mile	3 Mile
Population:	12,186	38,010
Total Households:	4,431	13,336
Avg. Household Income:	\$159,520	\$155,368

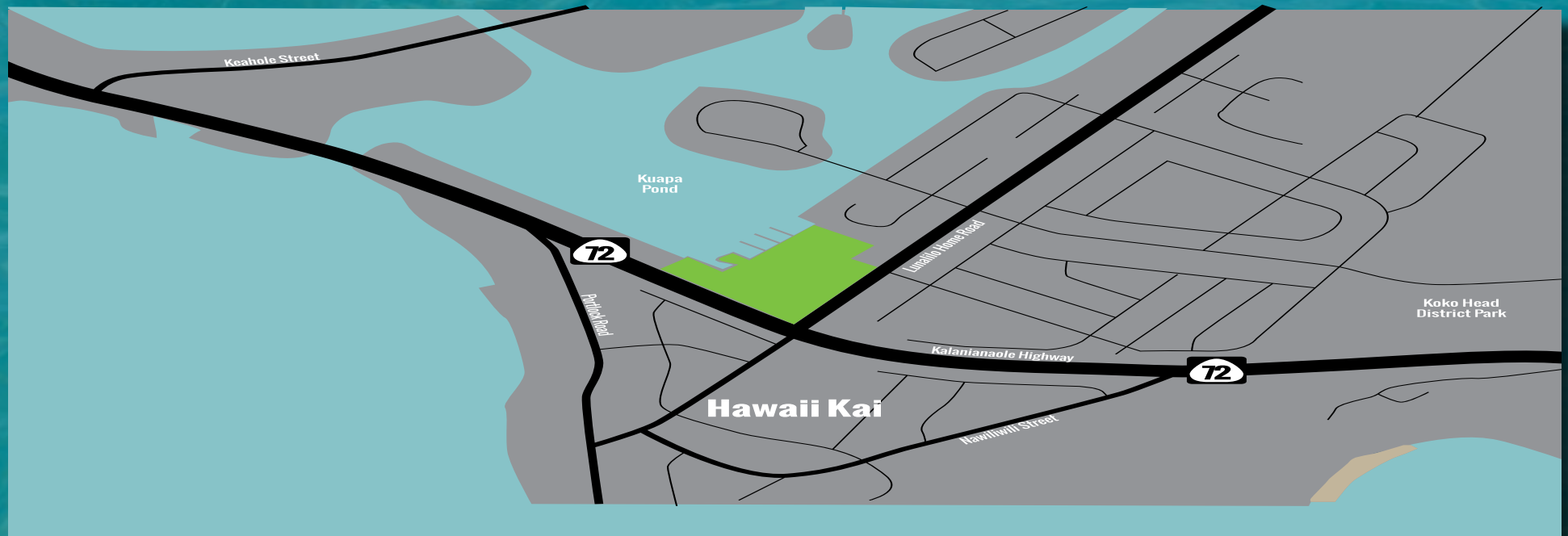

# SITE PLAN

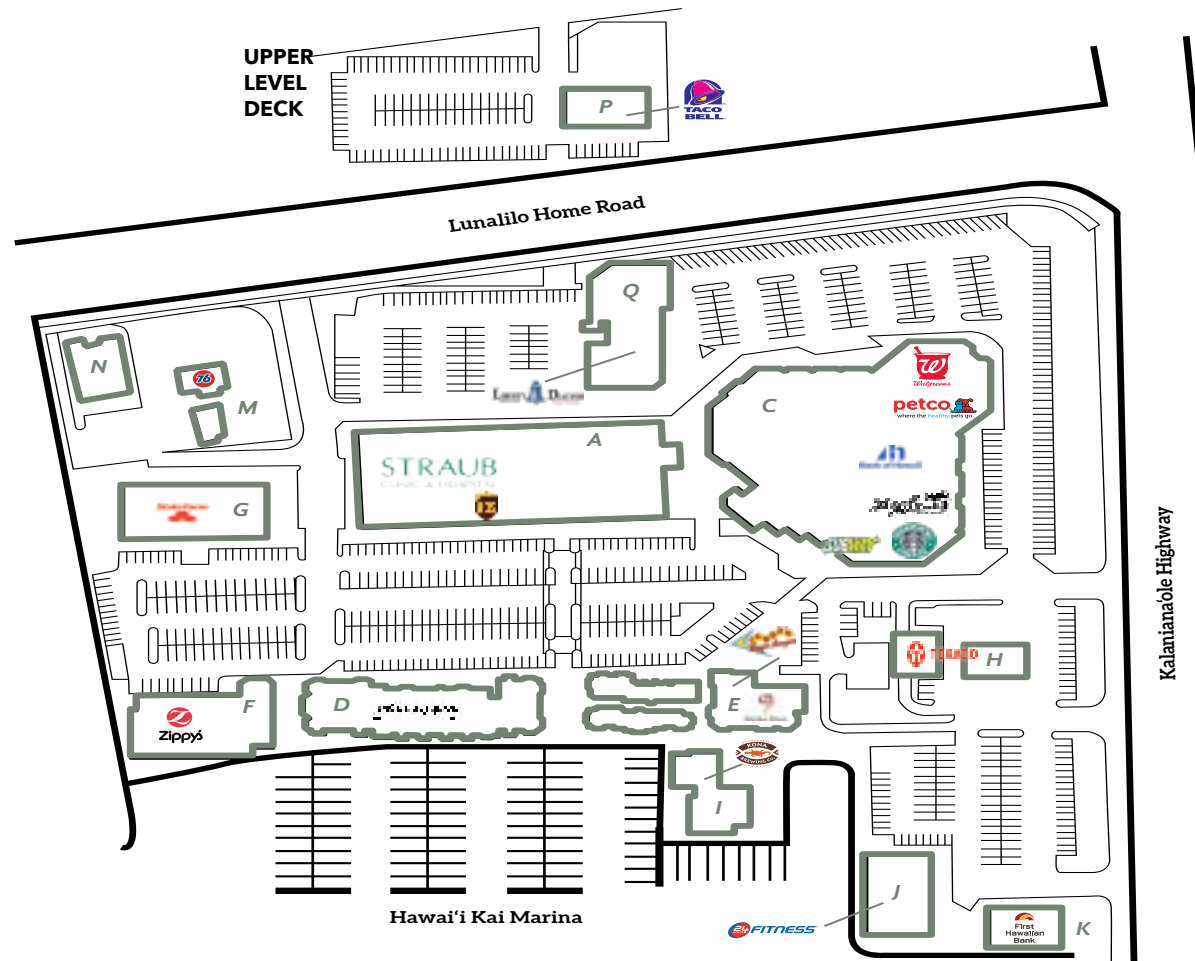

# SITE PLAN with AVAILABLE SPACE



**KOKO MARINA CENTER**

*Make life fun!*

## BLDG N

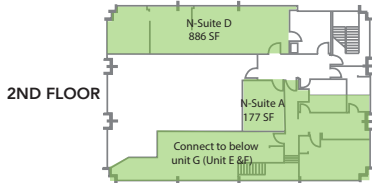
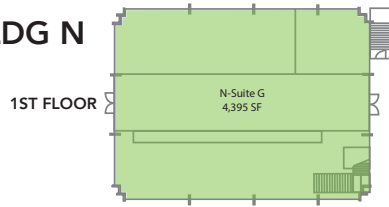

## BLDG G

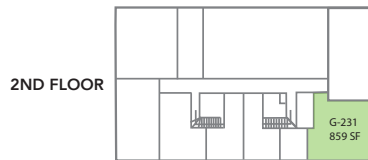
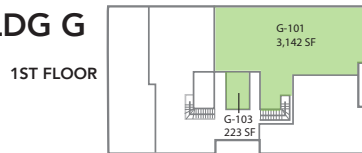

## BLDG D

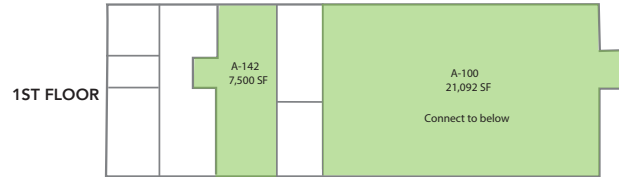

## BLDG A

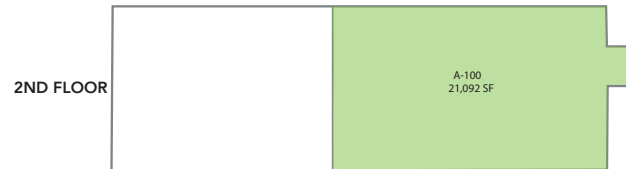

## BLDG Q

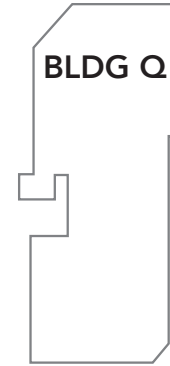

## BLDG C



## BLDG E



The spaces currently available for lease are indicated in green.





**Nora Bland (S)**

Senior Vice President

RS-65997

(808) 522-5967

[nbland@sofosrealty.com](mailto:nbland@sofosrealty.com)

©2026 Sofos Realty Corporation. All information contained herein is obtained from sources deemed reliable. However, no representations or guarantees are made as to the accuracy thereof, and it is provided herein subject to errors, omissions, changes and withdrawals without notice. Offeror and/or his agent should confirm this information prior to making any offer. Buyer agrees that all negotiation shall be conducted through Sofos Realty Corporation only. No subagency is offered or intended.

 **SOFOS REALTY**  
CORPORATION  
Commercial Brokerage • Property Management