

INDUSTRIAL SPACE AVAILABLE

9700 Martin Luther King Jr. Highway, Lanham, MD 20706
Prince George's County

**80% Warehouse End Cap;
2 Docks and Ramped Drive-In**



FOR SUBLEASE

AVAILABLE FOR SUBLEASE

► 8,642 SF End-Cap

- **Loading:** Three (3) docks (one ramped)
- **Ceiling Height:** 16'9" clear throughout
- **Column Spacing:** 40' x 40'

- **Sublease Term:** Through 4/30/2027;
(Additional term can be requested)
- **Rate:** \$13.00 PSF, NNN

OWNED & MANAGED BY:
 **LONGPOINT**
BUILT FOR MOVEMENT

Spence Daw, SIOR
sdaw@klnb.com
443-574-1429

9881 Broken Land Parkway, #300
Columbia, MD 21046
klnb.com

NAIklnb

INDUSTRIAL SPACE AVAILABLE

9700 Martin Luther King Jr. Highway, Lanham, MD 20706
Prince George's County

8,642 SF
AVAILABLE

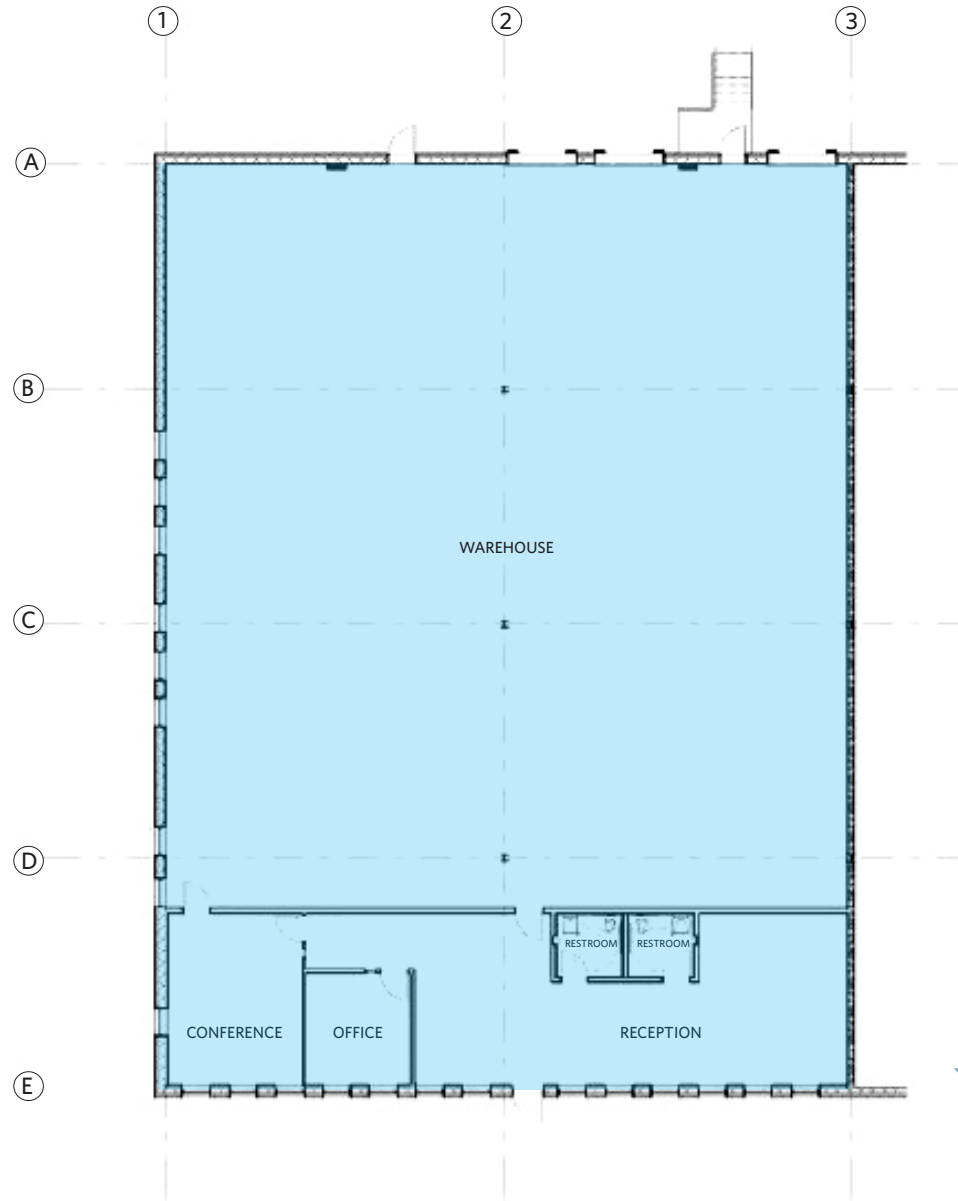

FLOOR PLAN

INDUSTRIAL SPACE AVAILABLE

9700 Martin Luther King Jr. Highway, Lanham, MD 20706
Prince George's County

TRUCK COURT

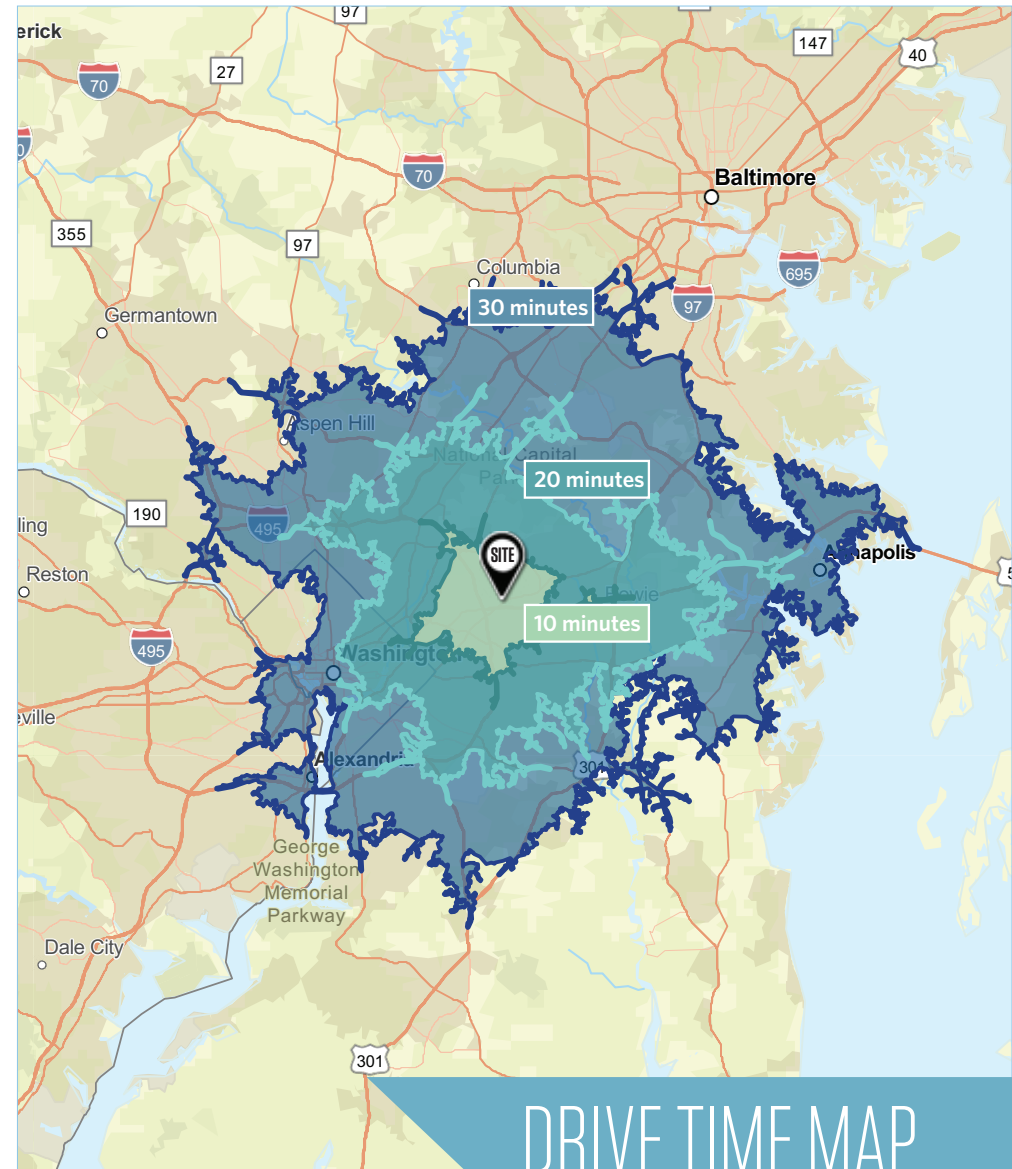

DRIVE TIME MAP

Contact
Information:

Spence Daw, SIOR
sdaw@klnb.com
443-574-1429

9881 Broken Land Parkway, #300
Columbia, MD 21046
klnb.com

NAklnb