

# Greyfern II

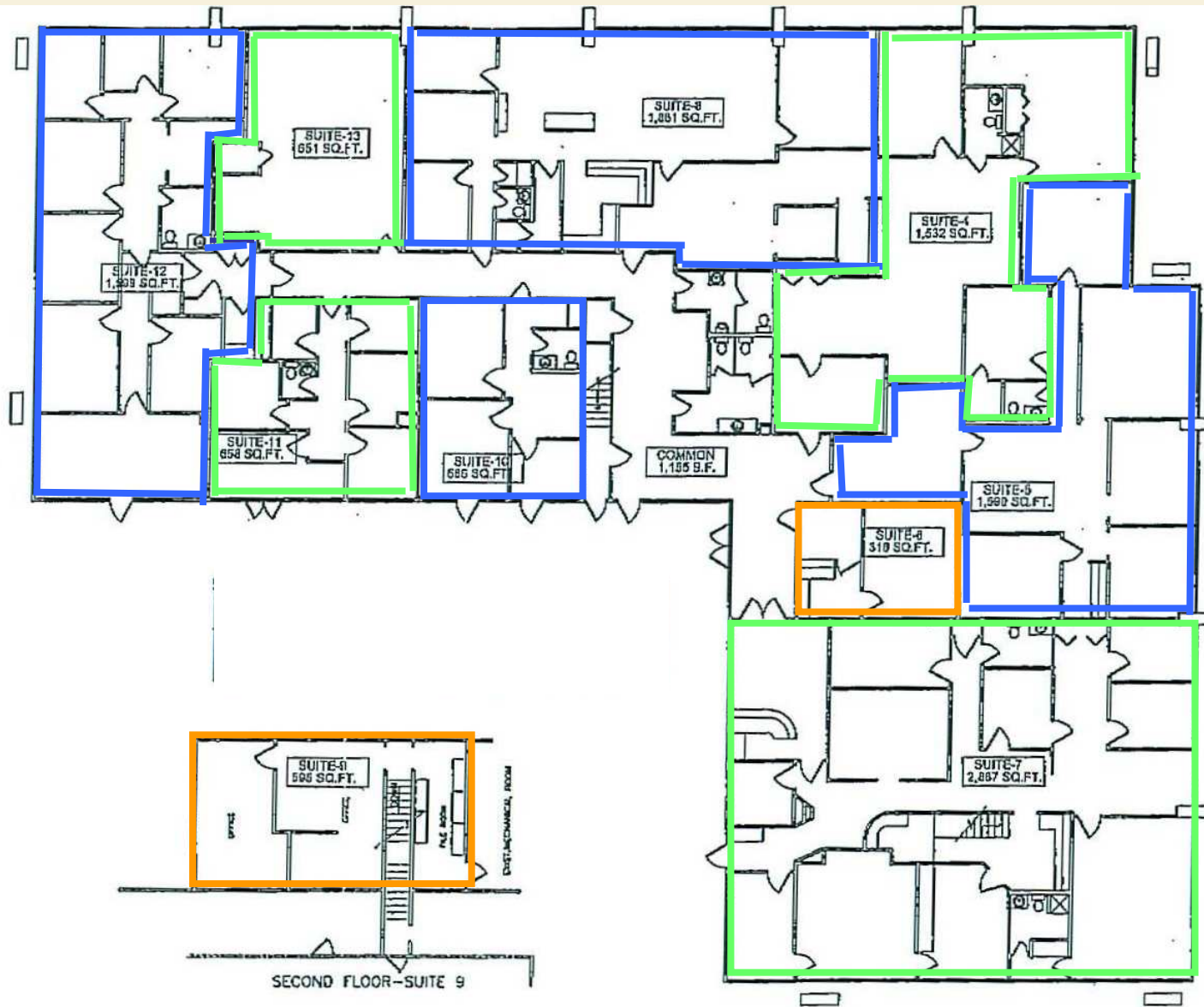

SUITE NO.	LEASED AREA
4	1,532 S.F.
5	1,590 S.F.
6	316 S.F.
7	2,887 S.F.
8	1,881 S.F.
9	596 S.F.
10	566 S.F.
11	658 S.F.
12	1,599 S.F.
13	651 S.F.
COMMON	1,155 S.F.
<b>BLDG TOTAL</b>	<b>13,430 S.F.</b>