

Industrial Flex Space Available

For Lease | 2595 Center Road, Hinckley, Ohio 44233



CUSHMAN &
WAKEFIELD

CRESCO
Real Estate

2595 Center Road

- Located within a well-maintained industrial complex with excellent access to I-71
- The condo unit features multiple private offices, a conference room, kitchenette, and shop space with drive-in doors
- Low condo fees with an active association!
- Neighbors include the ALDI distribution center, multiple car dealerships, 1st Day School Supplies, and Advance Auto Parts
- Within minutes of multiple service, lodging, dining, and shopping amenities

Lease Rate: \$10.00/SF NNN (NNN: \$2.90/SF)



Quick Stats

| | |
|----------------|------------------------------------|
| Building Size | 51,959 SF |
| Year Built | 2002 |
| Zoning | I-2 Light Manufacturing/Industrial |
| Clear Height | 18' |
| Drive-In Doors | Two (2) 8'x12' & 10'x14' |
| Lighting | Fluorescent & Metal Halide |
| Heat | HVAC |
| Sprinkler | Wet |

Floor Plan

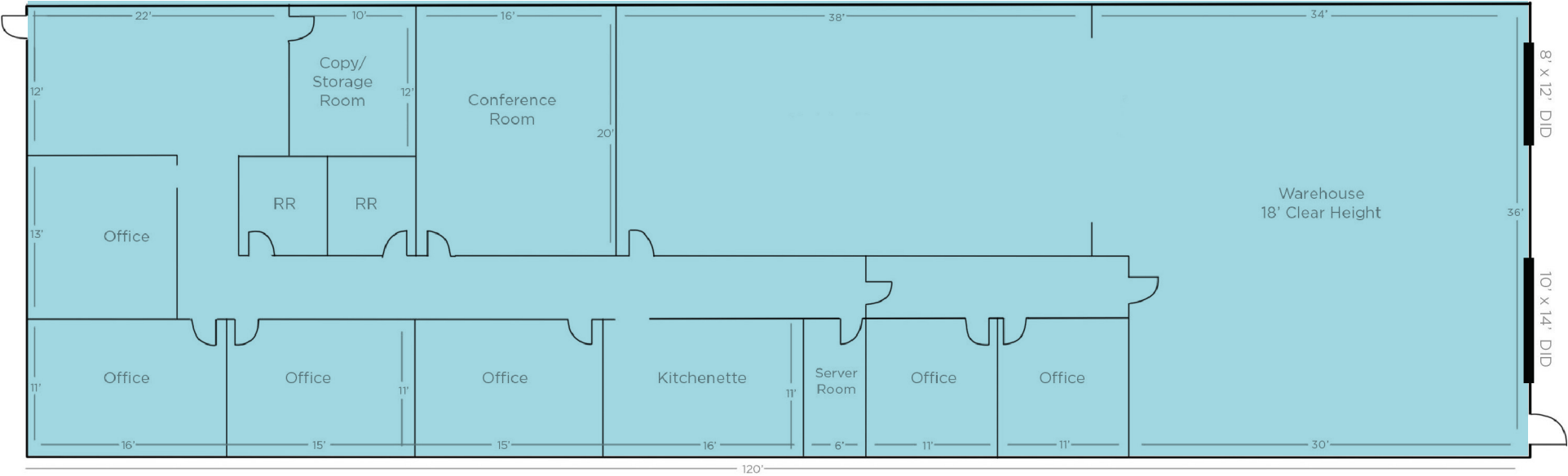

Availability

| | | |
|--------------------|-----------|--------------|
| Total Availability | Office SF | Warehouse SF |
| 4,320 SF | 2,400 SF | 1,920 SF |

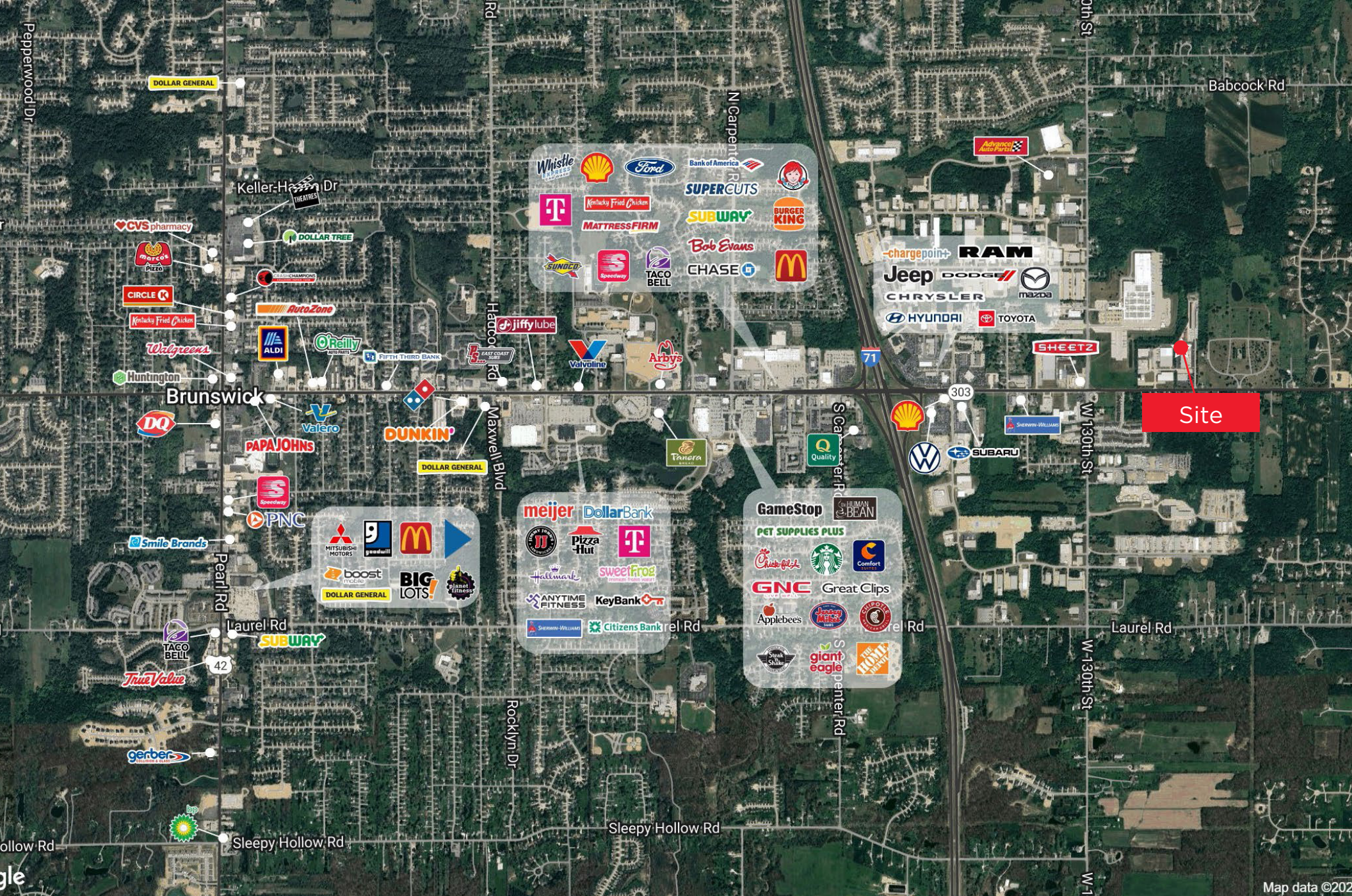

75,541

Population
(2025 | 5 Mile)

43.6

Median Age
(2025 | 5 Mile)

30,022

Households
(2025 | 5 Mile)

\$135,633

Household Income
(2025 | 5 Mile)

2,136

Total Businesses
(2025 | 5 Mile)

16,435

Total Employees
(2025 | 5 Mile)



**2595 CENTER ROAD
HINCKLEY, OHIO 44233**

COLE SORENSON

Associate

+1 216 525 1470

csorenson@crescorealestate.com

BOB GARBER, SIOR

Executive Vice President & Partner Emeritus

+1 216 525 1467

bgarber@crescorealestate.com



Cushman & Wakefield | CRESCO
6100 Rockside Woods Blvd, Suite 200
Cleveland, Ohio 44131

crescorealestate.com

©2025 Cushman & Wakefield. All rights reserved. The information contained in this communication is strictly confidential. This information has been obtained from sources believed to be reliable but has not been verified. NO WARRANTY OR REPRESENTATION, EXPRESS OR IMPLIED, IS MADE AS TO THE CONDITION OF THE PROPERTY (OR PROPERTIES) REFERENCED HEREIN OR AS TO THE ACCURACY OR COMPLETENESS OF THE INFORMATION CONTAINED HEREIN, AND SAME IS SUBMITTED SUBJECT TO ERRORS, OMISSIONS, CHANGE OF PRICE, RENTAL OR OTHER CONDITIONS, WITHDRAWAL WITHOUT NOTICE, AND TO ANY SPECIAL LISTING CONDITIONS IMPOSED BY THE PROPERTY OWNER(S). ANY PROJECTIONS, OPINIONS OR ESTIMATES ARE SUBJECT TO UNCERTAINTY AND DO NOT SIGNIFY CURRENT OR FUTURE PROPERTY PERFORMANCE.