



8,000 - 15,857 SF
SUBLEASE

1835 MARKET ST

PHILADELPHIA, PA

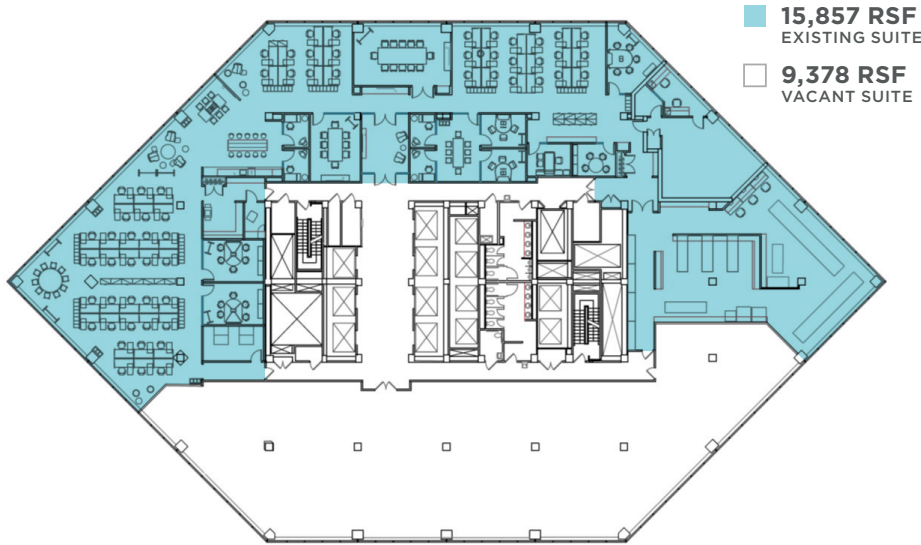

**CUSHMAN &
WAKEFIELD**

Features & Amenities

- On-Site Parking Garage
- Planet Fitness
- Citizens Bank
- Conference Center
- Bike Storage
- FedEx & UPS Drop Boxes
- Newsstand Convenience Store
- TransitScreen



Roger Mcmanimon
Executive Director
 +1 215 963 4049
roger.mcmanimon@cushwake.com

Jack Meyers
Executive Director
 +1 215 963 4054
jack.meyers@cushwake.com

Raquel Perry
Director
 +1 215 963 4070
raquel.perry@cushwake.com

cushmanwakefield.com