

RICHARDSON SERVICE CENTER



860 NORTH DOROTHY DRIVE, SUITE 600 | RICHARDSON, TEXAS 75081

PROPERTY INFORMATION

- 38,339 SF Total
- 15,377 SF Available
- 20' Clear Height
- Parking Ratio: 1.09/1,000 SF
- Year of Construction: 1983

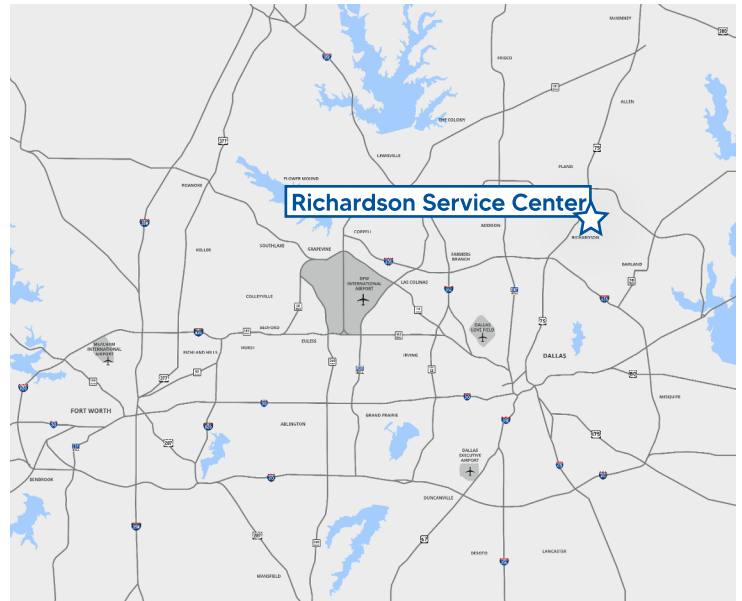

Leased By



Contacts

Josh Barnes, SIOR | 972.280.8353 | jbarnes@holtlunsford.com
Weston Porter | 972.741.6441 | wporter@holtlunsford.com

RICHARDSON SERVICE CENTER

860 NORTH DOROTHY, SUITE 600 | RICHARDSON, TEXAS 75081

SUITE 600 | 15,377 SF FOR LEASE

- 15,377 SF
- 3,200 SF Office
- 12,177 SF Warehouse
- Three (3) Dock High Doors
- One (1) Dock High Door w/ Ramp
- 20' Clear Height

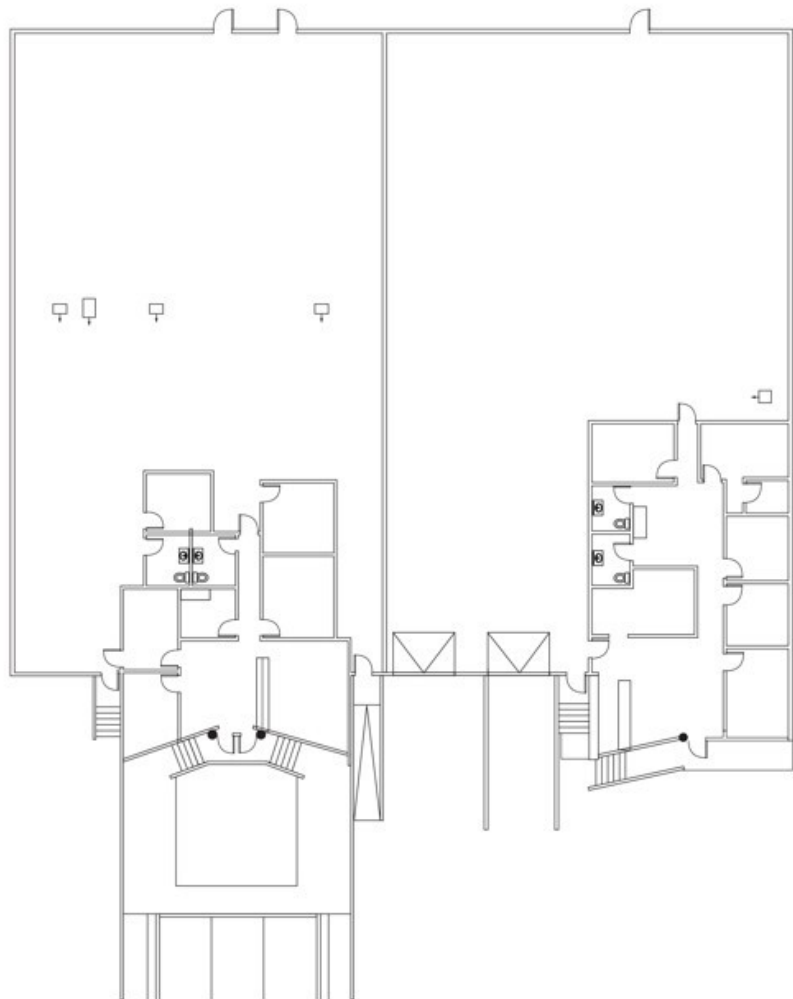

Leased By



Contacts

Josh Barnes, SIOR | 972.280.8353 | jbarnes@holtlunsford.com
Weston Porter | 972.741.6441 | wporter@holtlunsford.com

