

**THE VILLAGE AT SHELBY
NEW RETAIL / OFFICE SPACES
FOR LEASE**



PILOT
PROPERTY GROUP

**1,100 - 23,000 SF NEW BUILDING!
NW CORNER OF 24 MILE AND VAN DYKE
SHELBY TOWNSHIP, MI 48316**

PROPERTY OVERVIEW:

- Brand New Office & Retail being built in the heart of Shelby Twp located next to CVS at the NW corner of 24 & Van Dyke.
- Building will be full service with common areas and elevator.
- Locate your business to first floor retail, or second floor office.
- NNN's are estimated at \$5-\$6/SF
- Contact broker for more info, floor plans, etc.

Property Type:	Office/Retail
Cross Streets:	West side of Van Dyke, North of 24 Mile Road
Total Square Footage:	23,304
Building Name:	The Village at Shelby
Minimum Square Footage:	1,049
Maximum Square Footage:	23,304
Parcel Size:	1.6 Acres
Year Built:	2026
Zoning:	Office/Retail
Construction:	Brick/Block
Parking:	110 spaces +/- (See Plan)
Lease Rate:	\$26/SF
Lease Type:	NNN

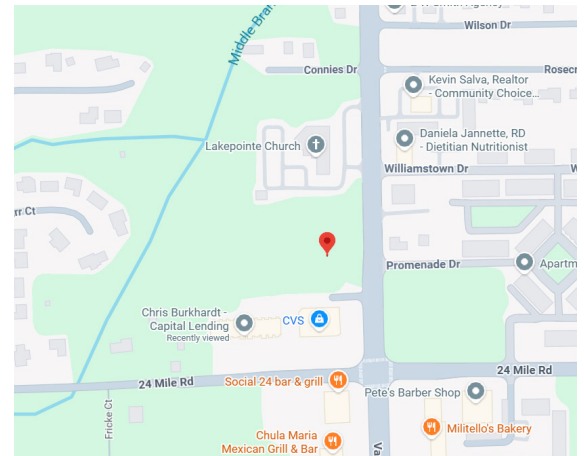

AGENT CONTACT INFO

EVAN JUROVCIK O: 586.254.0900 x108 • C: 586.360.0911 • ejurovcik@gmail.com

SITE PLAN

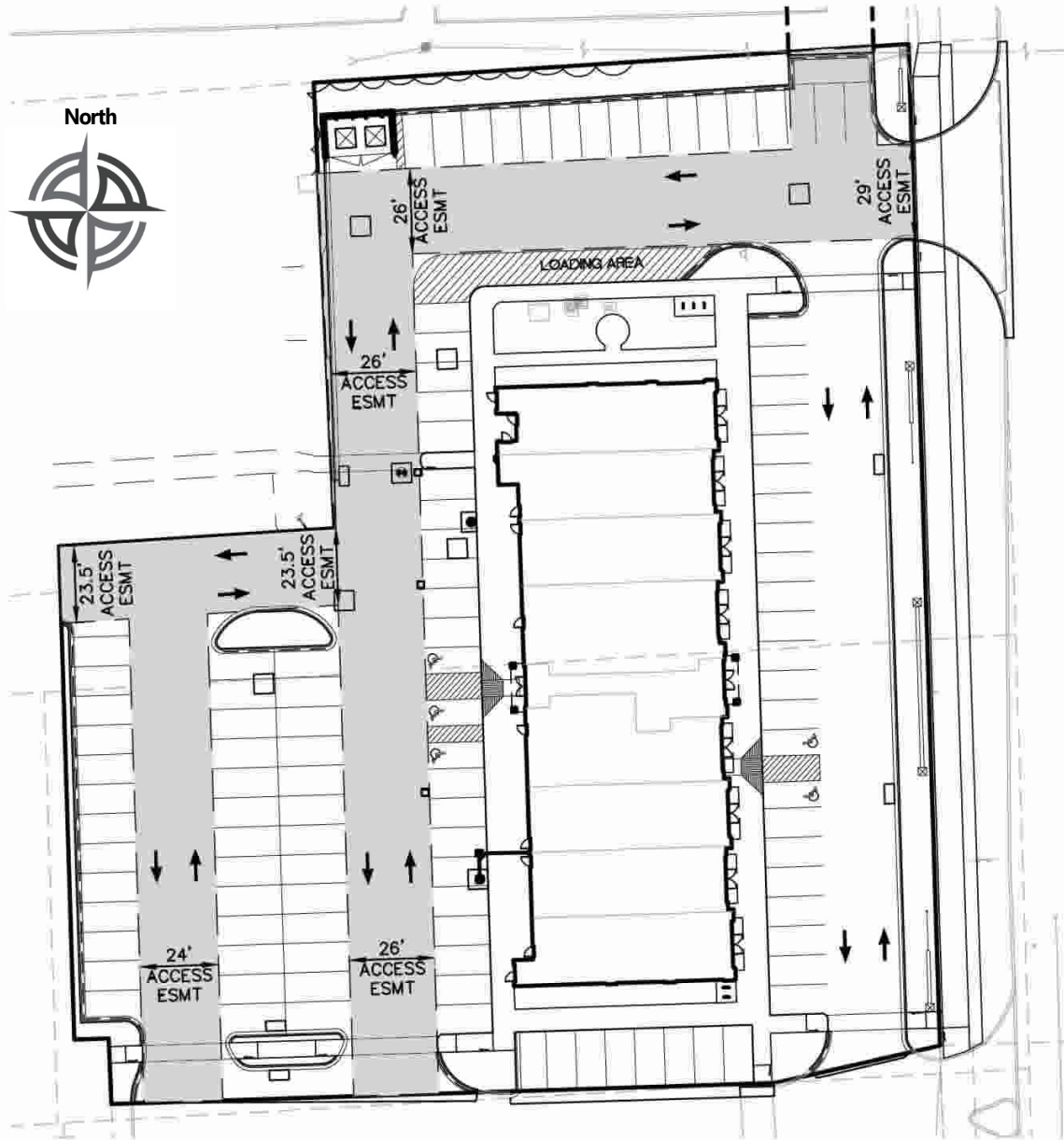

Matching the right people to the right place.

Offices in Sterling Heights and Port Huron to serve you
586.254.0900 • www.pilotpg.com

ADDITIONAL PHOTOS



Matching the right people to the right place.

Offices in Sterling Heights and Port Huron to serve you
586.254.0900 • www.pilotpg.com