



Creative Sublease in Fulton Market

400 N Morgan Street

7,000 SF Building + 10,500 SF Garden & Parking

Unique opportunity for a creative user

The space is steps away from Google HQ, WPP, Sterling Bay, and McDonald's Global HQ, nearby hotels include The Emily Hotel, Hoxton, Soho House, and Nobu.

Some of the best restaurant groups are also nearby such as Boka Restaurant Group, Dineamic Hospitality, Alinea Group, Hogsalt, 8 Hospitality, and Parlor Pizza

Space info

- 7,000 SF
- Large open space with 3 private offices/conferencing, kitchen, loading area & storage
- Single tenant opportunity in a one-story bow truss building
- 10,500 SF garden and parking
- 15' ceiling heights with multiple skylights
- Furniture is negotiable



Floor plan

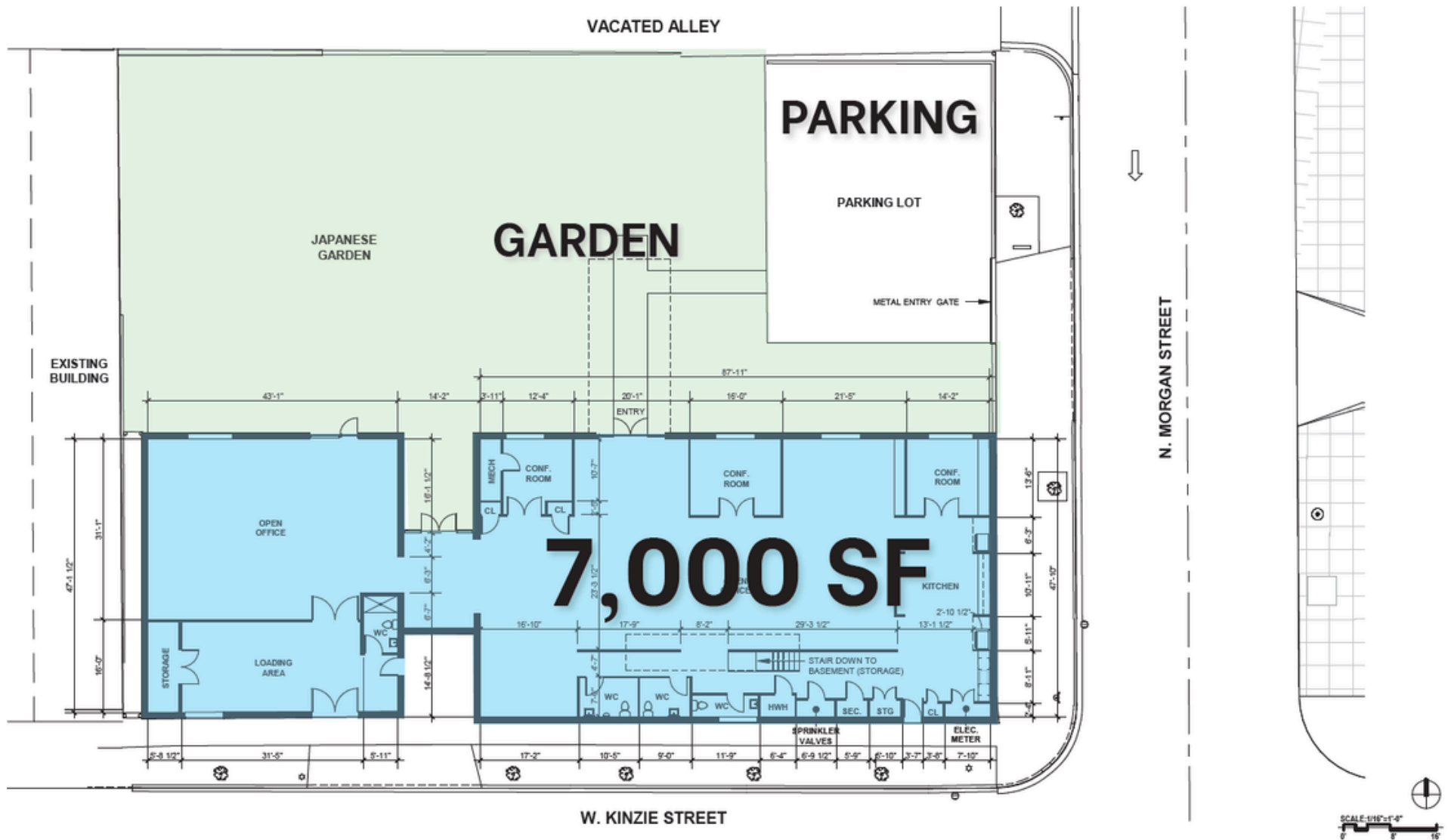

Space photos



Space photos



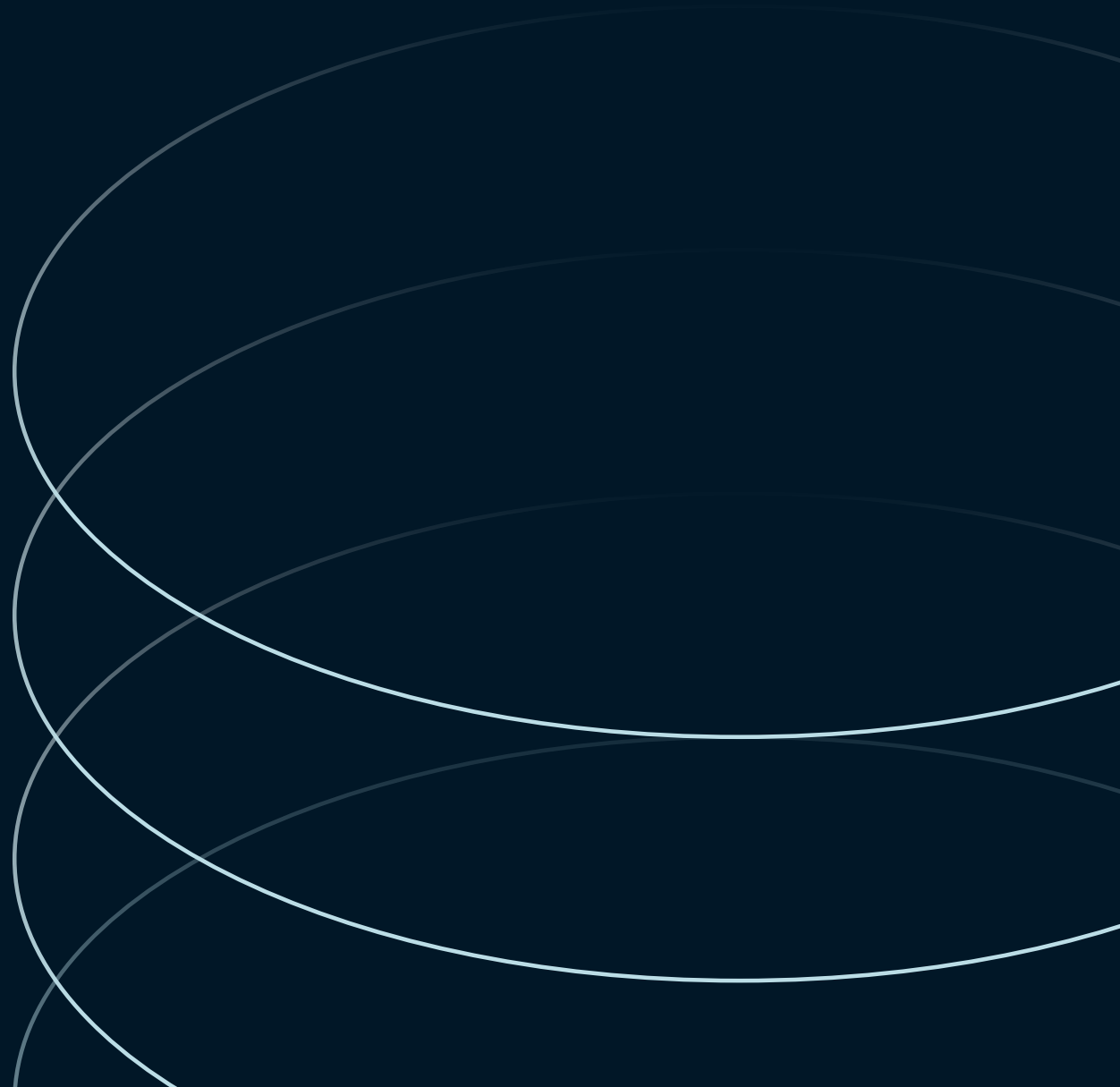

Sarah Silva

Vice President

Sarah.Silva@jll.com

+1 630 222 8241

Bess Cooney

Vice President

Bess.Cooney@jll.com

+1 773 612-4357

Nicole Becker

Associate

Nicole.Becker1@jll.com

+1 847 767 1254