

TURNER WARNELL ROAD

EXIST. C-STORE / GAS

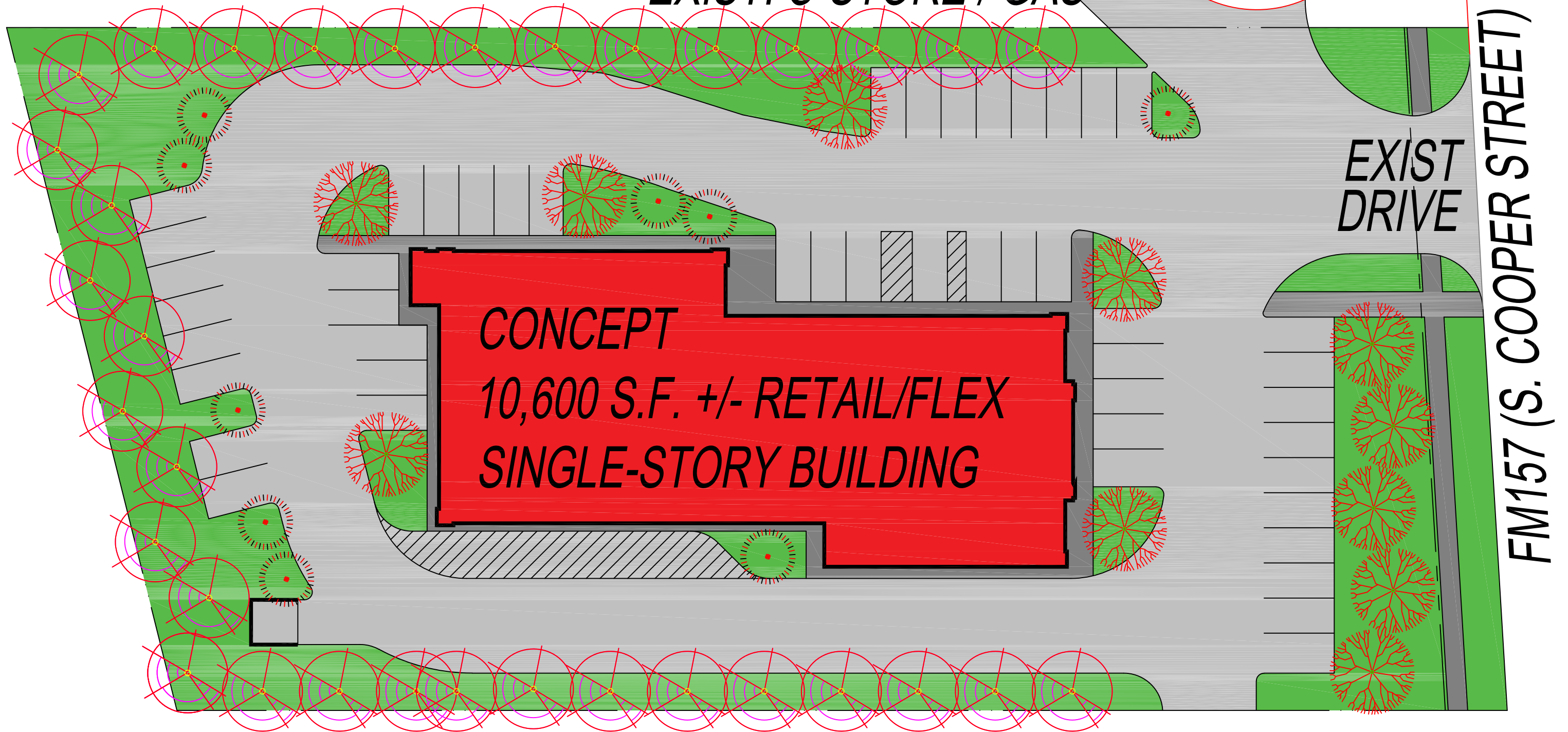

CONCEPT
10,600 S.F. +/- RETAIL/FLEX
SINGLE-STORY BUILDING

EXIST
DRIVE

FM157 (S. COOPER STREET)

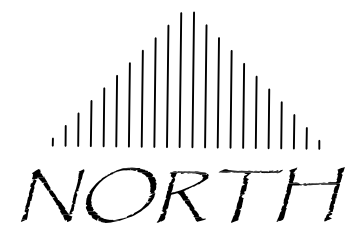

1.37 ACRES ~ ZONED "C-2"
982 TURNER WARNELL RD
MANSFIELD, TEXAS